

GURUGRAM

LAYOUT PLAN OF (8008)-THE UNNAMED COLONY-B34  
IN KHASRA NO-53/19/1MIN, 19/2MIN, 20/1/1,  
20/1/2, 21/2/1MIN, 22/1MIN.

REVENUE ESTATE OF HAYATPUR,  
TEHSIL HARSARU

FORMAT FOR CAPTURING INFORMATION  
REGARDING UNAUTHORISED COLONY

Sr. No.	Parameter Name	Description
1	Colony name	8008-UNNAMED COLONY B34
2	Area	4.203Acres
3	Location of the colony	HAYATPUR ROAD
	(i) Within MC	yes
	(ii) Outside MC	NO
4	Type of Colony and use (in %)	Residential 2%
		Public + Vacant 0%+85.49%
		Commercial + Road 1.5%+11.01%
5	Controlled Area	HAYATPUR
6	Urban Area	HAYATPUR
7	Year of establishment	2019
8	Layout Plan (at 1 cm : 10m)	To be Attached (Note: separate guidelines for layout attached for reference)
9	Total Plots	27
10	Constructed Plots ( Residential + Commercial + Public )	5 + 3 + 0 = 8
11	Number of vacant plots	19
12	Number of families residing in the colony	5
13	Does the colony have street light?	No
14	Does the colony have water supply through pipelines?	No
	Does the colony have underground sewerage facility?	No
15	If connected to any external Sewage treatment plant? (Y/N)	No
16	Does the colony have Park or Open space	No
17	Road type on Colony (kacha/pucca)	Kuccha
18	Width of different roads (in meters)	Road Width Length (in mtrs) 4.1 to 6.9 M 384.74 M
19	Minimum Road width	4.1 M
20	Electricity provided to households through which sub station	HARSARU
21	Does the colony have community site	No
22	Area of the community site(in acres)	000 000 000
23	Is the RWA registered	
24	Additional Information, if any	

PATWARI,  
MCM

Revenue Expert  
Patwari, MCM

DM,  
MCM

J.E,  
MCM

A.E  
MCM

A.T.P,  
MCM

District Town Planner (T&CP), Gurugram

(JE) (PA) (DTP)

Senior Town Planner, Circle Gurugram:

(JE) (PA) (ATP) (STP)

(vacant)  
D.T.P,  
MCM

JOINT.COMMISSIONER - I,  
MCM

JOINT.COMMISSIONER -II  
MCM

COMMISSIONER  
MCM

This layout plan of unauthorised colony is approved and notified by the Government vide notification no. 04/42/2023 - 2C1 dated 25<sup>th</sup> July, 2023. The same be scanned for uploading on the web portal.

PE Consultant/PE ATP

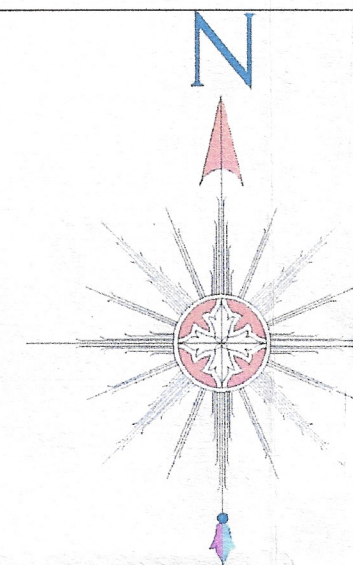

ALL THE DIMENSION AND AREA IN METER ONLY

LEGEND

Vacant Land	
Built Up Area/Residential	
Murraba Line	
Khasra Line	
Colony Boundary	
Kuccha Road	
Pucca Road	
Commercial Area	

KEY PLAN

Colony Bounday Provided by DULB

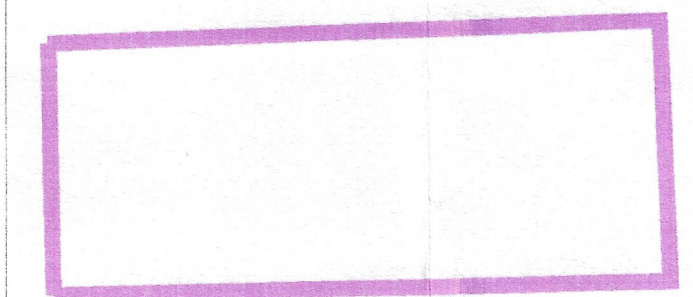

Proposed Colony Boundary

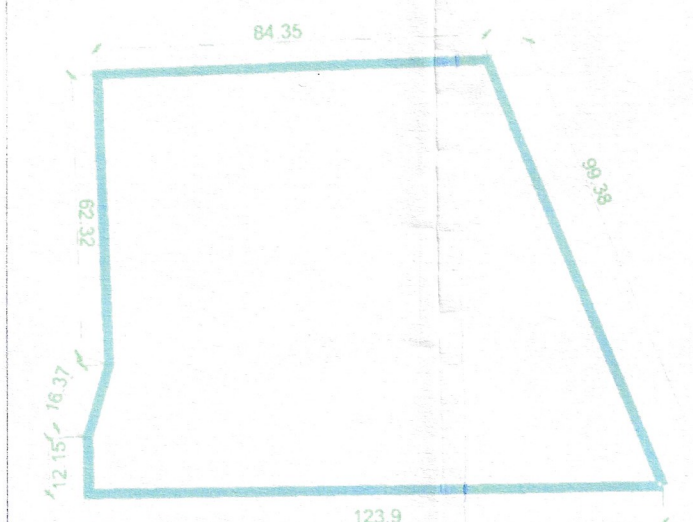

LEGEND

- Colony Bounday Provided by DULB/DTP
- Proposed Colony Boundary
- Area Under 24M Wide Proposed Road( As per Sectoral Plan)

KHASRA & AREA DETAILS

LAYOUT PLAN OF THE 8008- SAHEED BHAGAT SINGH COLONY - B34 IN KHASRA NO - 53/19/1MIN, 19/2MIN, 20/1/1, 20/1/2, 21/2/1MIN, 22/1MIN.

- Area as per Colony Layout provided by DULB/DTP = Approx (4.44 Acres)
- Area as per Proposed Layout Plan = Approx (2.31 Acres)

Client :

Sl.No	Date	Description of revision	Prints Issued
-------	------	-------------------------	---------------

Project :  
Drone survey unauthorized colony  
Haryana

SURVEY CONSULTANT >



IG Drones  
A unit of Inventgrid India Pvt. Ltd.  
2n Floor, E-53-54, Block E, Sector 3,  
Noida, Delhi NCR 201301

Checked :	Surveyor :	Scale :
Drawn By :	Sheet :	Sheet No :
Drawing No :	1 OF 1	Rev No :