

MUNICIPAL CORPORATION
GURUGRAM

LAYOUT PLAN OF THE 10679 -SURAT NAGAR PHASE-I
(EXTENSION-2 A 87)
IN KHASRA NO-0/283MIN,284MIN,287MIN & 288MIN

REVENUE ESTATE OF VILLAGE GURGAON DISTRICT,GURUGRAM

FORMAT FOR CAPTURING INFORMED INFORMATION
REGARDING UNAUTHORISED COLONY

Sr. No.	Parameter Name	Description
1	Colony name	SURAT NAGAR PHASE (EXTENSION-2)
2	Area	3.18 Acres(12882.92 Sq.m)
3	Location of the colony	NEAR RAILWAY STATION
(i)	Within MC	YES
	Outside MC	NO
4	Type of Colony and use (in %)	Residential 7386.28 Sq.m(57.4%) Public (School + Vacant) 1781.75 Sq.m(13.8%) Commercial + Road 3685.00 Sq.m(28.8%)
5	Controlled Area	GURUGRAM
6	Urban Area	GURUGRAM
7	Year of establishment	BEFORE 2000
8	Layout Plan (at 1 cm : 50m)	To be Attached (Note: separate guidelines for layout attached for reference)
9	Total Plots	136 Nos.
10	Constructed Plots (Residential + Commercial + Public)	123 Nos.
11	Number of vacant plots	13 Nos.
12	Number of families residing in the colony	250
13	Does the colony have street light?	YES
14	Does the colony have water supply through pipeline?	YES
15	Does the colony have underground sewerage facility?	YES
16	If connected to any external Sewage treatment plant? (Y/N) Does the colony have Park or Open space	NO
17	Road type on Colony (kacha/pucca)	BOTH
18	Width of different roads (in metres)	Road Width Length (in mtrs) 1) 0 to 3m NIL 2) 3m to 4m NIL 3) 4m to 5m NIL 4) 5m to above NIL
19	Minimum Road width	4.8M
20	Electricity provided to households through which sub station	NEW PALAM VIHAR,GURUGRAM
21	Does the colony have community site	No
22	Area of the community site(in acres)	000
23	Is the RWA registered	YES
24	Additional information, if any	The 90% area of said colony (40.70Acres) as already been approved by the Govt. vide notification no. 08/02/1993, 04/10/2013 & 06/12/2017. The rest of area of colony (3.18 Acres) submitted for regularization.

Note:
1. As per the report received from DTP (P.GEM Dated 16/06/2023, the colony falls in Residential Sector 104 Gurugram.

MUNICIPAL CORPORATION GURUGRAM

JE (FIELD) PATWARI (PLANNING OFFICIAL)
NT,MCG JE(P) HDM PA
ATP,MCG DTP(MCG) DTP(P),GGM
BRO,MCG STP(MCG) CTP(MCG)
COMMISSIONER,MCG DIV.COMMISSIONER,GGM

SURVEY OF UN-AUTHORISED COLONY -SURAT NAGAR PHASE-I(EXTENSION -2)



This layout plan of unauthorised colony is approved and notified by the Government vide notification no. 04/42/2023 - 2C1 dated 6th October, 2023. The same be scanned for uploading on the web portal.

Consultant/PE

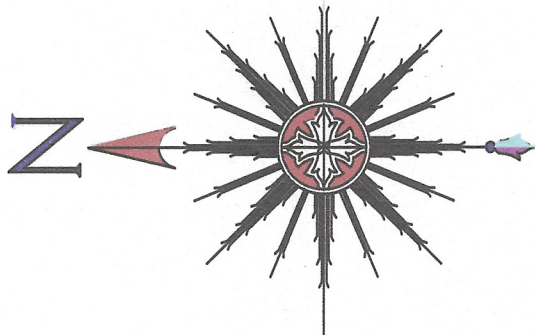

ALL THE DIMENSION AND AREA IN METER ONLY

LEGEND

Vacant Land	
Built Up Area/Residential	
Khasra Line	
Colony Boundary	
Kuchha Road	
Pucca Road	
Industrial Area	
Commercial Area	
AREA ALREADY APPROVED BY GOVT. VIDE NOTIFICATION DATED 08/02/1993 FOR RESIDENTIAL PURPOSE (AREA AROUND DAULTABAD ROAD UPTO SURAT NAGAR)	
AREA ALREADY APPROVED BY GOVT. VIDE NOTIFICATION DATED 04/10/2013 FOR RESIDENTIAL PURPOSE PART OF SURAT NAGAR-II	
AREA ALREADY NOTIFIED BY THE GOVT.VIDE NOTIFICATION DATED : 06/12/2017 FOR RESIDENTIAL PURPOSE (SURAT NAGAR-I EXTN.)	

KEY PLAN

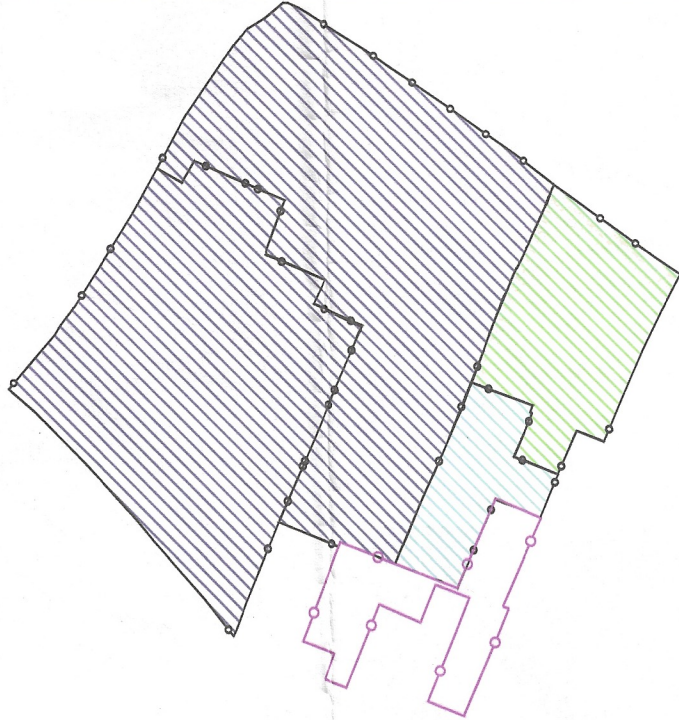

SIGNATURE OF RWAPLOT OWNERS COMMITTEE/ DEVELOPERS IS REPRESENTATIVE MEMBERS OF COLONY



ADDRESS:
PLOT NO. C1,INFOCITY-I,SEC-34,GURUGRAM