

UC-8

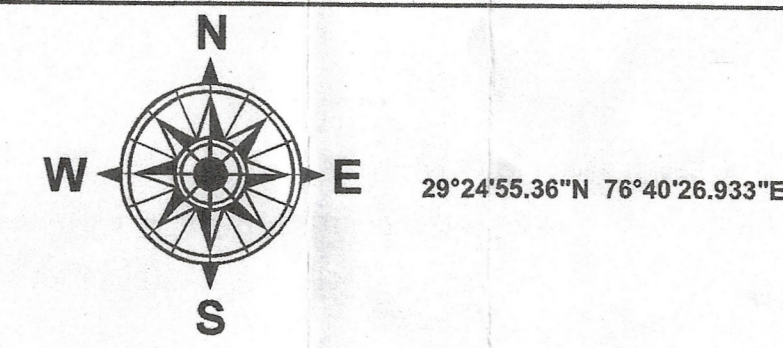

DISTRICT JIND

LAYOUT PLAN OF UNAUTHORISED COLONY
NEAR SHAMPUR ROAD
IN THE REVENUE ESTATE OF SAFIDON
TEH. SAFIDO AND DIST. JIND

KHASRA NO

23//19/2min, 18/2min, 26, 23, 22/2min
34//2/2min, 3min
0//447 min (3.29 Acres)

KEY PLAN

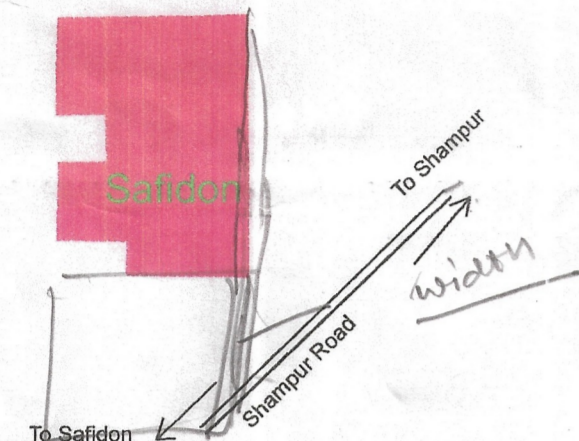

DETAILS OF UNAUTHORIZED COLONY

Sr. No.	Parameter Name	Description
1	Colony name	Safidon_UC 8
2	Area	3.29 Acres 13327.32 Sq/M
3	Location of the colony	Near Shampur Road
4	Municipal Limits Boundary (MC STATUS):	(i) Within MC Yes
		(ii) Outside MC No
		(iii) Partial MC No
5	Type of Colony and use (in %)	Area (%) Area(Acres) Area(Sq/M)
		Residential 20% 0.66 2651.18
		Vacant + Open 44% 1.45 5808.52
		Road 30% 0.99 4003.70
		Commercial 6% 0.19 783.92
6	Name of Revenue Estate	Safidon
	District Name	Jind
8	Name of Controlled Area	Safidon
9	Urban Area	Safidon
10	Year of establishment	2014
11	Total No. of Plots	60
12	No. of Constructed	26+10+0+36
13	Number of vacant plots	24
14	Number of families residing in the colony	26
15	Does the colony have street light?	No
16	Does the colony have Electric Line	Yes
17	Does the colony have HT Line	No
18	Does the colony have water supply through pipelines?	No
19	Does the colony have underground sewerage facility?	Yes
20	Does the colony have Park or Open space	No
21	Road type on Colony (Kuccha/Pucca)	Kuccha
22	Different roads (in meters)	Road Width Length (in meters)
		Pucca Road Kuccha Road 4.4 M to 6 M 852.67 M
23	Minimum Road Width	4.4 M
24	Area of the community site(in acres)	No
25	Is the RWA registered	No
26	Additional information, if any	No
27	Name of Electric Substation	DHBVN

FINAL AREA TO BE CONSIDERED FOR NOTIFICATION	
Area of colony surveyed (including khasra nos.)	23// 19/2 min, 18/2 min, 26, 23, 22/2 min, 34// 2/2min, 3min, 0//447 min (3.29 Acres)
Area not to be considered as per clause 5 i.e. Area of the colony falling under greenbelt/road/buffer zone/vacant land/industrial etc./commercial.	34//3min, 0//447 min (0.19 Acres)
(including khasra nos.) Area of colony falling outside MC with khasra nos.	Nil
Area of colony to be considered for notification	23// 19/2 min, 18/2 min, 26, 23, 22/2 min, 34// 2/2min, 3min, 0//447 min (3.10 Acres)

This layout plan of unauthorised colony is approved and notified by the Government vide notification no. 04/42/2023 - 2CI dated 6th October, 2023. The same be scanned for uploading on the web portal.

PE: *[Signature]* Consultant/PE
ATP: *[Signature]* ATP



LEGEND

- Airport
- Electric Pole
- Hospital
- Man Hole
- Mobile Tower
- Mosque
- School/College
- Solar Pole
- Street Light
- Temple
- Transformer
- HT Line
- LT Line
- Kuccha Road
- Pucca Road
- Major Road Line
- Drainage
- Sewerage Storm water
- Kuccha Road Polygon
- Pucca Road Polygon
- Residential
- Commercial
- Industrial
- Plot Boundary
- Vacant Land
- Park
- Colony Boundary
- Khasra Boundary
- Revenue Estate Boundary
- Mustil Boundary
- District Boundary
- APPROACH ROAD BOUNDARY

NOTE:-

- ALL DIMENSIONS ARE IN METERS AND AREA IN SQUARE METERS.
- AREA OF RESIDENTIAL BUILDINGS IS INDICATED THROUGH PINK COLOUR.
- AREA OF PLOT BOUNDARY IS INDICATED THROUGH PURPLE COLOUR.

DRG. NO D.T.P. (J) 1430/2022 DT. 05/05/2022

LAYOUT PLAN CHECKED AND VERIFIED AT SITE BY:

PATWARI : *[Signature]*
 JUNIOR ENGINEER : *[Signature]*
 JUNIOR DRAFTSMAN : *[Signature]*
 DISTRICT TOWN PLANNER : *[Signature]*
 SENIOR TOWN PLANNER :

OFFICE OF DISTRICT TOWN PLANNER, JIND
TOWN & COUNTRY PLANNING DEPTT, HARYANA

[Signature] M.C. Safidon
[Signature] M.C. Safidon
[Signature] M.C. Safidon
 Secretary
 Municipal Committee
 Safidon (Jind)

District Municipal Engineer
Jind

Sahanpur Road

SCALE : 1 CM = 10 M

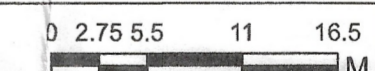

DRONE SURVEY AND LAYOUT PLAN PREPARED BY:-



CHECKED :	SURVEYOR :	SCALE :-
DRAWN BY :-		
DRAWING NO :- Safidon-UC-8	SHT. NO.	REV. NO.