

**MUNICIPAL CORPORATION  
GURUGRAM**

LAYOUT PLAN OF 888 LAXMAN VIHAR (POCKETS),  
IN KHASRA NO. CHUKED & UDAHILLI  
POCKET-A (2957sqm, 2962.2959min, 2958sqm)  
POCKET-B (2981.2982, 2983min, 2980min, 2984min, 2991 )  
POCKET-C (433)

K/VENUE ESTATE OF VILLAGE GURGAON  
TEHSIL GURGAON, DISTT. GURUGRAM

**FORMAT FOR CAPTURING INFORMATION  
REGARDING UNAUTHORISED COLONY**

Sr. No.	Parameter Name	Description
1	Colony Name	A BELAMAN VIHAR
2	Area	Pocket 'A': 6.53 Acres (18652 sq.m) Pocket 'B': 4.27 Acres (11777 sq.m) Pocket 'C': 1.45 Acres (3807 sq.m) TOTAL: 12.25 Acres (31236 sq.m)
3	Location of the colony	NEAR RAILWAY STATION, GURUGRAM
	(i) Within MC	YES
	(ii) Outside MC	NO
4	Type of Colony and use (in %)	Total % of All 3 nos. of pockets Residential: 65.19% (20290 Sq.m) Public/MSD + Vacant: 6.79% (21822 Sq.m) Commercial + Road: 28.02% (11224 Sq.m)
5	Controlled Area	GURUGRAM
6	Urban Area	GURUGRAM
7	Year of establishment	BEFORE 2005
8	Layout Plan (at 1 cm : 50m)	To be Attached
	(Note: separate guidelines for layout attached for reference)	
10	Total Plots	496
11	Constructed Plots ( Residential + Commercial + Public )	463 (Res.)+8(Comm.)=471
12	Number of vacant plots	25
13	Number of families residing in the colony	1100 APPROX.
14	Does the colony have water supply through pipelines?	YES
15	Does the colony have underground sewerage facility?	YES (PRIVATE)
16	If connected to any external Sewerage treatment plant? (Y/N)	NO
17	Does the colony have Park or Open space	NO
18	Road type on Colony (kacha/pucca)	PUCCA
19	Width of different roads (in meters)	Length (in mtrs) 1) 0 to 3m: NIL 2) 3m to 5m: 25m 3) 5m to 9m: 25m 4) 9m to above: NIL
20	Minimum Road width through which sub station	4.0M
21	Does the colony have community site	No
22	Area of the community site (in acres)	000
23	Is the RWA registered	YES
24	Additional information, if any	This Colony has already been regularized by the Govt. in the year of 1983 & 2016 for regularization.

Note:  
1) 8 Plots in commercial use= 147 Sq.m  
2) 105 Res. Area Under Reg. (in 2016-2017). She has been regularized by the Govt. in the year of 1983 & 2016 for regularization.

**MUNICIPAL CORPORATION GURUGRAM**

JE (FIELD) [Signature] PATWARI (PLANNING OFFICIAL) [Signature] PA [Signature]  
 NT, MCG [Signature] HDM [Signature]  
 ATP, MCG [Signature] DTP (MCG) [Signature] DTP (P), GGM [Signature]  
 DRO, MCG [Signature] STP (MCG) [Signature] CTP (MCG) [Signature]

COMMISSIONER, MCG [Signature] DIV. COMMISSIONER, GGM [Signature]

**SURVEY OF UN-AUTHORISED POCKETS IN COLONY LAXMAN VIHAR A-88**

GURUGRAM  
RAILWAY  
STATION

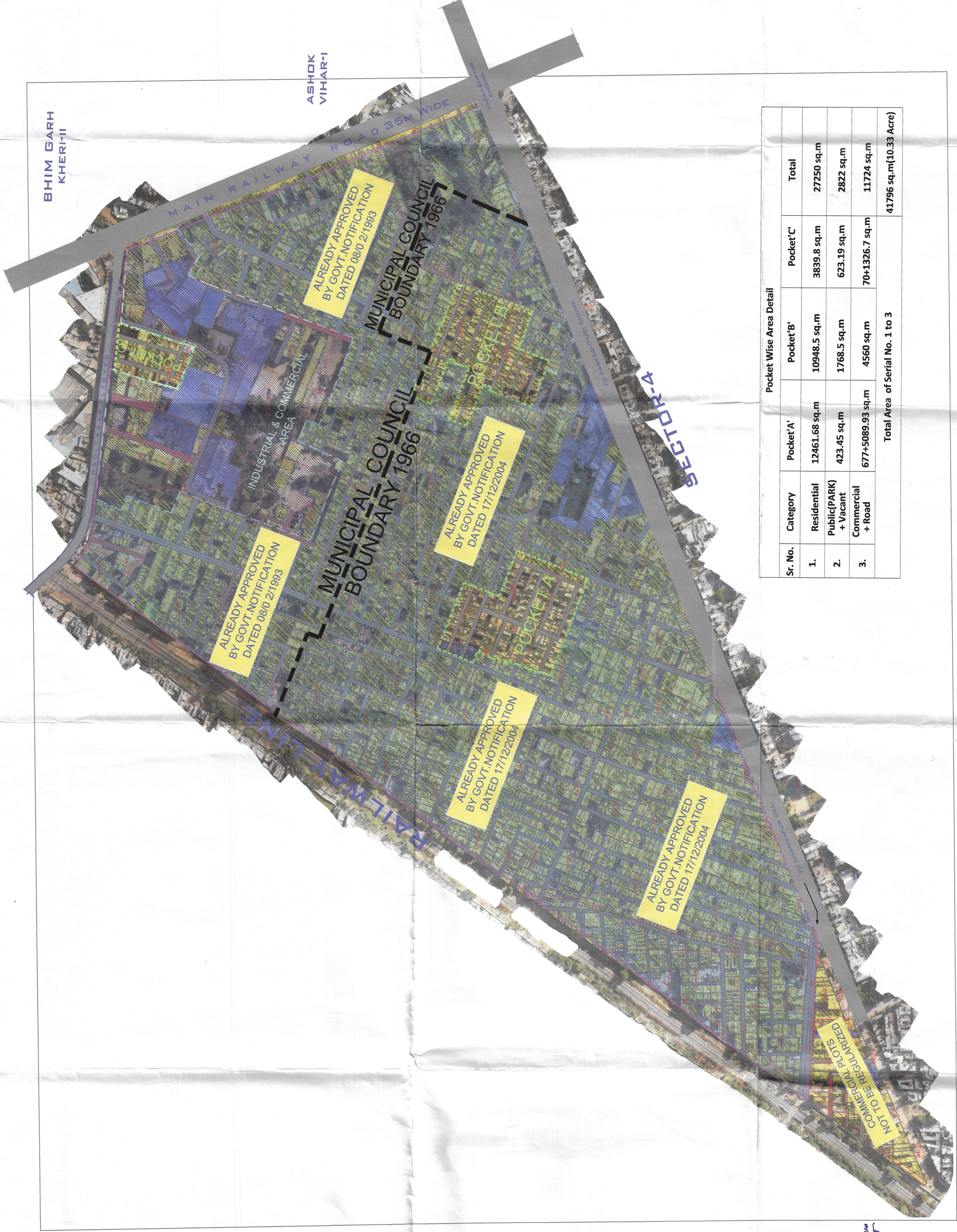

**Pocket Wise Area Detail**

Sr. No.	Category	Pocket 'A'	Pocket 'B'	Pocket 'C'	Total
1.	Residential	12461.68 sq.m	10948.5 sq.m	3839.8 sq.m	27250 sq.m
2.	Public(PARK) + Vacant	423.45 sq.m	1768.5 sq.m	623.19 sq.m	2822 sq.m
3.	Commercial + Road	677+5089.93 sq.m	4560 sq.m	70+1326.7 sq.m	11724 sq.m
<b>Total Area of Serial No. 1 to 3</b>					<b>41796 sq.m(10.33 Acre)</b>

This layout plan of unauthorised colony is approved and notified by the Corporation vide G.O. No. 044/2023 - 2021 dated 6<sup>th</sup> October, 2023. This same be scanned for uploading on the web portal.

[Signature] Consultant PE

SHEET No. 3

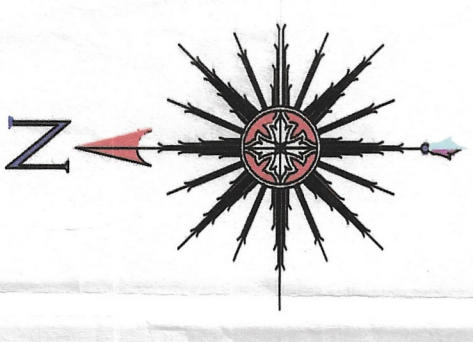

ALL THE DIMENSION AND AREA IN METER ONLY

**LEGEND**

Vacant Land	[Symbol]
Built Up Area/Residential	[Symbol]
Khasra Line	[Symbol]
Colony Boundary	[Symbol]
Colony Boundary FOR REGULARIZATION	[Symbol]
Kuccha Road	[Symbol]
Pucca Road	[Symbol]
Commercial Area	[Symbol]
ALREADY REGULARIZED BY THE GOVT. NOTIFICATION DATED 08/02/1993 & 17/12/2004	[Symbol]

**KEY PLAN**

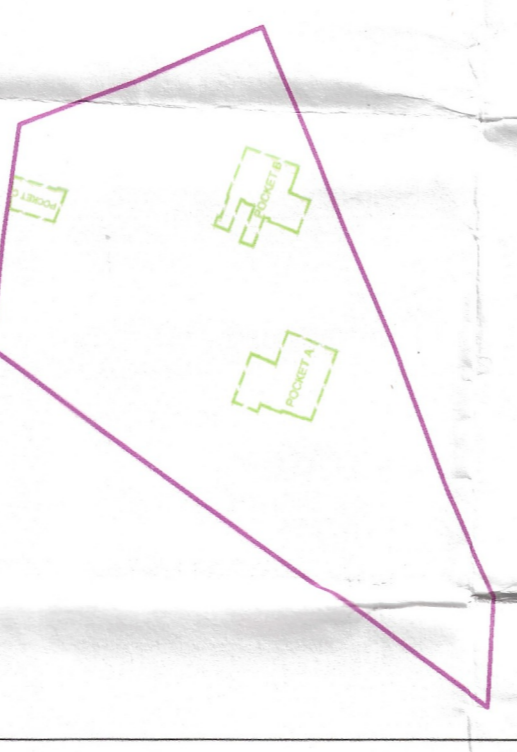

SIGNATURE OF RWAPLOT OWNERS COMMITTEE/ DEVELOPERS'S REPRESENTATIVE MEMBERS OF COLONY

- POCKET 'A'**
- [Signature] 9050378429
  - [Signature] 9050378429
  - [Signature] 8860985511

- POCKET 'B'**
- [Signature] 99719933
  - [Signature] 901079198

- POCKET 'C'**
- [Signature] RWA President 93397816
  - [Signature] RWA Secretary
  - [Signature] RWA Treasurer
  - [Signature] RWA Member

- POCKET 'D'**
- [Signature] RWA President
  - [Signature] RWA Vice President
  - [Signature] RWA Member
  - [Signature] RWA Member
  - [Signature] RWA Member



ADDRESS:  
PLOT NO. C1, INFOCTY-I, SEC-34, GURUGRAM