

DISTRICT PANIPAT

LAYOUT PLAN OF GEETA COLONY EXTANTION IN THE REVENUE ESTATE OF VILLAGE_TARAF MAKHDOOM JAGDAN TEHSIL PANIPAT DISTRICT PANIPAT COMPRISING IN KHASRA NO.

48/8min,9min,11min,12,13/1min,
18min,19min,20/1,21/1min,21/2min,21/3min,22min

KEY PLAN

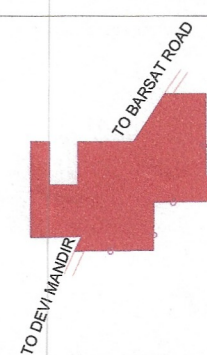

DETAILS OF UNAUTHORIZED COLONY

Sr. No.	Parameter Name	Description
1	Colony name	GEETA COLONY EXTANTION (ID: 9707)
2	Area	3.89 Acres
3	Location of the colony	NEAR ANGEL PUBLIC SCHOOL
(i)	Within MC	Yes
(ii)	Outside MC	No
4	Type of Colony and use (in %)	Residential 48.44% Vacant 35.83% Road 14.22% Commercial 1.54% Industrial 0.0%
5	Controlled Area	PANIPAT
6	Urban Area	PANIPAT
7	Year of establishment	2014
8	Layout Plan (Scale)	1:1000
9	Total Plots	129
10	Constructed Plots	51(R)+3(C) = 54
11	Number of vacant plots	65
12	Number of families residing in the colony	51
13	Does the colony have Electricity?	Yes
14	Does the colony have water supply through pipelines?	NO
15	Does the colony have underground sewerage facility?	No
15	If connected to any external Sewage treatment plant? (Y/N)	No
16	Does the colony have Park or Open space	No
17	Road type on Colony (kacha/pucca)	Maximum Road
18	Different roads (in meters)	Road Width Length (in mtrs)
	Pucca Road	
	Kachcha Road	
19	Minimum Road width	Minimum Road
20	Different roads (in meters)	Road Width Length (in mtrs)
	Pucca Road	
	Kachcha Road	
	Total road Length (in mtrs)	
21	Electricity provided to households through which sub-station	132 kv Substation City Panipat
22	Area of the community site(in acres)	No
23	Is the RWA registered	No
24	Additional Information, if any	

SCALE 1:1000

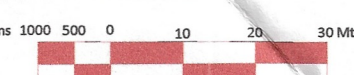

DRONE SURVEY AND LAYOUT PLAN PREPARED BY:- PD CONSULTING ENGINEERS PVT.LTD

PDCE GROUP
TRANSFORMING QUALITY & BUDGET
hello@pdcegroup.com www.pdcegroup.com
Red House, Behind MCD School,
Mehrauli-Gurgaon Rd, Ghitorni, Delhi - 30

Checked : PDCE Surveyor : Sudip Patra Sheet :- A1
Drawn By : ISLAM Sht. No. :- 1 OF 1 Rev. No. :- R0
NOTE:

DRG. NO. DTP/PNP/ 60 DATED : 22-03-2022

LAYOUT PLAN CHECKED AND VERIFIED AT SITE BY:-

PATWARI: KAPIL DEV
JUNIOR ENGG. MANJEET
ASSITANT DRAFTSMAN RAMPAL
JUNIOR DRAFTSMAN
SENIOR DRAFTSMAN
PLANNING ASSISTANT
ASSISTANT TOWN PLANNER
DISTRICT TOWN PLANNER ASHOK GARG
SENIOR TOWN PLANNER(R) DILBAG SINGH

OFFICE OF DISTRICT TOWN PLANNER, PANIPAT TOWN & COUNTRY PLANNING DEPTT., HARYANA

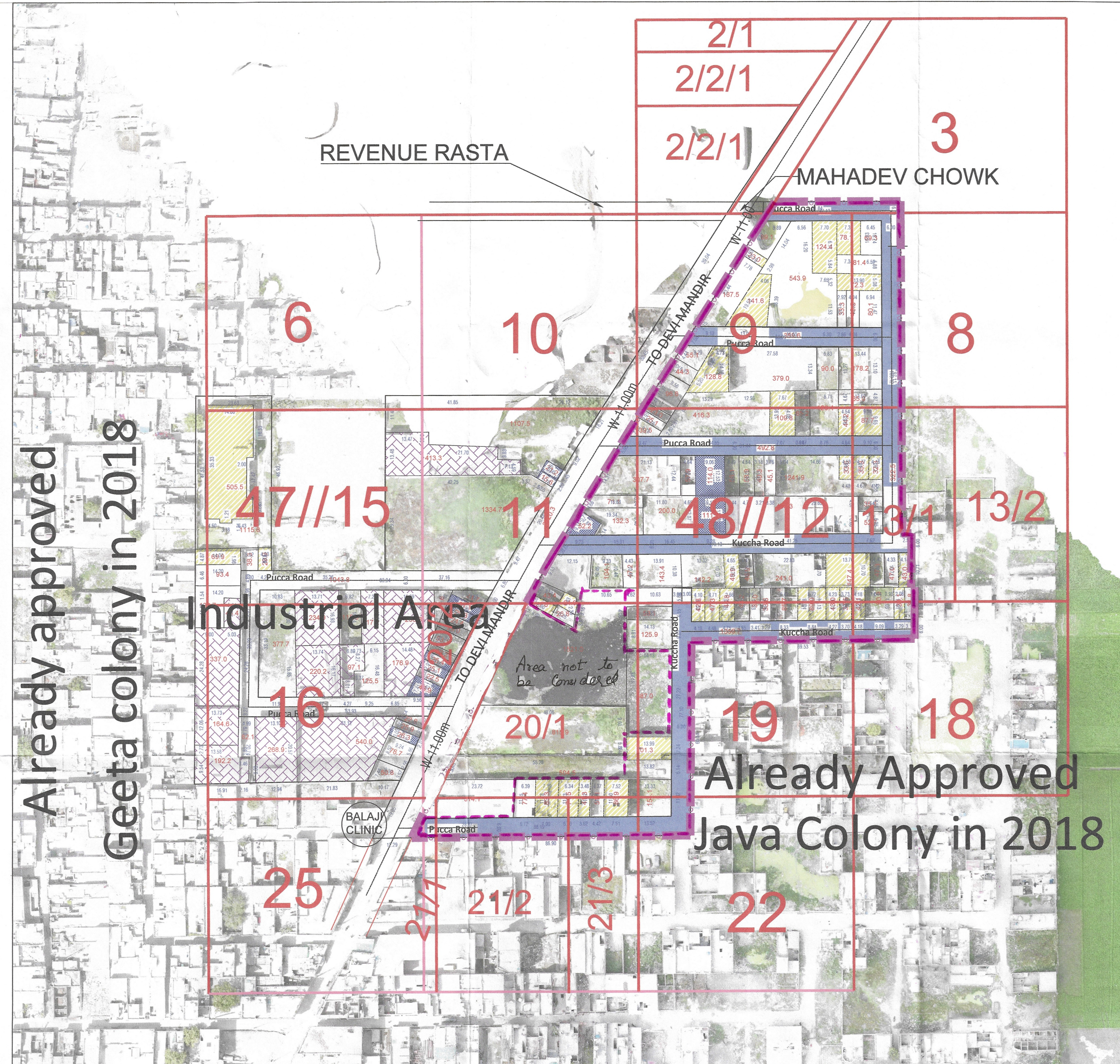

Already approved Geeta colony in 2018

Already Approved Java Colony in 2018

BI/JE
MC PANIPAT

ATP
MC PANIPAT

DTP
MC PANIPAT

COMMISSIONER
MC PANIPAT

DTP
(T&CP)PANIPAT

LEGEND

Symbol	LENGTH OF INTERNAL ROADS (RM)	Description
[Red outline]		VACANT AREA MORE THAN 4000 SQM (A)
[Blue rectangle]	623.44	ROAD 3-6 MTR
[Red rectangle]		AREA UNDER GOVERNMENT LAND (F)
[Purple dashed outline]	3.89A	Regularised Area
[Green rectangle]		Industrial Area (Not to be Regularised)
[Grey rectangle]	0.06A	Commercial Area (Not to be Regularised)
[Red line]		Khasra Line
[Green line]		Revenue Boundary
[Yellow rectangle]		Built Up Area/Residential
[White rectangle]		Vacant Land
[Blue rectangle]		Kuccha Road
[White rectangle]		Pucca Road
[Red line]		Murraba Line
[Double red line]		City Road

This layout plan of unauthorised colony is approved and notified by the Government vide notification no. 09/45/2024 - 4C - II dated 6th March, 2024. The same be scanned for uploading on the web portal.

Divisonal Commissioner
 Karnal Division, Karnal