

HISAR

LAYOUT PLAN OF ADRASH NAGAR, NEAR CANTT. HISAR (13497) IN KHASRA NO - 61//18min,19min,20min,21,22,23min 70//1,2,3min,8min,9,10min,11min,12min,13min

REVENUE ESTATE SATROD KALAN, TEHSIL & DISTRICT HISAR

FORMAT FOR CAPTURING INFORMATION REGARDING UNAUTHORISED COLONY

Sr. No.	Parameter Name	Description	
1	Colony name	Adrash Nagar, Near Cantt. Hisar (13497)	
2	Area	8.88 Acres	Considerable Area 8.24 Acres
3	Location of the colony	ALONG WITH HISAR-REWARI RAILWAY LINE	
	(i) Within MC	YES	
	(ii) Outside MC	NO	
4	Type of Colony and use (in %)	Residential	48.64%
		Industrial (not to be regularized)	0.00%
		Vacant	33.89%
		Commercial (not to be regularized)	0.00%
		Road	17.45%
5	Controlled Area	HISAR	
6	Urban Area	HISAR	
7	Year of establishment	2007	
8	Layout Plan (at 1 cm : 10m)	Attached	
		(Note: Separate Suidelines For Layout Attached For Reference)	
9	Total Plots	168	
10	Constructed Plots (Residential-Commercial-Industrial)	135+0+0	As per the original boundary of the Colony
11	Number of vacant plots	33	
12	Number of families residing in the colony	135	
13	Does the colony have street light?	Yes	
14	Does the colony have water supply through pipelines?	No	
15	Does the colony have underground sewerage facility?	No	
16	If connected to any external Sewerage treatment plant? (Y/N)	No	
17	Does the colony have Park or Open space	NO	
18	Road type on Colony (katcha/pucca)	Katcha Road	
19	Width of different roads (in meters)	Road Width	Length
20	Minimum Road width	4m	4886 m
21	Maximum Road width	7m	
22	Electricity provided to households through which sub station	DHVBH HISAR	
23	Does the colony have community site (In Acres)	NO	
24	Is the RWA registered	No	
25	Drainage	NO	
26	Revenue Rasta	NO	

Surveyed By: (PAT) (FI) (JE)

Drawing prepared and finalised By:

(AD) (JD/SD) (PA)

(ATP)

(DTP)

This layout plan of unauthorised colony is approved and notified by the Government vide notification no. 09/19/2024 - 4C - II dated 01st February, 2024. The same be scanned for uploading on the web portal.

Consultant/PE
ATP



Details as per the original boundary of the Colony

01	Total Area Of Colony	8.88acres/35936.0813sq. m
02	BUILTUP Area	4.32acres/17482.4179sq. m
03	Vacant plot / vacant land	3.01acres/12181.0366sq. m
04	Road Area	1.55acres/6272.6268sq. m

AREA DETAILS:-

AREA FALLS IN 30 M RESTRICTED BELT = 0.64 ACRES (KHASRA NO. 70//10MIN, 11MIN, 12MIN)

Layout Plan To Be Prepared At Scale 1:1000

Drone Survey Satellite Imagery In The Back ground.

Plots Area Marked In Sq Meters In The Plots.

REMAINING AREA OF THE COLONY TO BE CONSIDERED = 8.24 ACRES (61//18min, 19min, 20min, 21, 22, 23min, 70//1, 2, 3min, 8min, 9, 13min)

Assistant Engineer
Municipal Corporation
HISAR

Executive Engineer
Municipal Corporation
HISAR

Commissioner
Municipal Corporation
HISAR

COMMISSIONER
Hisar Division, HISAR



ALL THE DIMENSION AND AREA IN METER ONLY

LEGEND

MainHole/ Chamber	
TF/Electric/Mobile tower	
Street Light/Solar pole	
Revenue Estate Boundary	
City Road	
Killa Boundary	
Khasra Boundary	
Original Boundary of Colony	
HT Line	
Sewerage Line	
Water Supply Line	
Vacant Plot (Not to be Regularised)	
Industrial Area	
Commercial Area	
Residential Area	
Vacant Land	
Drainage	
Internal Katcha Road	
Internal Pucca Road	
Divider Road	
Temple/Mosque/Church/Flag Post	
Statue/School/Airport/Hospital/Well	
Tin Shed	
Restricted Belt	

KEY PLAN

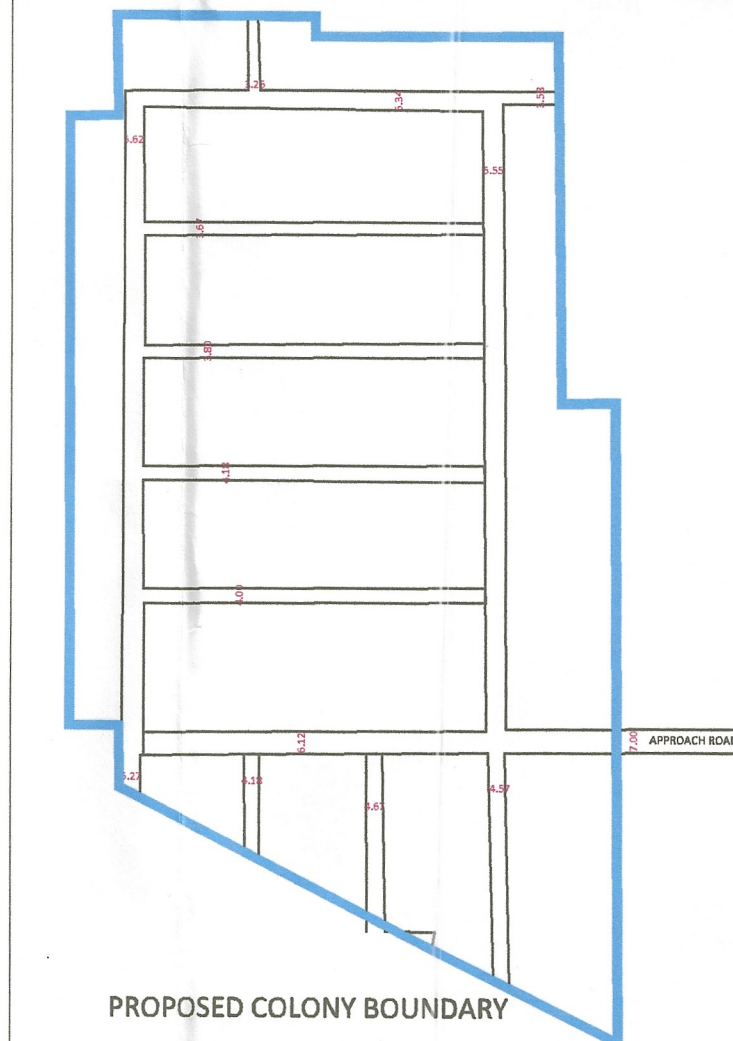

Note:

Revised considerable area in the Original Layout as per the discussion held at DULB, Chandigarh on 18.01.2023 and as per the directions received vide memo DULB/TP/2023/39-449 dated 13.01.2023 & e-mail dated 03.02.2023

Client:			
Project:	Drone survey		
Sl.No.	Date	Description of revision	Prints issued

SURVEY CONSULTANT:-		
BR Geotechnology balwinder@brgeotech.com		
Checked:	Surveyor:	Scale:-
Drawn By:		Sheet:-
Drawing No:		Sht. No. 1 OF 1
		Rev. No.