

# DISTRICT FARIDABAD

LAYOUT PLAN OF UNNAMED COLONY ID-4981 IN THE REVENUE ESTATE OF VILLAGE BADOLI, TEHSIL & DISTRICT- FARIDABAD COMPRISING IN KHASRA NO. 41/1min, 10, 11, 20min, 42/4min, 5min, 6min, 7min, 8min, 14min, 15min, 16min, 17min, 23min, 24min, 43min, 44min, 45/3min, 4 min.

## KEY PLAN

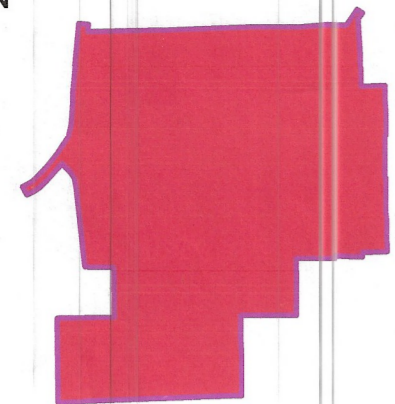

35/24/2min, Part of Acquired land by HSPV SECTOR-80 Resident

*Signature*  
PA

| DETAILS OF UNAUTHORIZED COLONY |  |                           |                  |
|--------------------------------|--|---------------------------|------------------|
| Sr. No.                        | Parameter Name   | Description               |                  |
| 1                              | Colony name  | UNNAMED COLONY (ID-4981)  |                  |
| 2                              | Area   | 8.02 Acres                |                  |
| 3                              | Location of the colony                                       |                           |                  |
| 4                              | (i) Within MC  | No                        |                  |
|                                | (ii) Outside MC  | Yes                       |                  |
| 4                              | Type of Colony and use (in %)                                | Residential<br>Industrial |                  |
|                                |  |                           |                  |
| 5                              | Controlled Area  |                           |                  |
| 6                              | Urban Area   |                           |                  |
| 7                              | Year of establishment  | 2016                      |                  |
| 8                              | Layout Plan (Scale)  | 1:3000                    |                  |
| 9                              | Total Plots  |                           |                  |
| 10                             | Constructed Plots(Residential-Industrial)                    | 4(R)+0(I)+0(C)=4          |                  |
| 11                             | Number of vacant plots                                       |                           |                  |
| 12                             | Number of families residing in the colony                    | 4                         |                  |
| 13                             | Does the colony have street light?                           | No                        |                  |
| 14                             | Does the colony have water supply through pipelines?         | No                        |                  |
|                                | Does the colony have underground sewerage facility?          | No                        |                  |
| 15                             | If connected to any external Sewage treatment plant? (Y/N)   | No                        |                  |
| 16                             | Does the colony have Park or Open space                      | NA                        |                  |
| 17                             | Road type on Colony (Kacha/pucca)                            | Kacha/Pucca               |                  |
| 18                             | Width of Different roads (in meters)                         | Road Width                | Length (in mtrs) |
|                                |  | 4.00M                     | 73.35M           |
|                                |  | 4.50M                     | 237.54M          |
|                                |  | 5.00M                     | 474.58M          |
|                                |  | 6.00M                     | 382.66M          |
|                                | 6.50M  | 328.56M                   |                  |
| 19                             | Minimum Road width   |                           |                  |
| 20                             | Electricity provided to households through which sub station | NA                        |                  |
| 21                             | Does the colony have community site                          | No                        |                  |
| 22                             | Area of the community site(in acres)                         | Nil                       |                  |
| 23                             | Is the RWA registered  | NA                        |                  |
| 24                             | Additional information, if any                               |                           |                  |

DTP GNP Faridabad

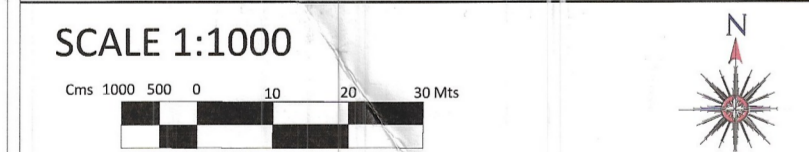

DRONE SURVEY AND LAYOUT PLAN PREPARED BY:- PD CONSULTING ENGINEERS PVT.LTD

**PDCE GROUP**  
 hello@pdcegroup.com  
 www.pdcegroup.com  
 Red House, Behind MCD School, Mehrauli-Gurgaon Rd, Ghitorni, Delhi - 30

|                 |                     |           |
|-----------------|---------------------|-----------|
| Checked: PDCE   | Surveyor: RISHI PAL | Sheet: A1 |
| Drawn By: ISLAM | Shit. No. :- 1 OF 1 | ID-3231   |

NOTE: ALL DIMENSIONS ARE IN METERS AND AREA IN ACRES.

DRG. NO. DTP(E)-FBD/2022/ DATED LAYOUT PLAN CHECKED AND VERIFIED AT SITE BY:- PATWARI

JUNIOR ENGG. *Signature*  
 ASSISTANT TOWN PLANNER *Signature*  
 DISTRICT TOWN PLANNER *Signature*  
 SENIOR TOWN PLANNER  
 OFFICE-DISTRICT TOWN PLANNER(ENF), FARIDABAD TOWN & COUNTRY PLANNING DEPTT., HARYANA



Revenue Estate of village Badoli  
 Khasra no. 35/24/2 min, 41/1min, 10, 11, 20min, 42/4min, 5min, 6min, 7min, 8min, 14min, 15min, 16min, 17min, 23min, 24min, 43min, 44min, 45/3min, 4 min.  
 NOTE 35/24/2 min is acquired by HSPV.

S.No. 39

| LEGEND                   |  | Murraba Line      |  | Commercial Area           |  | Industrial Area                     |  |
|--------------------------|--|-------------------|--|---------------------------|--|-------------------------------------|--|
| Manhole/ Chamber         |  | Khasra Line       |  | Built Up Area/Residential |  | Vacant Plot (Not to be Regularised) |  |
| TF/Electric/Mobile tower |  | Colony Boundary   |  | Vacant Land/Plot          |  |                                     |  |
| Street Light/Solar pole  |  | HT Line           |  | Drain/Culvert / Bridge    |  |                                     |  |
| Revenue Boundary         |  | Sewerage Line     |  | Kaccha Road               |  | Public & Semipublic Area            |  |
| City Road                |  | Water Supply Line |  | Pacca Road                |  |                                     |  |

This layout plan of unauthorised colony is approved and notified by the Government vide notification no. 04/42/2023 - 2CI dated 25<sup>th</sup> July, 2023. The same be scanned for uploading on the web portal.

*Signature* Patwari  
*Signature* Kanungo  
*Signature* DM  
*Signature* CTP  
*Signature* JE  
*Signature* CMC  
*Signature* Tehsildar  
*Signature* DTP  
*Signature* Div. CMC