

KURUKSHETRA

LAYOUT PLAN OF THE VED VIHARAJAN COLONY IN KHASRA NO. - 82/21 Min, 82/22 Min, 83/16 Min, 83/23 Min, 83/24 Min, 83/25 Min, 90/3 Min, 90/4, 90/5, 90/6, 90/7 Min, 90/8 Min, 90/12 Min, 90/13 Min, 90/14 Min, 90/15 Min, 90/16 Min, 90/17 Min, 90/18 Min, 90/19 Min, 90/20 Min, 90/22 Min, 90/23 Min, 90/24 Min, 91/1, 91/2 Min, 91/9 Min, 91/10 Min, 91/11 Min, 91/12 Min, 91/13 Min, 91/19 Min, 91/21 Min, 91/22 Min, 91/23 Min, 91/27, 104/1, 104/2, 104/3 Min, 104/8 Min, 104/9 Min, 104/10 Min, 105/5 Min, 105/6 Min

PATTI JHAMBRA, TEHSIL SHAHABAD

FORMAT FOR CAPTURING INFORMATION REGARDING UNAUTHORISED COLONY

Sr. No.	Parameter Name	Description	
1	Colony Name	Ved Vihar/Rajan Colony	
2	Area	25.67 acre	
3	Location of the colony (i) Within MC (ii) Outside MC	GT Road Yes	
4	Type of Colony and use (in %)	Residential	21.64%
		Industrial	0.46%
		Commercial	1.27%
		Vacant	58.45%
5	Road	18.19%	
6	Controlled Area	Shahabad	
7	Urban Area	Shahabad	
8	Year of establishment (at 1 cm: 6m)	2016	
9	Layout Plan (at 1 cm: 6m)	Attached	
10	Total Plots	259	
11	Constructed Plots (Residential + Industries)	80+2+1	
12	Number of vacant plots residing in the colony	176	
13	Number of families in the colony	80	
14	Does the colony have street light?	Partial	
15	Does the colony have water supply through pipelines?	Yes	
16	Does the colony have underground sewerage facility?	Yes	
17	If connected to any external Sewage treatment plant? (Y/N)	No	
18	Does the colony have Park or Open space (kachal/pucca)	No	
19	Road type on Colony (width of different roads in meters)	Kucha & Pucca Length (in mtrs) 3018	
20	Minimum Road Width	2 M	
21	Approach Road Width	8 M	
22	Electricity provided to households through which sub station	Shahabad	
23	Does the colony have community site	No	
24	Area of the community site (in Acres)	Nil	
25	Is the RWA registered	No	
26	Additional Information, if any		

Checked By: *[Signature]* J.D.

Drawing No.- (KKR)/SHAHABAD-13/2022

Checked By:

JE

(Pat.) (JD) (ATP) (DTP) (STP)



Note: Industrial Unit/Commercial Building not included as per UB notification dated 03.03.2023.

This map of unauthorised colony is approved and notified by the Government vide notification no. 09/192024-4C-II dated 09th February, 2024. The same is scanned for uploading on the portal.

[Signature]
Commissioner P.T.

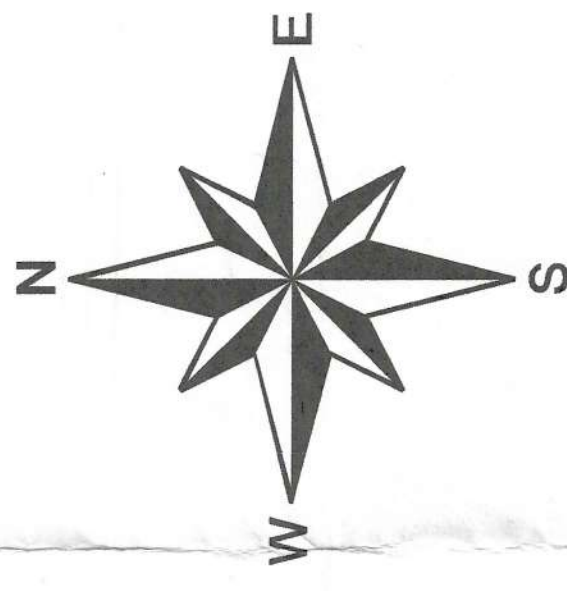

ALL THE DIMENSIONS AND AREA IN METER ONLY

LEGEND

- (a) Manhole/ Chamber
- (b) TF/Electric/Mobile Tower
- (c) Street Light/Solar Pole
- (d) School/Hospital/Airport
- (e) Approach Road
- (f) Revenue Boundary
- (g) HT Line
- (h) Sewerage Line
- (i) Water Supply Line
- (j) Temple/Mosque/Church
- (k) Public & Semi Public Area
- (l) Murabba Line
- (m) Khasra Line
- (n) Kuccha Road
- (o) Pucca Road
- (p) Colony Boundary
- (q) Built Up Area / Residential
- (r) Commercial Area
- (s) Industrial Area
- (t) Vacant Land
- (u) Drain/Culvert/Bridge
- (v) Green Belt
- (w) Road Width

KEY PLAN

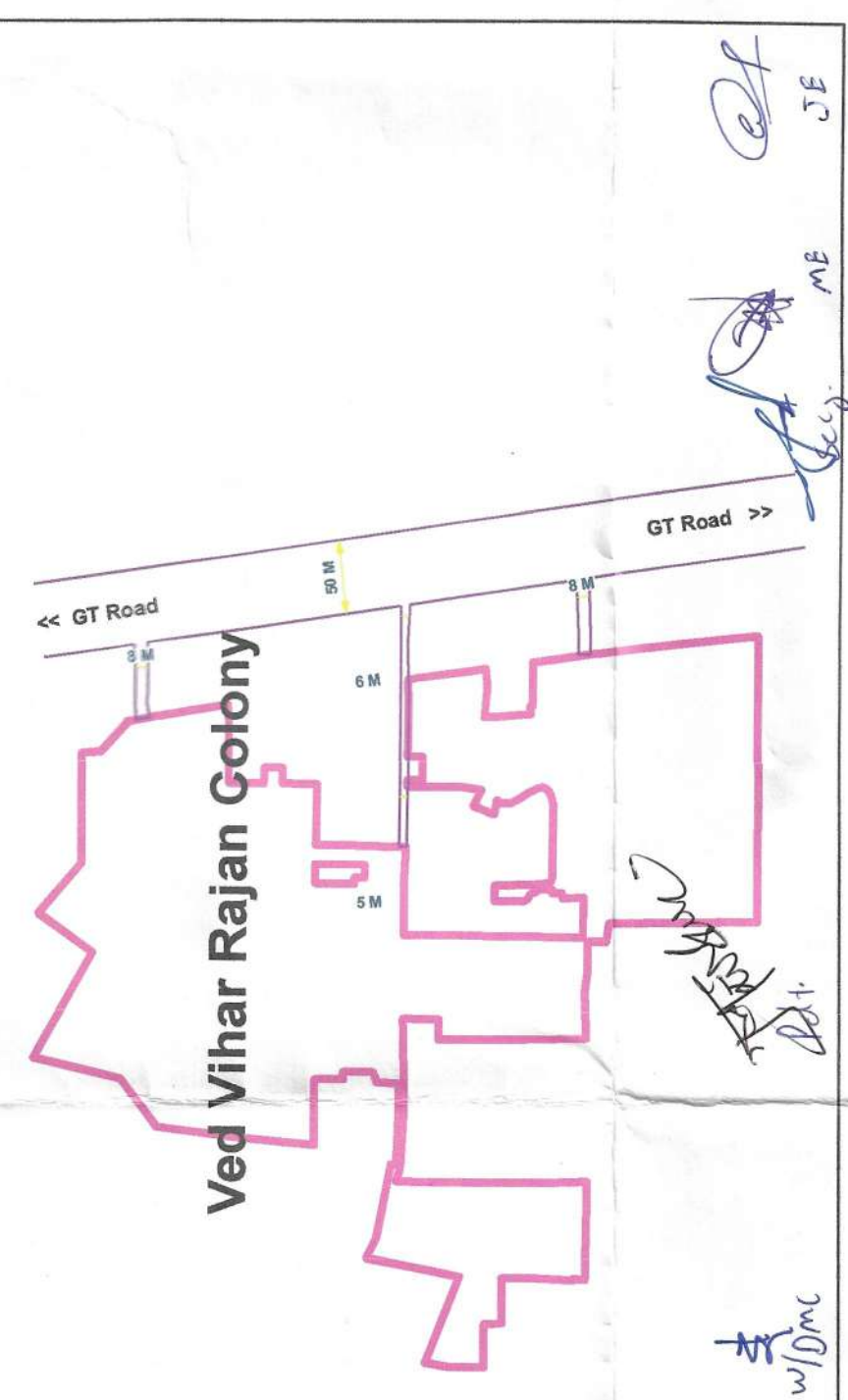

SL No	Date	Description of Revision	Prints Issued
		Municipal Committee Shahabad Unauthorized Colony Survey	

Survey Consultant: **MACHI**
MachOne Advisors LLP
M: +91 9318361558, 7506068923

Scale: 1:1000
Checked: _____
Size: _____
Sheet No.: _____
Drawn By: _____