

**YAMUNA NAGAR**

**REVISED LAYOUT PLAN OF KESAR NAGAR (115) IN KHASRA NO.**

29//26/1 min, 26/2 of Village Telipura & 15//13 min, 15 min, 16, 17 min, 25, 16//8 min, 9 min, 10 min, 11 min, 12, 13 min, 18 min, 19 min, 20, 21, 22 min, 23//1 of Village Udhamgarh & 17//28, 18//28, 29 min, 6//18 min, 19 min, 22 min, 23, 24, 25, 17//16 min, 25, 18//1 min, 2 min, 3, 4, 5, 6, 7, 8, 9 min, 10 min, 11, 12 min, 13 min, 14, 15, 17, 18, 19, 20, 21, 22, 19//1, 10, 24//1, 2/1, 2/2, 10 min, 25//4, 5

OF VILLAGE JAGADHRI,  
TEHSIL JAGADHRI

*Checked my verified*

This layout plan of unauthorised colony is approved and notified by the Government vide notification no. 09/62/2023 - 4CII dated 17<sup>th</sup> August, 2023. The same be scanned for uploading on the web portal.

*ATP*  
Consultant/PE

**Revised Colony Boundary to be considered for Notification-**

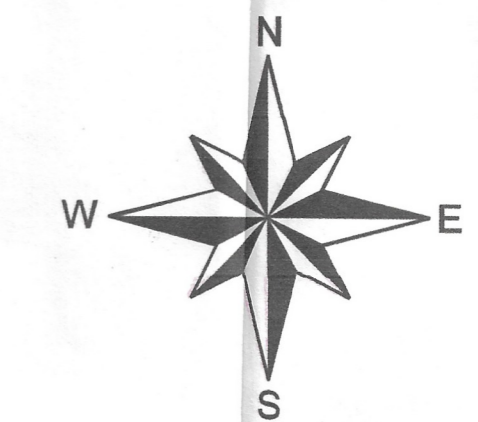

ALL THE DIMENSIONS AND AREA IN METER ONLY



**LEGEND**

- (a) Manhole/ Chamber
- (b) TF/Electric/Mobile Tower
- (c) Street Light/Solar Pole
- (d) School/Hospital/Airport
- (e) City Road
- (f) Revenue Boundary
- (g) HT Line
- (h) Sewerage Line
- (i) Water Supply Line
- (j) Temple/Mosque/Church
- (k) Public & Semi Public Area
- (l) Murabba Line
- (m) Khasra Line
- (n) Kuccha Road
- (o) Pucca Road
- (p) Colony Boundary
- (q) Built Up Area / Residential
- (r) Commercial Area
- (s) Industrial Area
- (t) Vacant Land
- (u) Drain/Culvert/Bridge

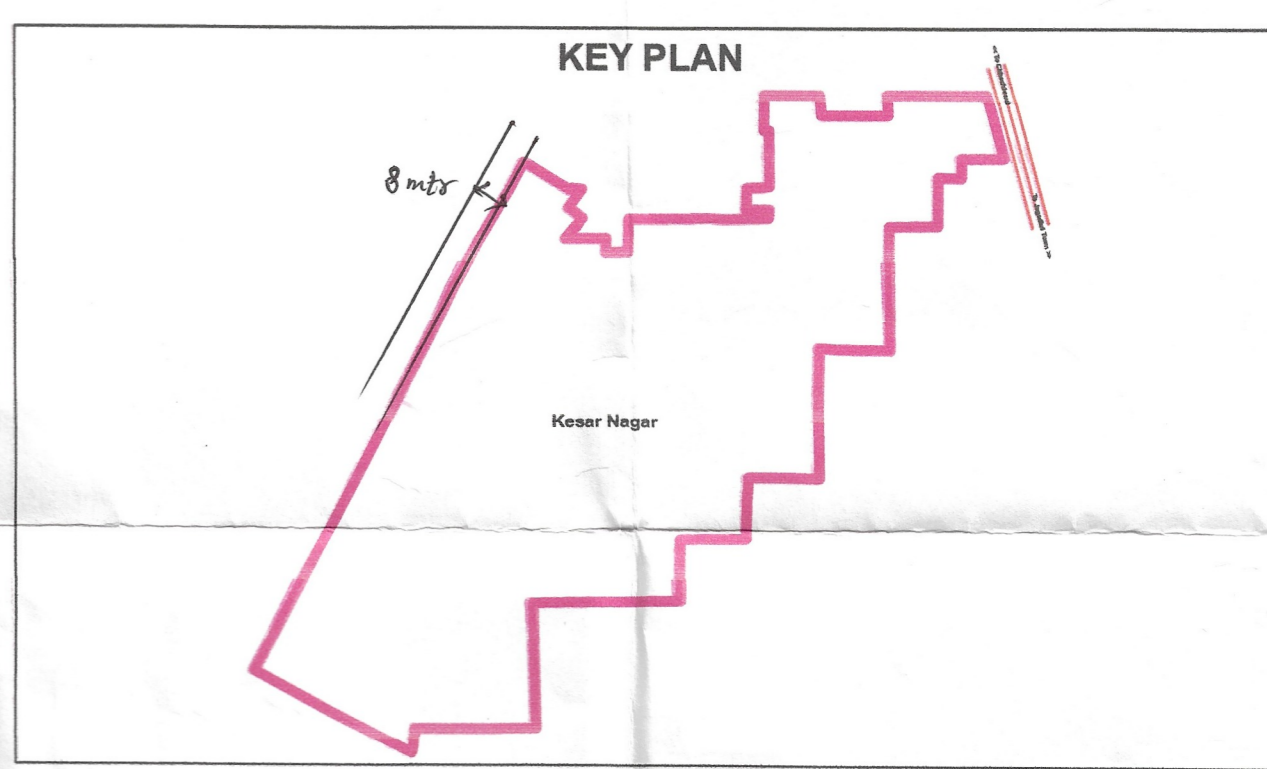

Sr. No.	Parameter Name	Description
1	Colony Name	Kesar Nagar
2	Total area surveyed in the colony	48.35 acre
3	a) Area not to be considered (0//26/1min of village Telipura, 16//7, 16//8min, 16//13min, 16//19min of village Udhamgarh, 0//228min, 6//22min, 18//1min, 18//2min, 17//26, 17//27, 17//28 min, 18//10min, 18//9min, 18//12min, 18//13min, 17//16min of village Jagadhri)	5.67 acres
4	Area to be considered for notification of colony 29//26/1 Min, 29//26/2 OF VILLAGE TELIPURA, 15//13 Min, 15//15 Min, 15//16, 15//17 Min, 15//25, 16//8min, 16//9 Min, 16//10 Min, 16//11 Min, 16//12, 16//13 Min, 16//18 Min, 16//19 Min, 16//20, 16//21, 16//22 Min, 23//1 OF VILLAGE UDHAMGARH AND 17//28 Min, 18//28, 18//29 Min, 6//18 Min, 6//19 Min, 6//22min, 6//23, 6//24, 6//25, 17//16min, 17//25, 18//1, 18//2, 18//3, 18//4, 18//5, 18//6, 18//7, 18//8, 18//9min, 18//10min, 18//11, 18//12min, 18//13min, 18//14, 18//15, 18//17, 18//18, 18//19, 18//20, 18//21, 18//22, 19//1, 19//10, 24//1, 24//2/1, 24//2/2, 24//10 Min, 25//4, 25//5 OF VILLAGE JAGADHRI)	42.42 acres
5	Controlled Area	Yes (YNR/JAG)
6	Urban Area	Yes (YNR/JAG)
7	Year of establishment	2007
8	Layout Plan (at 1 cm : 10m)	Attached
9	Total Plots	
10	Constructed Plots ( Residential+Commercial+Industry+Public)	
11	Number of vacant plots	
12	Number of families residing in the colony	
13	Does the colony have street light?	No
14	Does the colony have water supply through pipelines?	Partial
15	Does the colony have underground sewerage facility?	Partial
16	If connected to any external Sewage treatment plant? (Y/N)	No
17	Does the colony have Park or Open space	No
18	Road type on Colony (kacha/pucca)	Kacha/Pucca
19	Width of different roads (in meters)	Road Width 3.5 to 15 M Length (in mtrs) 5888
20	Minimum Road Width	3.5
21	Electricity provided to households through which sub station	YNR/JAG SUB DIV - 1
22	Does the colony have community site	No
23	Area of the community site (in Acres)	NIL
24	Is the RWA registered	No
25	Additional Information, if any	

26 Approach road width - 8 mtr.

Drawing No. YNR/JAG-55/2022

O/O District Town Planner- Yamuna Nagar  
Patwari J.E ATP DTP

O/O Municipal Corporation- Yamuna Nagar  
B.I Patwari ATP DTP 3/5/23

Municipal Commissioner

Additional Municipal Commissioner  
Yamuna Nagar-Jagadhri

Commissioner  
Ambala Division

SI No.	Date	Description of Revision	Prints Issued
Project: Drone Survey unauthorized Colony Haryana			
Survey Consultant:- Ace Architects, 155B, First Floor Sec 82 Mohali			
Scale:- 1:800			
Checked:	0 100 200 400 600 800 Meters		
Drawn By:	Surveyor:		
			Sht No. 1 of 1