

AMBALA CANTT

LAYOUT PLAN OF NIRMAL COLONY
IN KHASRA NO - 21/1/15MIN-1-22/1/12-12-13-13/1MIN-13/2MIN-18/1-18/2MIN-19/1-19/2-20/1-21/1

REV ESTATE BABIAL, TEHSIL AMBALA CANTT

FORMAT FOR CAPTURING INFORMATION REGARDING UNAUTHORISED COLONY

| Sr. No. | Parameter Name | Description |
|---------|--|---|
| 1 | Colony name | NIRMAL COLONY |
| 2 | Area | 3.89 Acres |
| 3 | Location of the colony | NEAR PARMAR FLOOR MILL |
| | (i) Within MC | YES |
| | (ii) Outside MC | NO |
| 4 | Type of Colony and use (in %) | Residential 39.76% Public + Vacant 0% + 43.26% Commercial + Road 0% +16.98% |
| 5 | Controlled Area | AMBALA CANTT |
| 6 | Urban Area | AMBALA CANTT |
| 7 | Year of establishment | 2017 |
| 8 | Layout Plan (at 1 cm : .15m) | |
| 9 | Total Plots | 109 |
| 10 | Constructed Plots (Residential + Commercial + Public) | 79 + 0 + 0 = 79 |
| 11 | Number of vacant plots | 39 |
| 12 | Number of families residing in the colony | 70 |
| 13 | Does the colony have street light? | No |
| 14 | Does the colony have water supply through pipelines? | YES |
| 15 | Does the colony have underground sewerage facility? | No |
| 16 | If connected to any external Sewage treatment plant? (Y/N) | No |
| 17 | Does the colony have Park or Open space | No |
| 18 | Road type on Colony (Kacha/pucca) | PUCCA |
| 19 | Width of different roads (in meters) | Road Width Length (in mtrs) 2.8 M to 6.7 M 542.5391 M |
| 20 | Minimum Road width | 2.8 M |
| 21 | Electricity provided to households through which sub station | BABIAL |
| 22 | Does the colony have community site | No |
| 23 | Area of the community site (in acres) | 000 000 000 |
| 24 | Is the RWA registered | No |
| 25 | Additional Information, if any | |

DRAWING NO: (AMB)/AMBALA CANTT-103/2022

Surveyed by: IG DRONES

Drawing checked by:

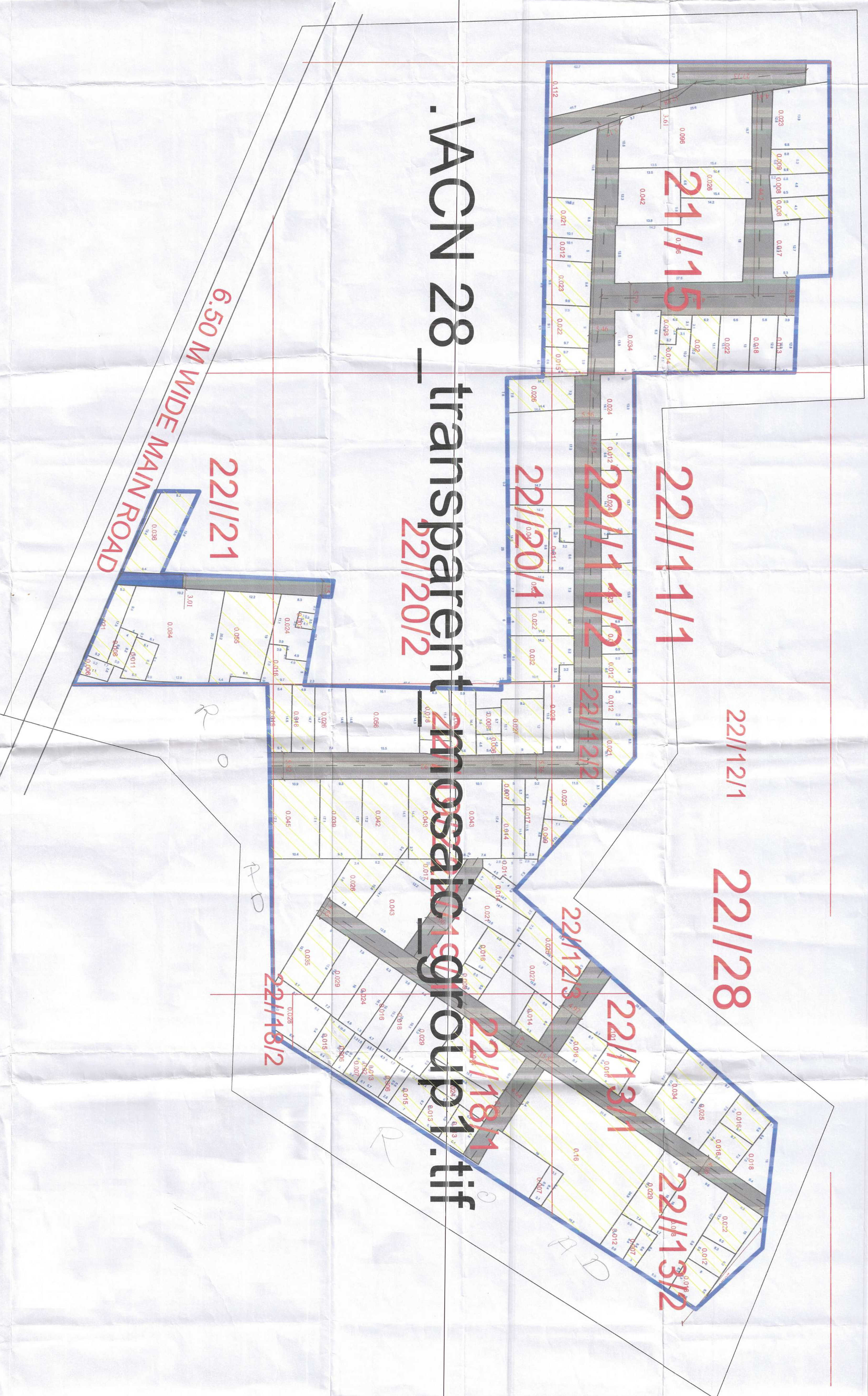

IACN 28 transparent mosaic group 1.tif

ALL THE DIMENSION ARE IN METER
AREA ARE IN ACRES

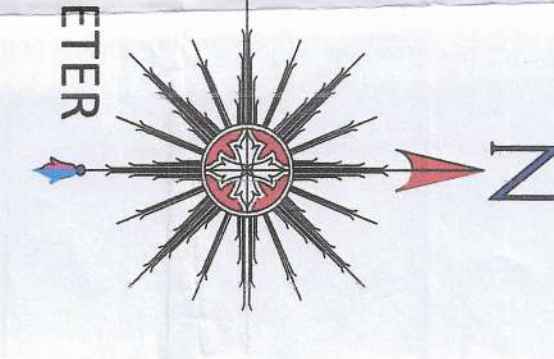

LEGEND

| | | |
|-----|-------------------------------------|--|
| (a) | Manhole/ Chamber | |
| (b) | TF/Electric/Mobile tower | |
| (c) | Street Light/Solar pole | |
| (d) | Revenue Boundary | |
| (e) | City Road | |
| (f) | Murraba Line | |
| (g) | Khasra Line | |
| (h) | Colony Boundary | |
| (i) | HT Line | |
| (j) | Sewerage Line | |
| (k) | Water Supply Line | |
| (l) | Public & Semipublic Area | |
| (m) | Industrial Area | |
| (n) | Commercial Area | |
| (o) | Built Up Area/Residential | |
| (p) | Vacant Land/Plot | |
| (q) | Drain/Culvert / Bridge | |
| (r) | Kitchen Road | |
| (s) | Pucca Road | |
| (t) | Divider Road | |
| (u) | Temple/Mosque/Church/Flag Post | |
| (v) | Statue/School/Airport/Hospital/Well | |
| (w) | Tin Shed | |
| (x) | Parcel Num | |
| (y) | Roads less than 3m | |

KEY PLAN

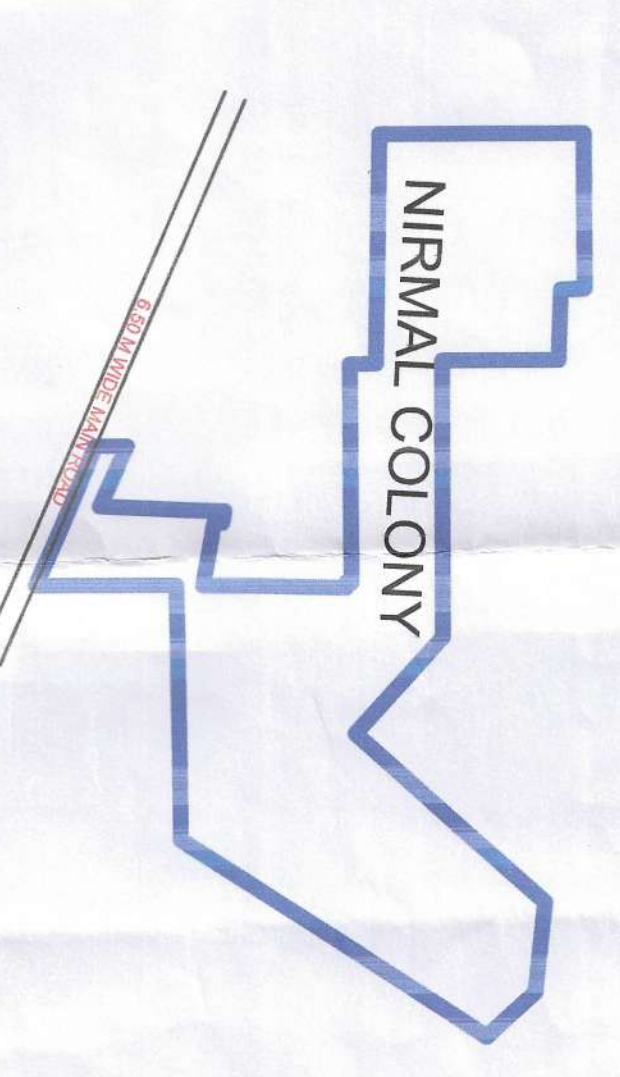

| Client : | Date | Description of revision | Prints Issued |
|-----------|------|-------------------------|---------------|
| IG Drones | | | |

Project : Drone survey unauthorized colony
Haryana

SURVEY CONSULTANT :-
IG Drones
A unit of Inventgrid India Pvt. Ltd.
2n Floor, E-53-54, Block E, Sector 3,
Noida, Delhi NCR 201301

| Checked By: | Surveyor: | Sheet :- |
|-------------|-----------|-----------------|
| | | Sht. No. 1 OF 1 |

This layout plan of unauthorized colony is approved and notified by the Government vide notification no. 09/25/2024 - JC - II dated 09/25/2024. The plan is scanned for updating on the web portal.

Building Inspector
Ambala Cantt

Municipal Engineer
Ambala Cantt

Secretary
Ambala Cantt

Executive Officer
Ambala Cantt

Deputy Town Planner
Ambala

Administrator
Ambala Cantt

Deputy Municipal Commissioner
Ambala

Deputy Municipal Commissioner
Ambala

Deputy Municipal Commissioner
Ambala

Deputy Municipal Commissioner
Ambala

Deputy Municipal Commissioner
Ambala

Deputy Municipal Commissioner
Ambala

Deputy Municipal Commissioner
Ambala