

YAMUNA NAGAR

REVISED COLONY BOUNDARY LAYOUT PLAN OF THE KALINDI COLONY (52) IN KHASRA NO.- 0/858, 859, 860, 864, 865, 866, 867, 868, 869, 870, 871, 872, 873Min, 892Min, 893 Min, 895 Min, 896, 897 Min, 934 Min, 935 Min, 936 Min, 938 Min, 940, 941Min, 863 OF VILLAGE TEJLI TEHSIL JAGADHRI

Checked and verified by

FORMAT FOR CAPTURING INFORMATION REGARDING UNAUTHORISED COLONY

Sr. No.	Parameter Name	Description
1	Colony Name	Kalindi Colony
2	Location of the colony	Near Near Tejli Stadium
3	Total area surveyed in the	48.46 acre
	(a) Area not to be considered (0/861, 862, 893 Min, 895 Min, 897 Min, 916Min, 918, 919, 920Min, 924Min, 925, 930, 931, 932, 933, 934Min, 935Min, 936Min, 937, 938Min)	15.37 acre <i>dm</i>
	(b) Area to be considered for notification (0/858, 859, 860, 864, 865, 866, 867, 868, 869, 870, 871, 872, 873Min, 892Min, 893 Min, 895 Min, 896, 897 Min, 934 Min, 935 Min, 936 Min, 938 Min, 940, 941Min, 863)	33.09 acre <i>dm</i>
4	Type of Colony and use (in %)	Residential 49.47%
		Vacant 30.64%
		Road 19.89%
5	Controlled Area	Yes (YNR/JAG)
6	Urban Area	Yes (YNR/JAG)
7	Year of establishment	1998
8	Layout Plan (at 1 cm : 12m)	Attached
9	Total Plots	763
10	Builtup Plots	340
11	Number of vacant plots	131
12	Number of plots not considered	292
13	Does the colony have street light?	Partial
14	Does the colony have water supply through pipelines?	Yes
15	Does the colony have underground sewerage facility?	Partial
16	If connected to any external Sewage treatment plant? (Y/N)	No
17	Does the colony have Park or Open space	Yes
18	Road type on Colony (kacha/pucca)	Kuccha/Pucca
19	Width of different roads (in meters)	Road Width Length (in mtrs)
		3 to 6 M 692
		6 to 9 M 2362
20	Minimum Road Width	5 M
21	Electricity provided to households through which sub station	Jagadhri
22	Does the colony have community site	Yes
23	Area of the community site (in Acres)	0.6
24	Is the RWA registered	No
25	Additional Information, if any	-
26	Approch Road Width	10 Mtr.

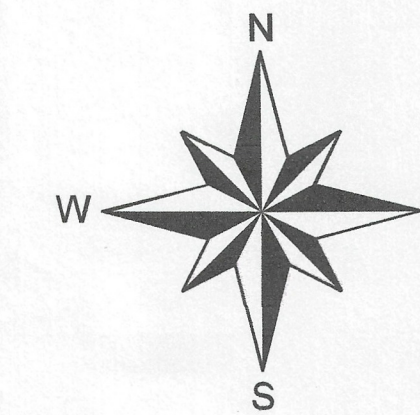

ALL THE DIMENSIONS AND AREA IN METER ONLY

LEGEND

- (a) Manhole/ Chamber
- (b) TF/Electric/Mobile Tower
- (c) Street Light/Solar Pole
- (d) School/Hospital/Airport
- (e) City Road
- (f) Revenue Boundary
- (g) HT Line
- (h) Sewerage Line
- (i) Water Supply Line
- (j) Temple/Mosque/Church
- (k) Public & Semi Public Area
- (l) Murabba Line
- (m) Khasra Line
- (n) Kuccha Road
- (o) Pucca Road
- (p) Colony Boundary
- (q) Built Up Area / Residential
- (r) Commercial Area
- (s) Industrial Area
- (t) Vacant Land
- (u) Drain/Culvert/Bridge
- (v) Water Body

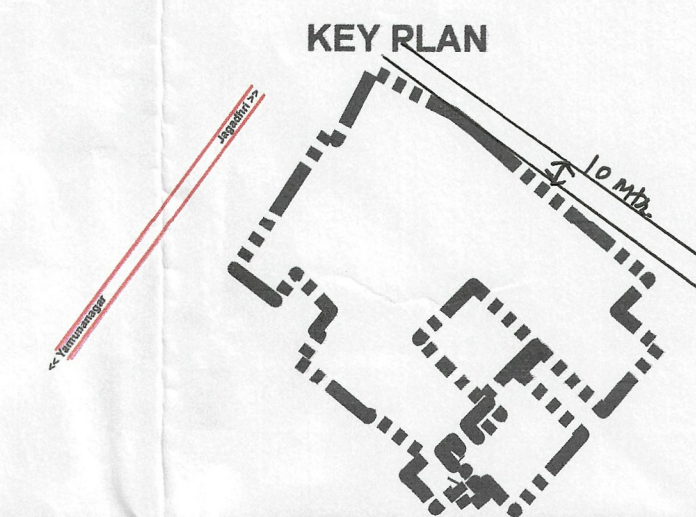

Drawing No.- YNR/JAG-120/2022

Checked By:
O/O District Town Planner-
Yamuna Nagar
O/O Municipal Corporation

FI Patwari
JE JE
ATP ATP
DTP DTP
DMC DMC
AMC AMC
WCMC WCMC
Commissioner Commissioner
Ambala Division Ambala Division

This layout plan of unauthorised colony is approved and notified by the Government vide notification no. 09/121/2023 - 4CII dated 15th December, 2023. The same be scanned for uploading on the web portal.

dm
Consultant/PE
ATP

Client:

Sl No.	Date	Description of Revision	Prints Issued
Project: Drone Survey unauthorized Colony Haryana			
Survey Consultant:- Ace Architects, 155B, First Floor Sec 82 Mohali			
Checked:			Scale:- 1:1000
Drawn By:			Surveyor:
			Sht No. 1 of 1