

Barwala Hisar

DWG No-18

Layout Plan Of New Taj Colony & Others (ID 13441)
 Bearing Khasra No. 379/16, 17, 18 min, 21 min, 22, 23, 24, 25, 380/20, 21, 407/1, 10, 11, 20, 21 min, 408/1 min, 2 min, 3 min, 4 min, 5 min. Of Revenue Estate Of Barwala Tehsil Barwala District Hisar.

Format For Capturing information Regarding Unauthorised Colony

Sr. No.	Parameter Name	Description	
1	Colony Name	New Taj Colony & Others (ID 13441) Barwala (Hisar)	
2	Total Area Of Colony	16.56 Acre	
3	Location Of Colony	Barwala-Banbhouri Road	
4	Type of Colony and use (in %)	(i) Within MC	Yes
		(ii) Outside MC	
5	Controlled Area	Residential	0.76%
		Industrial (not to be regularized)	%
		Vacant	86.10%
		Commercial (not to be regularized)	%
6	Urban Area	Barwala	
7	Year of establishment	2013 & 2019	
8	Layout Plan (at 1 cm : 10m)	Attached	
(Note: separate guidelines for layout attached for reference)			
9	Total Number Of Plots (residential+vacant)	8+5=13	
10	Total Number Of Constructed Plots	8	
11	Total Number of vacant plots	5	
12	Number of families residing in the colony	8	
13	Does the colony have street light?	No	
14	Does the colony have water supply through pipelines?	No	
15	Does the colony have underground sewage facility?	Yes	
16	If connected to any external Sewage treatment plant? (Y/N)	No	
17	Does the colony have Park or Open space	No	
18	Road type on Colony (katcha/pucca)	Katcha/Pucca	
19	Width of different roads (MTRS)	Road Width	Length (in mtrs)
20	Minimum Road width	6 m	1225 m
21	Maximum Road width	9 m	
22	Electricity provided to households through which sub station	Barwala	
23	Does the colony have community site (In Acres)	Nil	
24	Is the RWA registered	No	
25	Drainage	No	
26	Revenue Rasta	No	
27	Additional Information, if any	No	

Layout Plan Drone Based Survey New Taj Colony & Others (ID 13441) Barwala (Hisar)

Key Plan

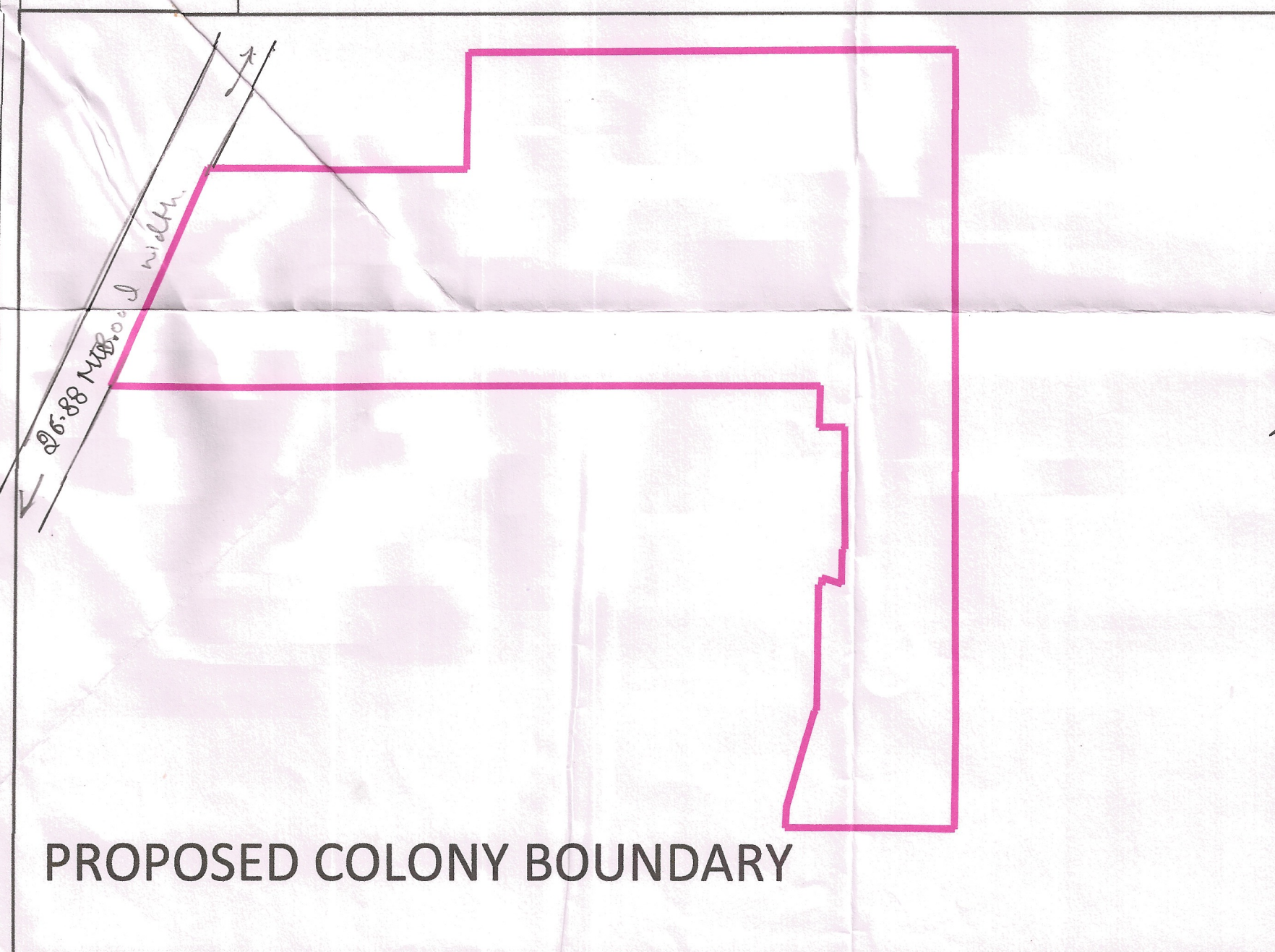

PROPOSED COLONY BOUNDARY



Layout Plan Of New Taj Colony & Others (ID 13441) Barwala (Hisar)

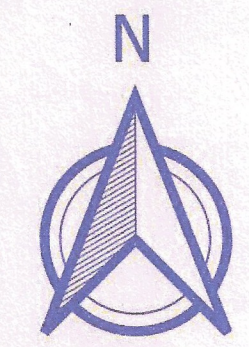

Total Area Of Colony = 67054.58 sq m. (16.56 acer)
 Total Residential Area = 515.56 sq m. (0.12 acer)
 Total Vacant Plot Area = 999.13 sq m (0.24 acer)
 Total Vacant Land Area = 56735.64 sq m (14.01 acer)
 Total Road Area = 8804.29 sq m (2.17 acer)
 Layout: Pucca At Scale 1:1000
 Plots Area Marked In Sq Meters In The Plots.
 Vacant Length And Width Written In To Plots.
 Layout Drawn As Overlay To The Satellite Imagery.

Legend

- Outer Boundary of Colony
 - Khasra Boundary
 - Killa Boundary
 - Revenue Estate Boundary
 - Residential Area
 - Commercial Area
 - Vacant Plot
 - Vacant Land
 - HT Line
 - Electric Pole
 - ▲ DT
 - Sewage
 - Pucca Road
 - Katcha Road
 - Major Road Centre Line
 - Major Road
- Drone Based Satellite Image

Surveyed by:

(PT) (FI) (JE)

Drawing prepared and finalised by:

(AD) (JD/SD) (PA) (ATP) (DTP)

Client:

SURVEY CONSULTANT :-

BR Geotechnology

Checked:

Surveyor:
 Drawn By:
 Drawing No. 1 of 1 Sht. No= Sheet: A1

Scale:- 1:1000

Re v.N o. R0

Note:

Revised considerable area in the Original Layout as per the discussion held at DULB, Chandigarh on 18.01.2023 and as per the directions received vide memo DULB/TP/2023/339-449 dated 13.01.2023 & e-mail dated 03.02.2023

This layout plan of unauthorised colony is approved and notified by the Government vide notification no. 04/42/2023 - 2CI dated 25th July, 2023. The same be scanned for uploading on the web portal.

0 25 50 m

Consultant/PE
 ATP
 Municipal Engineer
 Municipal Committee
 Barwala
 Junior Engineer
 Municipal Committee
 Barwala
 Secretary
 Municipal Committee
 BARWALA
 Dist. Municipal Commission
 HISAR
 18-3-23