

DISTRICT JIND

LAYOUT PLAN OF UNAUTHORISED COLONY
NEAR SHARDA VIDYA MANDIR SEN. SEC. SCHOOL
IN THE REVENUE ESTATE OF AMARHERI
TEH.JIND AND DIST. JIND

KHASRA NO

155min, 156min, 158min, 159, 160,
161, 162min, 163, 164min, 165, 166min, 184min

KEY PLAN MC Boundary

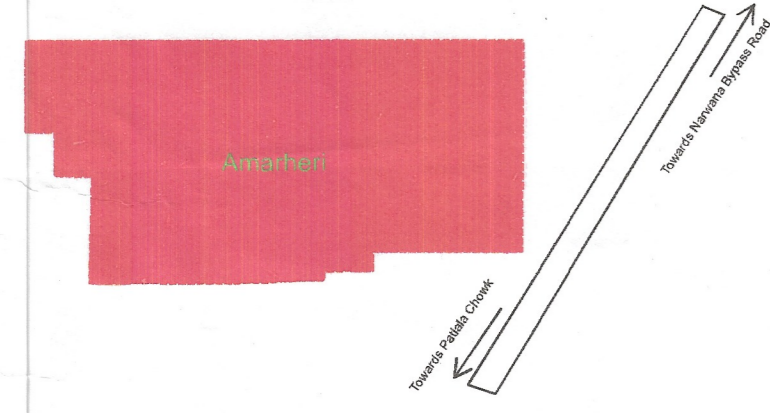

DETAILS OF UNAUTHORIZED COLONY					
Sr. No.	Parameter Name	Description			
1	Colony name	Jind_UC-32B			
2	Area	8.54 Acres 34951.43 Sq/M			
3	Location of the colony	Sharda Vidya Mandir Sen. Sec. School			
4	Municipal Limits Boundary (MC STATUS):	(i) Within MC Yes			
		(ii) Outside MC No			
		(iii) Partial MC No			
5	Type of Colony and use (in %)	Area (%)	Area(Acres)	Area(Sq/M)	
		Residential	42%	3.59	14548.74
		Vacant + Open	36%	3.11	12591.71
		Road	20%	1.72	6924.78
		Commercial	1%	0.10	410.88
		Industrial	0%	0.00	0.00
6	Name of Revenue Estate	Amarheri			
	Pincode name	Jind			
7	Name of Controlled Area	Jind			
8	Urban Area	Jind			
9	Year of establishment	2015			
10	Total No. of Plots	237			
11	No. of Constructed Plots (Residential/Commercial/Industrial/Semi-Public)	138+1+0+1=140			
12	Number of vacant plots	97			
13	Number of families residing in the colony	138			
14	Does the colony have street light?	No			
15	Does the colony have Electric Line	Yes			
16	Does the colony have HT Line	No			
17	Does the colony have water supply through Pucca Road?	No			
18	Does the colony have underground sewerage facility?	No			
19	Does the colony have Park or Open space	No			
20	Road type on Colony (Kuccha/Pucca)	Kuccha & Pucca			
22	Different roads (in meters)	Road Width	Length (in mtrs)		
		Pucca Road	4.6 M To 6.4 M 1052.4 M		
	Kuccha Road	5.5 M to 6.4 M 503.16 M			
23	Minimum Road Width	4.6 M			
24	Area of the community site(in acres)	No			
25	Is the RWA registered	No			
26	Additional information, if any	No			
27	Name of Electric Substation	DHBVN			

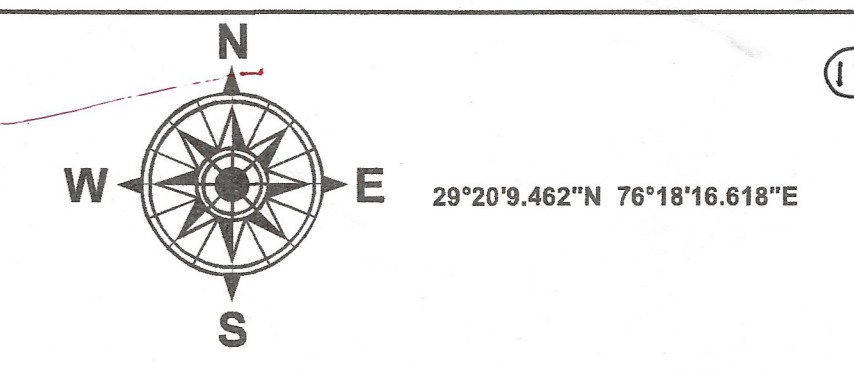

LEGEND

- Airport
- Electric Pole
- Hospital
- Man Hole
- Mobile Tower
- Mosque
- School/College (exclude)
- Solar Pole
- Street Light
- Temple
- Transformer
- HT Line
- LT Line
- Kuccha Road
- Pucca Road
- Major Road Line
- Drainage
- Sewerage Storm water
- Kuccha Road Polygon
- Pucca Road Polygon
- Residential
- Commercial (exclude)
- Industrial
- Plot Boundary
- Vacant Land
- Park
- Colony Boundary
- Khasra Boundary
- Revenue Estate Boundary
- Mustil Boundary
- District Boundary
- Semi-Public

NOTE:-
 * ALL DIMENSIONS ARE IN METERS AND AREA IN SQUARE METERS.
 * AREA OF RESIDENTIAL BUILDINGS IS INDICATED THROUGH PINK COLOUR.
 * AREA OF PLOT BOUNDARY IS INDICATED THROUGH PURPLE COLOUR.

DRG. NO D.T.P. (J) DT.
 LAYOUT PLAN CHECKED AND VERIFIED AT SITE BY:
 PATWARI: *Rajendra*
 JUNIOR ENGINEER: FI *[Signature]*
 JUNIOR DRAFTSMAN: *[Signature]*
 DISTRICT TOWN PLANNER: *[Signature]*
 SENIOR TOWN PLANNER:
 OFFICE OF DISTRICT TOWN PLANNER, JIND
 TOWN & COUNTRY PLANNING DEPTT, HARYANA

This layout plan of unauthorised colony is approved and notified by the Government vide notification no. 04/42/2023 - 2C1 dated 6th October, 2023. The same be scanned for uploading on the web portal.
 PE *[Signature]* Consultant/PE *[Signature]* ATP *[Signature]*

District Municipal Commissioner *[Signature]*
 Executive Officer Municipal Council Jind *[Signature]*
 Executive Engineer Municipal Council, Jind *[Signature]*
 Municipal Engineer Municipal Council, Jind *[Signature]*

[Signature]
 (J.E.)
 M.C. Jind

SCALE : 1 CM = 10 M 0 5 10 20 30 M

DRONE SURVEY AND LAYOUT PLAN PREPARED BY:-



CHECKED :	SURVEYOR :	SCALE :-
DRAWN BY :-		
DRAWING NO :- Jind-UC-32B	SHT. NO.	REV. NO.