

DISTRICT JIND

LAYOUT PLAN OF UNAUTHORIZED COLONY
NEAR NARWANA ROAD
IN THE REVENUE ESTATE OF JIND,
TEH. AND DIST. JIND

KHASRA NO -

0//1093,1094/1min, 1094/2min, 1101min, 1102min,
1103/1, 1104min, 1107min

KEY PLAN

Municipal Engineer
Municipal Council, Jind

DETAILS OF UNAUTHORIZED COLONY				
Sr. No.	Parameter Name	Description		
1	Colony name	JIND-UC-27		
2	Area	4.9 Acres		
3	Location of the colony	Near Narwana Road		
4	Municipal Limits Boundary (MC STATUS):	(i) Within MC	Yes	
		(ii) Outside MC	No	
		(iii) Partial MC	No	
5	Type of Colony and use (in %)	Area (%)	Area(Acres) Area(SQ/M)	
		Residential	36% 1.583 6409.25	
		Vacant + Open	43% 1.937 7838.76	
		Road	21% 0.934 3779.76	
		Commercial	0% 0.000 0.00	
6	Name of Revenue Estate	Jind		
	District Name	Jind		
7	Name of Controlled Area	CA MC Town of Jind		
8	Urban Area	Jind		
9	Year of establishment	2012		
10	Total No. of Plots	75		
11	No. of Constructed Plots(Residential+Commercial+Industrial)	41+0+0=41		
12	Number of vacant plots	34		
13	Number of families residing in the colony	41		
14	Does the colony have street light?	No		
15	Does the colony have Electric Line	Yes		
16	Does the colony have HT Line	No		
17	Does the colony have water supply through pipelines?	No		
18	Does the colony have underground sewerage facility?	No		
19	Does the colony have Park or Open space	No		
20	Road type on Colony (Kuccha/Pucca)	Kuccha		
21	Different roads (in meters)	Road Width	Length (in mtrs)	
		Pucca Road	6	214.82 M
22	Minimum Road Width	Kuccha Road	4 M to 6 M	489.13 M
				4 M
23	Area of the community site(in acres)	No		
24	Is the RWA registered	No		
25	Additional Information, if any	No		
26	Name of Electric Substation	DHBN		

This layout plan of unauthorised colony is approved and notified by the Government vide notification no. 04/42/2023 - 2C1 dated 6th October, 2023. The same be scanned for uploading on the web portal.

PE *[Signature]* Consultant/PE
ATP *[Signature]* ATP

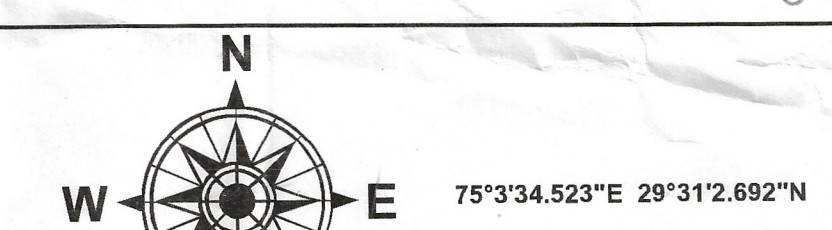

LEGEND

- Airport
- Electric Pole
- Hospital
- Men Hole
- Mobile Tower
- Mosque
- School/College *(Exclude)*
- Solar Pole
- Street Light
- Temple
- Transformer
- HT line
- Kuccha Road
- Pucca Road
- Major Road Line
- Drainage
- Sewerage Storm water
- Kuccha Road Polygon
- Pucca Road Polygon
- Residential
- Commercial *(Exclude)*
- Industrial
- Plot Boundary
- Vacant Land
- Park
- Colony Boundary
- Khasra Boundary
- Revenue Estate Boundary
- Mustil Boundary
- District Boundary

SCALE : 1 CM = 10 M
0 50 100 200 300 M

NOTE:-
• ALL DIMENSIONS ARE IN METERS AND AREA IN SQUARE METERS.
• AREA OF RESIDENTIAL BUILDINGS IS INDICATED THROUGH ORANGE COLOUR.
• AREA OF PLOT BOUNDARY AND VACANT LAND IS INDICATED THROUGH PURPLE COLOUR.

DRG. NO D.T.P. (J) DT. 08/03/2022
LAYOUT PLAN CHECKED AND VERIFIED AT SITE BY:

PATWARI:
JUNIOR ENGINEER: *[Signature]*
JUNIOR DRAFTSMAN: *[Signature]*
DISTRICT TOWN PLANNER: *[Signature]*
SENIOR TOWN PLANNER:

OFFICE OF DISTRICT TOWN PLANNER, JIND
TOWN & COUNTRY PLANNING DEPTT, HARYANA

Executive Officer
District Municipal Council, Jind

Executive Engineer
Municipal Council, Jind

Municipal Engineer
Municipal Council, Jind

M.C. Jind

DRONE SURVEY AND LAYOUT PLAN PREPARED BY:-

Checked	Surveyor	Scale-
Draw By:		Sheet-A0
Drawing No: UC-27		ShtNo. RevNo.