

FATEHABAD

(SHEET NO. 1)

LAYOUT PLAN OF THE EXISTING BHATIA COLONY (ID No. 7620) JIN KHASRA NO. 232//14min, 16.17min, 25 233//19, 20, 21, 22, 23min REVENUE ESTATE OF VILLAGE FATEHABAD, TEHSIL FATEHABAD, DISTT. FATEHABAD

FORMAT FOR CAPTURING INFORMATION REGARDING UNAUTHORIZED COLONY

Sr. No.	Parameter Name	Description
1	Colony name	Existing Bhatia Colony (ID No. 7620)
2	Area	7.06 Acres
3	Location of the colony	Near By Bhatia Colony
	(i) Within MC	Yes
	(ii) Outside MC	Yes
4	Type of Colony and use (in %)	Built-up Area (Residential semi public commercial) 13.03% Road 11.78% Vacant Plot/Land 75.21%
5	Controlled Area	Fatehabad
6	Urban Area	Fatehabad
7	Year of establishment	2011
8	Layout Plan (at 1 cm : 10m)	To be Attached
9	Does the colony have street light?	No
10	Does the colony have water supply through pipelines?	Yes
11	Does the colony have underground sewerage facility?	No
12	If connected to any external Sewerage treatment plant? (Y/N)	No
13	Does the colony have Park or Open space	No
14	Road type on Colony (kuchha/pucca)	Partly Kuchha/Pucca
15	Width & Length of different roads (in meters)	Road Width upto 3m 0 M 3m to 5m 666/76 M 5m to 9m 0 M above 9m 0 M
16	Electricity provided to households through which sub station	FATEHABAD
17	Does the colony have community site	No
18	Area of the community site (in acres)	No
19	Is the RWA registered	No

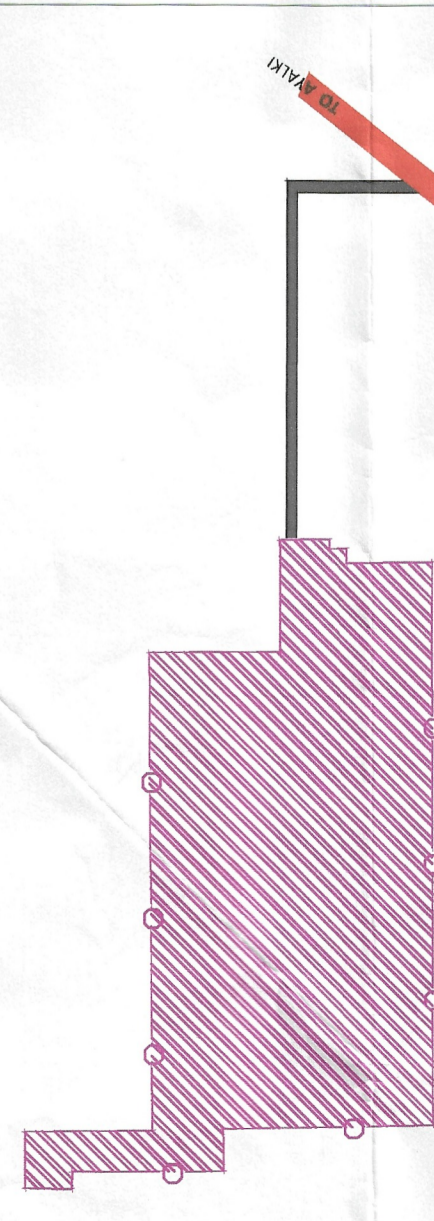

KEY PLAN

Surveyed by: (PATWARI) (F.I.)
Drawing prepared and finalised by: (AD) (ID) (ATP) (DTP)



NOTE:- VACANT PLOTS HAVING AREA MORE THAN 4000 SQM EXCLUDED FROM THE BOUNDARY AS PER CAULES 5 a) OF ULB NOTIFICATION DATED 03.03.2023, 2.APPROACH 3 KARAM (5 METERS WIDE) FROM APPROVED COLONY

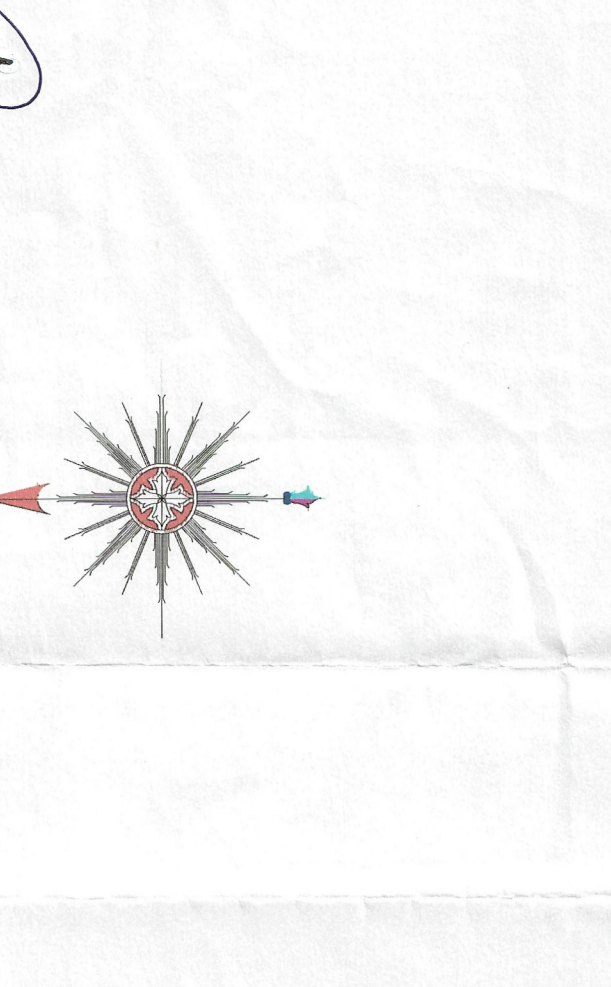

ALL THE DIMENSION AND AREA IN METER ONLY

LEGEND

Manhole/ Chamber	
TF/Electric/Mobile tower	
Street Light/Solar pole	
Revenue Boundary	
City Road	
Murraba Line	
Khasra Line	
Colony Boundary	
HT Line	
Vacant Land/Plot	
Public & Semipublic Area	
Commercial Area	
Built Up Area/Residential	
Drain	
Kuchha Road	
Pucca Road	
Less than 3m wide road	
Industrial Area	
Sector Road	
HT Buffer/Green Belt	
Temple/Mosque	

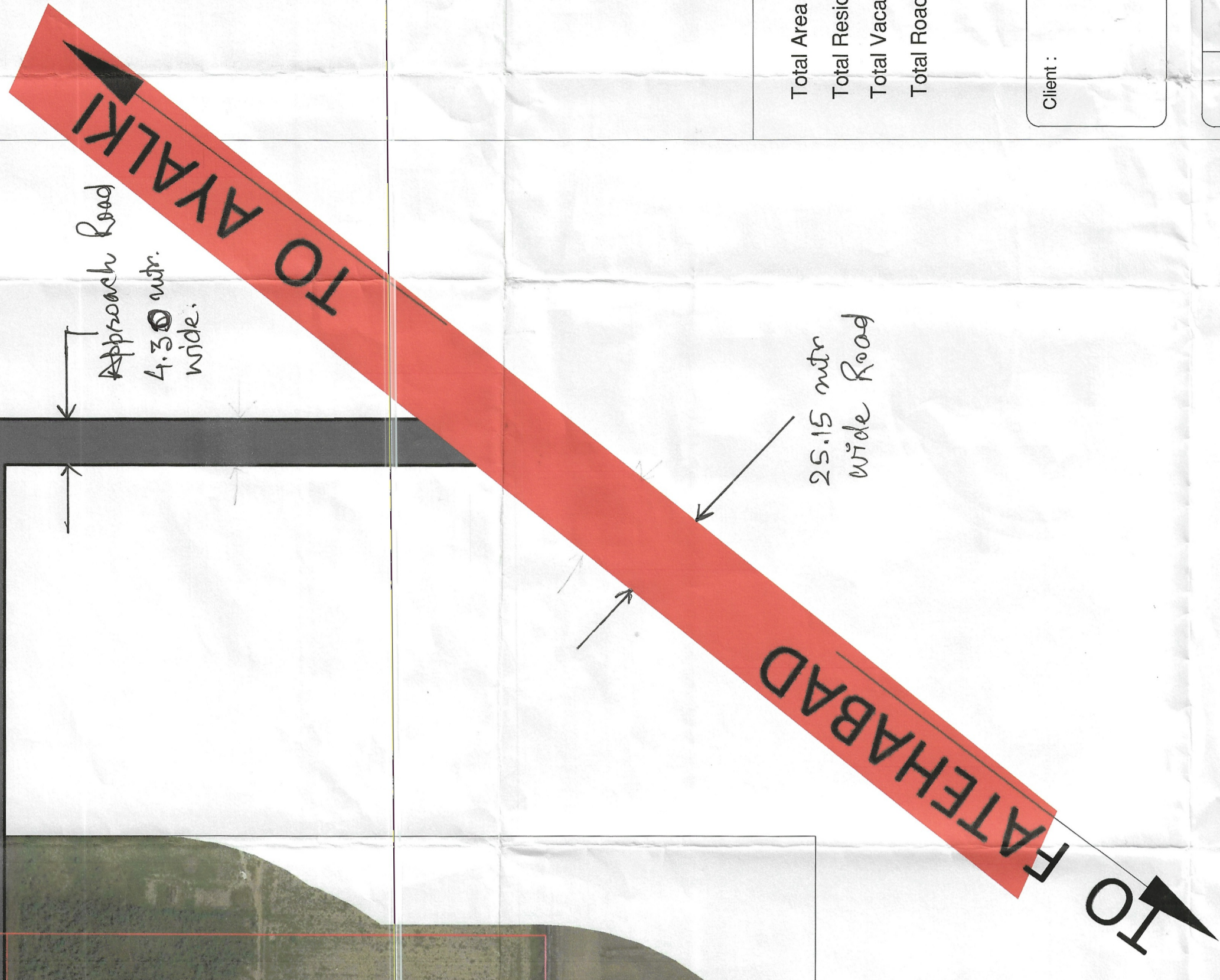

Total Area of Colony = 28579.81 Sq. Meter. (7.06 Acre)
Total Residential Area = 3705.51 Sq. Meter. (0.92 Acre)
Total Vacant Land/Plot Area = 21487.7 Sq.Meter. (5.31 Acre)
Total Road Area = 3376.6 Sq. Meter. (0.83 Acre)

Client:	SI.No.	Date	Description of revision	Prints Issued

This layout plan of unapproved colony is submitted for the approval of the District Municipal Commissioner, Fatehabad, Punjab, on 04/12/2023. The same is for the approval of the District Municipal Commissioner, Fatehabad, Punjab, on 04/12/2023. The same is for the approval of the District Municipal Commissioner, Fatehabad, Punjab, on 04/12/2023.

Checked By: _____ Scale: A0
Drawn By: _____ Sheet: A0
Drawing No: _____ Sht. No. TOF-1
Rev. No. RD

Project: Dione survey unapproved colony Hariyala

SURVEY CONSULTANT

Building Inspector Municipal Council Fatehabad
Junior Engineer Municipal Council Fatehabad
Executive Engineer Municipal Council Fatehabad
District Municipal Commissioner Fatehabad