

DISTRICT SIRSA

LAYOUT PLAN OF UNAUTHORIZED COLONY
NEAR RANIA TO SULTANPURIA ROAD
IN THE REVENUE ESTATE OF VILL RANIA
TEH. RANIA, DIST. SIRSA

KHASRA No. :

172 // 5, 6, 14 min, 15, 16 min, 17 min
173 // 1, 8, 9, 10, 11, 12, 13, 18,
19 min, 20 min

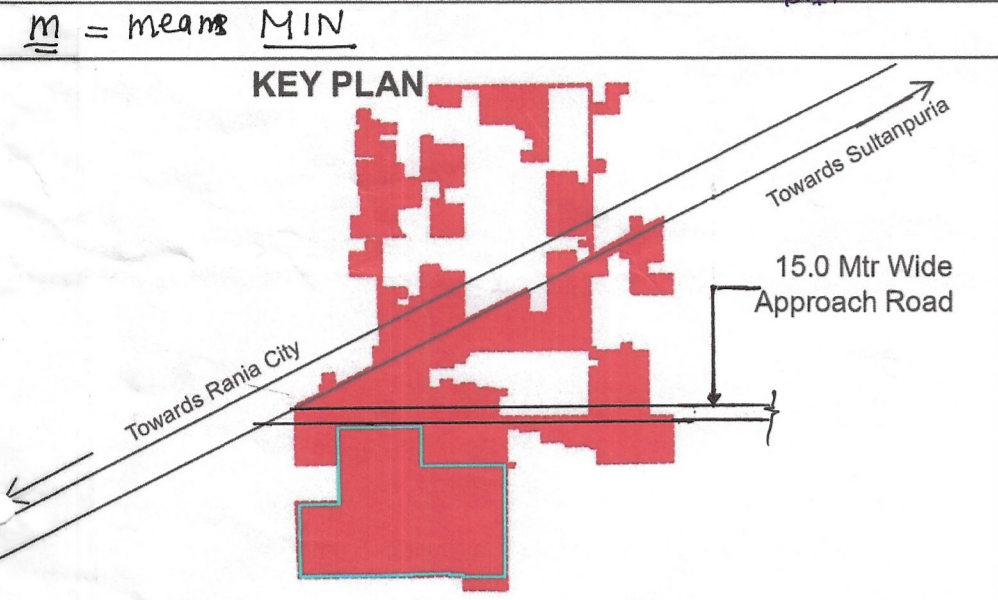

This layout plan of unauthorised colony is approved and notified by the Government vide notification no. 04/42/2023 - 2CI dated 6th October, 2023. The same be scanned for uploading on the web portal.

[Signatures]
PE Consultant/PE ATP

Sr. No.	Parameter Name	Description			
1	Colony name	Rania_UCR-08			
2	Area	15.52 Acres 62,797.43 Sq/M			
3	Location of the colony	Rania City to Sultanpuria Road			
4	Municipal Limits Boundary (MC STATUS):	(I) Within MC Yes			
		(II) Outside MC No			
		(III) Partial MC No			
5	Type of Colony and use (in %)	Area (%)	Area(Acres)	Area(Sq/M)	
		Residential	12.30%	1.91	7,741.98
		Vacant + Open	65.53%	10.17	41,130.74
		Road	22.17%	3.44	13,024.71
		Commercial	0%	0	0.00
6	Name of Revenue Estate	Rania			
		District Name	Sirsa		
		Name of Controlled Area	MC Rania		
		Urban Area	Rania		
7	Year of establishment	2008			
8	Total No. of Plots	162			
9	No. of Constructed Plots(Residential+Commercial+Industrial)	87+0+0 = 87			
10	Number of vacant plots	75			
11	Number of families residing in the colony	87			
12	Does the colony have street light?	Yes			
13	Does the colony have Electric Line	Yes			
14	Does the colony have HT Line	Yes			
15	Does the colony have water supply through pipelines?	Yes			
16	Does the colony have underground sewerage facility?	Yes			
17	Does the colony have Park or Open space	No			
18	Road type on Colony (Kuccha/Pucca)	Kuccha & Pucca			
19	Different roads (in meters)	Road Width	Length (in mtrs)		
		Pucca Road	5.0 Mtr to 7.5 Mtr	296	
		Kuccha Road	5.0 Mtr to 9.9 Mtr	1,358	
20	Minimum Road Width	5.0 Mtr			
21	Area of the community site(in acres)	No			
22	Is the RWA registered	No			
23	Additional Information, if any	No			
24	Name of Electric Substation	Rania			

DRG. NO D.T.P. (S) DT.

LAYOUT PLAN CHECKED AND VERIFIED AT SITE BY

PATWARI :- *[Signature]*

FIELD INVESTIGATOR :- *[Signature]*

JUNIOR ENGG.:- *[Signature]*

ASSISTANT DRAFTSMAN :- *[Signature]*

DISTRICT TOWN PLANNER :-

SENIOR TOWN PLANNER :-

OFFICE OF DISTRICT TOWN PLANNER, SIRSA
TOWN & COUNTRY PLANNING DEPTT, HARYANA

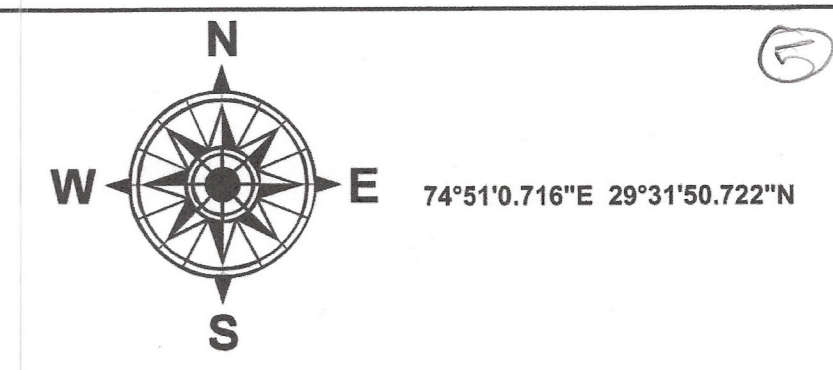

LEGEND

- Airport
- Electric Pole
- Hospital
- Man Hole
- Mobile Tower
- Mosque
- School/College
- Solar Pole
- Street Light
- Temple
- Transformer
- HT Line
- LT Line
- Kuccha Road
- Pucca Road
- Major Road Line
- Drainage
- Sewerage Storm water
- Kuccha Road Polygon
- Pucca Road Polygon
- Residential
- Commercial
- Industrial
- Plot Boundary
- Vacant Land
- Park
- Colony Boundary
- Khasra Boundary
- Revenue Estate Boundary
- Mustil Boundary
- District Boundary

KHASRA No. :
172 // 5, 6, 14 min, 15, 16 min, 17 min
173 // 1, 8, 9, 10, 11, 12, 13, 18, 19 min, 20 min

CHECKED AND VERIFIED BY:

[Signatures]
Secretary Municipal Committee Rania (Sirsa)
Municipal Engineer Municipal Committee Rania
Building Inspector Municipal Committee Rania
District Municipal Commissioner, Sirsa

NOTE:-
* ALL DIMENSIONS ARE IN METERS AND AREA IN SQUARE METERS.
* AREA OF RESIDENTIAL BUILDINGS IS INDICATED THROUGH PINK COLOUR.
* AREA OF PLOT BOUNDARY IS INDICATED THROUGH PURPLE COLOUR.

SCALE : 1 CM = 10 M

0 10 20 40 60 M

DRONE SURVEY AND LAYOUT PLAN PREPARED BY:-

[Signature]
Garuda UAV Solutions Pvt. Ltd.

CHECKED : SURVEYOR : SCALE :-
DRAWN BY :- SHT. NO. REV. NO.
DRAWING NO. :- UC-R-08