

# DISTRICT JIND

LAYOUT PLAN OF UNAUTHORISED COLONY  
NEAR NARWANA TO JIND ROAD  
IN THE REVENUE ESTATE OF JIND  
TEH. JIND AND DIST. JIND

**KHASRA NO**  
41/17min, 18min, 23min, 24min, 25min  
57/3min, 4min, 5min, 7min

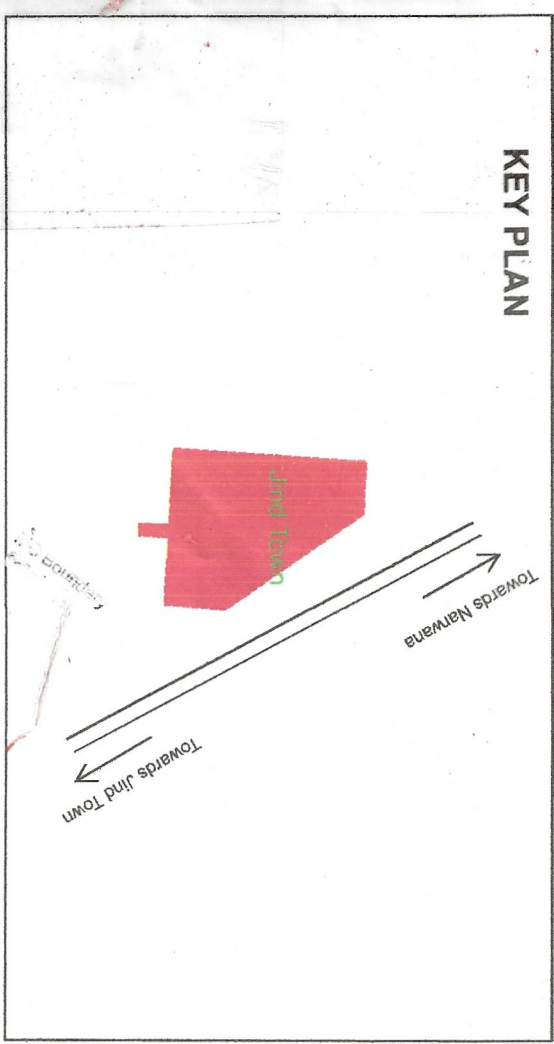

Sl. No.	Parameter Name	Description
1	Colony Name	Ind. OC-248
2	Area	3.40 Acres 33709.54 Sq. Ft.
3	Location of the Colony	(i) Tehsil, MC Near Narwana Road
4	Metreage (Limit Boundary) (MC STATUS)	(ii) District, MC Yes (iii) State, MC Yes
5	Type of Colony and use (In %)	Area (Sq. Feet)   Area (Gunn)   Area (Gunn) Residential 32% 456 1.57 3283.50 Vacant & Open 68% 936 3.40 6233.84 Commercial 0% 0.00 0.00 Industrial 0% 0.00 0.00 Building 20% 2738.10
6	Name of Revenue State	Ind
7	District Name	Ind
8	Name of Constituents Area	Ind
9	Urban Area	Ind
10	Year of establishment	2021
11	Total No. of Plots	28
12	No. of Constructed Plots (Residential/Commercial/Industrial)	17/4/0/17
13	Number of Vacant Plots	11
14	Number of Families residing in the colony	17
15	Does the colony have street light?	No
16	Does the colony have electric line	No
17	Does the colony have IT line	No
18	Does the colony have water supply through pipelines?	No
19	Does the colony have underground sewerage facility?	Yes
20	Does the colony have Park or Open Space	No
21	Road type on Colony (Kuchha/Pucca)	Kuchha
22	Different roads (in meters)	Road Width Length (in meters) Kuchha Road 4 M to 7.5 M 451.3 M
23	Minimum Road Width	4 M
24	Area of the community asset (in acres)	No
25	Is the RWA registered	No
26	Additional Information, if any	No
27	Name of Electric Substation	DRBM

DRG. NO. D.T.P. (J) DT.

LAYOUT PLAN CHECKED AND VERIFIED AT SITE BY:  
PATWARI: *[Signature]*  
JUNIOR ENGINEER: *[Signature]*  
JUNIOR DRAFTSMAN: *[Signature]*  
DISTRICT TOWN PLANNER: *[Signature]*  
SENIOR TOWN PLANNER:

OFFICE OF DISTRICT TOWN PLANNER, JIND  
TOWN & COUNTRY PLANNING DEPTT, HARYANA



This layout plan of unauthorised colony is approved and notified by the Government vide notification no. 04/42/2023 - 2C1 dated 6<sup>th</sup> October, 2023. The same be scanned for uploading on the web portal.  
Consultant/PE: *[Signature]* AT/P  
ATP: *[Signature]*

Area of colony surveyed (including khasra nos.)	Area not to be considered as per clause 5.1.e.	Area of the colony falling under greenbelt/road/buffer zone/vacant land/industrial etc/commercial. (Including khasra nos.)	Area of colony falling outside MC with khasra nos.	FINAL AREA TO BE CONSIDERED FOR NOTIFICATION
41/17min, 18min, 23min, 24min, 25min (3.4 Acres)	Nil	Nil	Nil	41/17min, 18min, 23min, 24min, 25min (3.4 Acres) 57/3min, 4min, 5min, 7min

*[Signatures]*  
District Engineer  
Municipal Council, Jind  
Executive Engineer  
Municipal Council, Jind  
Municipal Engineer  
Municipal Council, Jind

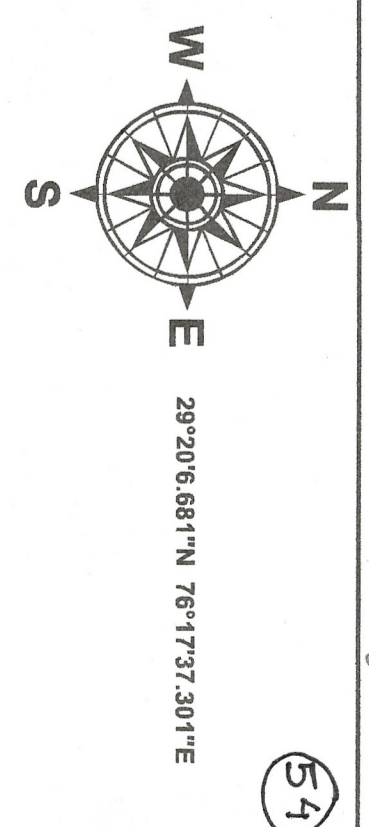

NOTE:  
\* ALL DIMENSIONS ARE IN METERS AND AREA IN SQUARE METERS.  
\* AREA OF RESIDENTIAL BUILDINGS IS INDICATED THROUGH PINK COLOUR.  
\* AREA OF PLOT BOUNDARY IS INDICATED THROUGH PURPLE COLOUR.

SCALE : 1 CM = 10 M

DRONE SURVEY AND LAYOUT PLAN PREPARED BY:-



CHECKED BY:-	SUPERVISOR:-	SCALE:-
DRAWN BY:-	JIND-OC-248	SHT. NO. REV. NO.