

# DISTRICT SIRSA

LAYOUT PLAN OF UNAUTHORIZED COLONY  
NEAR JESUS & MARY CONVENT SCHOOL DABWALI  
IN THE REVENUE ESTATE OF NAI DABWALI  
TEH. DABWALI, DIST. SIRSA

## KHASRA NO

1/16min, 21, 22, 23, 24, 25min  
6/11min, 19min, 20min  
7/11min, 12min, 13min, 14min, 15min, 16min, 17min, 18min, 19min, 20min, 21min, 22min, 23min, 24min, 25min  
8/16, 25  
18/11, 2, 3, 4min, 5min, 7min, 8, 9, 10, 11, 12min, 13min, 14min, 15min, 16min, 17min, 18min, 19min, 20min

## KEY PLAN

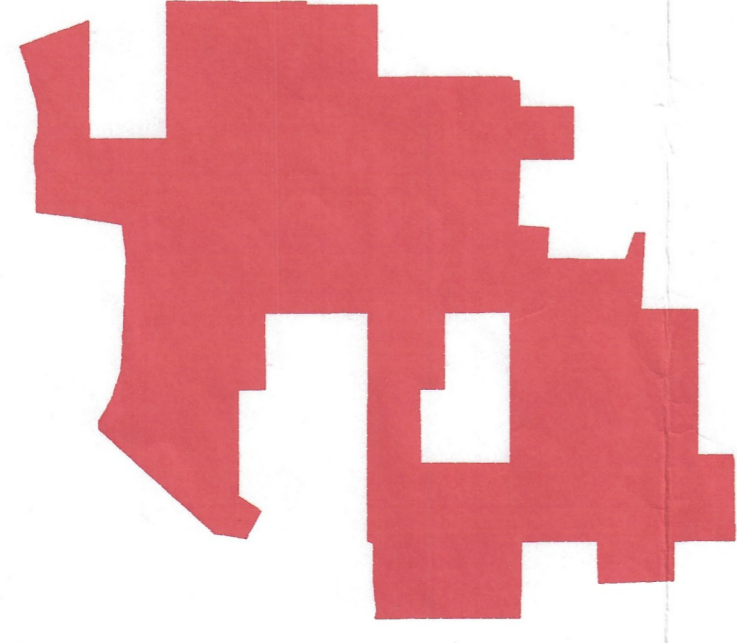

## DETAILS OF UNAUTHORIZED COLONY

Sr. No.	Parameter Name	Description	
1	Colony name	UC-D-03	
2	Area	44.32 Acres 17938.04 Sq/M	
3	Location of the colony	NEAR JESUS & MARY CONVENT SCHOOL DABWALI	
4	Municipal Limits Boundary (MC STATUS):	(i) Within MC	Yes
		(ii) Outside MC	No
5	Type of Colony and use (in %)	(i) Perial MC	No
		(ii) Perial MC	No
6	Name of Revenue Estate	Residential	23%
		Vacant/Open	57%
		Road	14%
		Commercial	0%
		Industrial	0%
7	District Name	Haryana	
8	Name of Controled Area	Dabwali	
9	Urban Area	2009	
10	Year of establishment	2009	
11	Total No. of Plots	506	
12	Population (Residential/Commercial/Industrial)	260/0/0=260	
13	Number of vacant plots	246	
14	Number of families residing in the colony	246	
15	Does the colony have street light?	No	
16	Does the colony have Electric Line	Yes	
17	Does the colony have HT Line	No	
18	Does the colony have water supply through pipeline?	Yes	
19	Does the colony have underground sewerage facility?	Yes	
20	Does the colony have Park or Open space	No	
21	Road type on Colony (Kuccha/Pucca)	Kuccha & Pucca	
22	Different roads (in meters)	Kuccha	Length (in mtrs)
		Pucca	322.23 M
23	Minimum Road Width	3.00 M	
24	Area of the community site (in acres)	5205.65 M	
25	Is the RWA registered	No	
26	Additional Information, if any	No	
27	Name of Electric Substation	Dabwali	

DRG. NO D.T.P. (S) DT.

LAYOUT PLAN CHECKED AND VERIFIED AT SITE BY

PATWARI :-

FIELD INVESTIGATOR :-

JUNIOR ENGG. :-

ASSISTANT DRAFTSMAN :-

DISTRICT TOWN PLANNER :-

SENIOR TOWN PLANNER :-

OFFICE OF DISTRICT TOWN PLANNER, SIRSA  
TOWN & COUNTRY PLANNING DEPTT, HARYANA

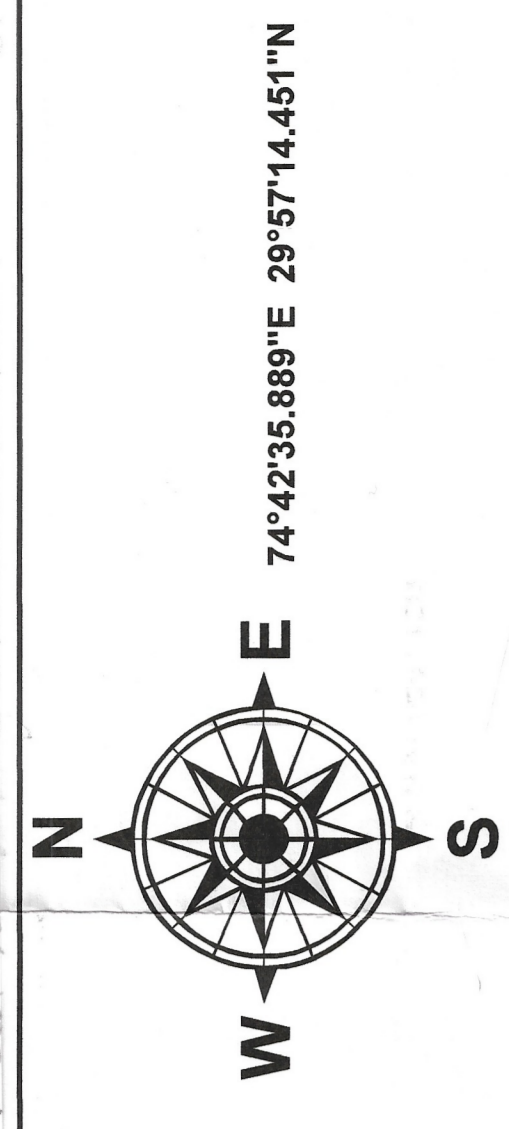

E 74°42'35.889" E 29°57'14.451" N

## LEGEND

- Airport
- Electric Pole
- Hospital
- Manhole
- Mobile Tower
- Mosque
- School/College
- Solar Pole
- Street Light
- Gurudwara
- Transformer
- HT line
- Kuccha Road
- Pucca Road
- Major Road Line
- Drainage
- Sewerage Storm water
- Kuccha Road Polygon
- Pucca Road Polygon
- Residential
- Commercial
- Industrial
- Plot Boundary
- Vacant Land
- Park
- Colony Boundary
- Khasra Boundary
- Revenue Estate Boundary
- Mustil Boundary
- District Boundary

NOTE:-  
\* ALL DIMENSIONS ARE IN METERS AND AREA IN SQUARE METERS.  
\* AREA OF RESIDENTIAL BUILDINGS IS INDICATED THROUGH PINK COLOUR.  
\* AREA OF PLOT BOUNDARY IS INDICATED THROUGH PURPLE COLOUR.

SCALE : 1 CM = 10 M  
0 5 10 20 30 M

DRONE SURVEY AND LAYOUT PLAN PREPARED BY:-



CHECKED:	SURVEYOR:	SCALE:-
DRAWN BY:-		
DRAWING NO :- UC-D-03		

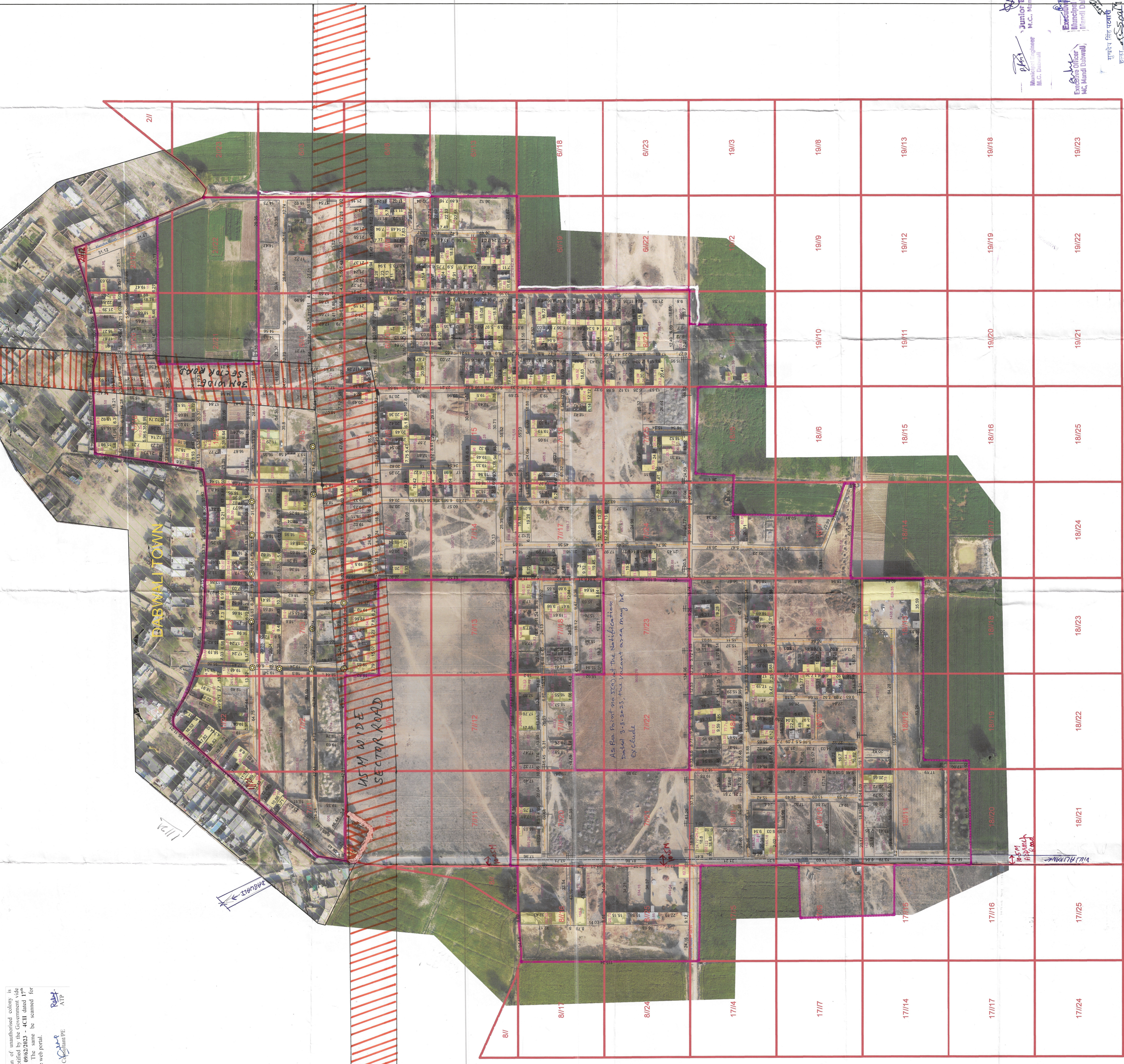

This layout plan of unauthorized colony is approved and notified by the Government vide notification no. 09/02/2023 - 4CU dated 14/02/2023. The same is available for downloading on the web portal.



District Town Planner

Deputy District Commissioner, Sirsa