

**DISTRICT ROHTAK**

LAYOUT OF RAJIV NAGAR SITUATED IN THE REVENUE ESTATE OF VILLAGE ROHTAK TESIL & DISTRICT ROHTAK COMPRISING KHASRA NO. :- 6767-1 6767min, 6768min, 6769min, 6770min, 6771min, 6772min

**KEY PLAN**

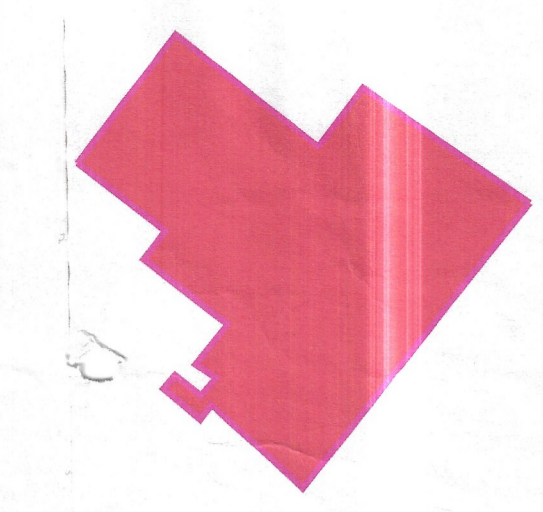

**DETAILS OF UNAUTHORISED COLONY**

Sr. No.	Parameter Name	Description
1	Colony name	RAJIV NAGAR (1488)
2	Area	6.98 Hect
3	Location of the colony	NEAR HOON FARMHOUSE
4	Within SAC	Yes
5	Outside SAC	No
6	Type of Colony and use (in %)	Residential 5% Public 0% Commercial 6.45% Vacant 74.55% Road 10%
7	Controlled Area	ROHTAK
8	Urban Area	ROHTAK
9	Year of establishment	2020
10	Layout Plan (in Scale: 1:500)	3/1660
11	Total Plans	22
12	Construction Plan (Residential + Commercial + Public)	22
13	Number of vacant plots	5
14	Number of families residing in the colony	5
15	Does the colony have Electricity?	Yes
16	Does the colony have water supply through pipelines?	No
17	Does the colony have underground sewerage facility?	No
18	If connected to any natural Storage treatment plant?	No
19	Does the colony have Park or Open space	No
20	Road type on Colony (Width/Grade)	Partly Kachcha/Partly Pucca
21	Width of different roads (in meters)	Road Width: 4-9 M, Length (in meter): 305.7
22	Minimum Road Width	6.00 M
23	Electricity provided to households through which sub station	SUB STATION SCHEDULE
24	Does the colony have connectivity site	No
25	Area of the community site (in acres)	0.00
26	Is the PWD registered	No
27	Additional Information, if any	

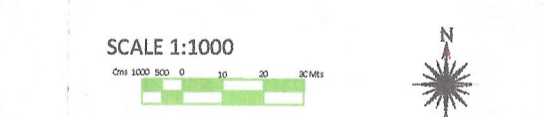

PD CONSULTING ENGINEERS PVT.LTD



hello@pdcegroup.com www.pdcegroup.com  
Red House, Behind MCD School,  
Mehrauli-Gurgaon Rd, Ghitori, Delhi - 30

Checked By:	PDCE	Surveyor:	Sheet No. AD
Drawn By: <td>Plashed</td> <td>Shr. No. :- 1/CF-1</td> <td>Rev No. RO</td>	Plashed	Shr. No. :- 1/CF-1	Rev No. RO

NOTE: ALL DIMENSIONS ARE IN METERS AND AREA IN ACRES.

DRG. NO. DTP(R) 83 DATED 01.03.2022/17.02.23

LAYOUT PLAN CHECKED AND VERIFIED AT SITE BY:-

PATWARI: (Amr) (Amr) (RITU) (RITU)

JUNIOR ENGG. (SANJAY KUMAR)

ASSISTANT DRAFTSMAN (MANISH Dahiya)

JUNIOR DRAFTSMAN (SUMANDEEP)

SENIOR DRAFTSMAN

PLANNING ASSISTANT

ASSISTANT TOWN PLANNER

DISTRICT TOWN PLANNER

SENIOR TOWN PLANNER

OFFICE OF DISTRICT TOWN PLANNER, ROHTAK  
TOWN & COUNTRY PLANNING DEPTT., HARYANA



This layout plan of unauthorised colony is approved and notified by the Government vide notification no. 04/42/2023 - 2CI dated 25<sup>th</sup> July, 2023. The same be scanned for uploading on the web portal.

PE Consultant/PE ATP

LAT- 28-916397 Lon- 76-584465

**LEGEND**

Symbol	Description	Symbol	Description	SR NO.	WIDTH OF INTERNAL ROADS	COLOR
	Colony Boundary		Public & Semipublic Area (Area in Acre)	1	UP TO 1.5M	Orange
	ManHole/ Chamber		Commercial Area	2	1.5 - 2M	Purple
	Transformer / Electric Pole/ Mobile Tower		Residential Area	3	2 - 2.5 M	Blue
	Street Light / Solar Pole		Industrial Area	4	2.5 - 3 M	Light Blue
	Revenue Boundary		Drain / Culvert / Bridge	5	3 - 6 M	Dark Blue
	City Road		Pucca Road	6	6 - 9 M	Grey
	Khasra Line		Temple/Mosque/Church/Flag Post/Sewa Sansthan	7	ABOVE 9M	Black
	Murraba Line		Statue/School/Airport/Hospital/Well			
	Tin Shed					

Fire Station Officer ROHTAK, Tehsildar ROHTAK, Commissioner, Rohtak Division, Rohtak