

DISTRICT JIND

LAYOUT PLAN OF UNAUTHORIZED COLONY
NEAR JIND TO GOHANA ROAD
IN THE REVENUE ESTATE OF PINDARI,
TEH. AND DIST. JIND

KHASRA NO -

51/1/1,1/2min,
40/1min,21min,22min,23min,20/2min,20/1/1min,10/1min,
39/5/1min,35/21min,20min,36/25min,16min

Amith
Municipal Engineer
Municipal Council, Jind

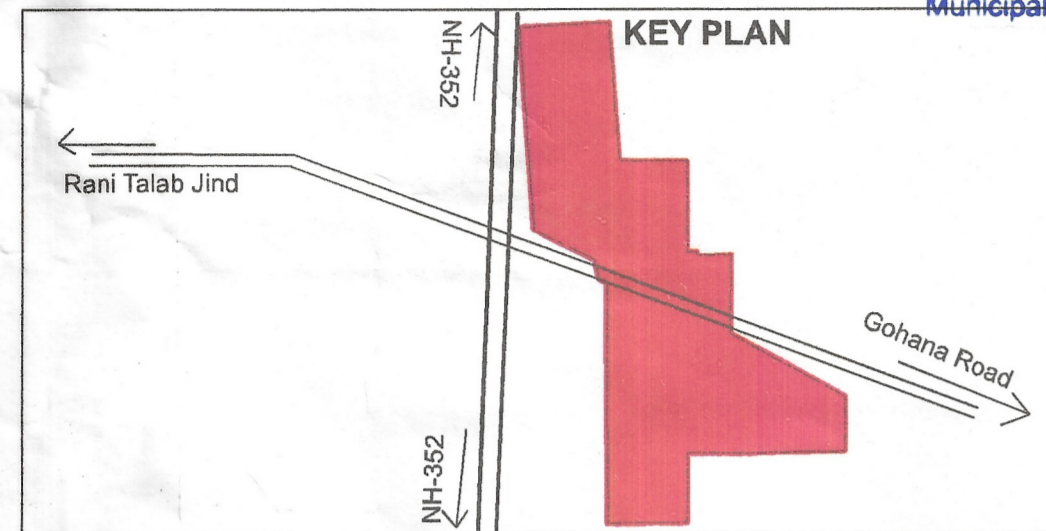

DETAILS OF UNAUTHORIZED COLONY					
Sr. No.	Parameter Name	Description			
1	Colony name	JIND-UC-12			
2	Area	3.8 Acres			
3	Location of the colony	Near Jind to Gohana Road			
4	Municipal Limits Boundary (MC STATUS):	(i) Within MC	Yes		
		(ii) Outside MC	No		
		(iii) Partial MC	No		
5	Type of Colony and use (in %)	Area (%)	Area(Acres)	Area(SQ/M)	
		Residential	16%	1.949	7889.11
		Vacant + Open	72%	8.6026	34813.48
		Road	7%	0.865	3502.15
		Commercial	5%	0.600	2428.23
		Industrial	0%	0	0.00
6	Name of Revenue Estate	Pindari			
	District Name	Jind			
7	Name of Controlled Area	CA MC Town of Jind			
8	Urban Area	Jind			
9	Year of establishment	2006			
10	Total No. of Plots	124			
11	No. of Constructed Plots (Residential+Commercial+Industrial)	55+23+0=78			
12	Number of vacant plots	46			
13	Number of families residing in the colony	12			
14	Does the colony have street light?	No			
15	Does the colony have Electric Line	Yes			
16	Does the colony have HT Line	No			
17	Does the colony have water supply through pipelines?	Yes			
18	Does the colony have underground sewerage facility?	No			
19	Does the colony have Park or Open space	No			
20	Road type on Colony (Kuccha/Pucca)	Kuccha			
21	Different roads (in meters)	Road Width	Length (in mtrs)		
		Pucca Road			
22	Minimum Road Width	4 M			
23	Area of the community site(in acres)	No			
24	Is the RWA registered	No			
25	Additional Information, if any	No			
26	Name of Electric Substation	DHBYN			

This layout plan of unauthorised colony is approved and notified by the Government vide notification no. 04/42/2023 - 2C1 dated 6th October, 2023. The same be scanned for uploading on the web portal.
PE *Amith* Consultant/PE
Annu Bhatnagar ATP

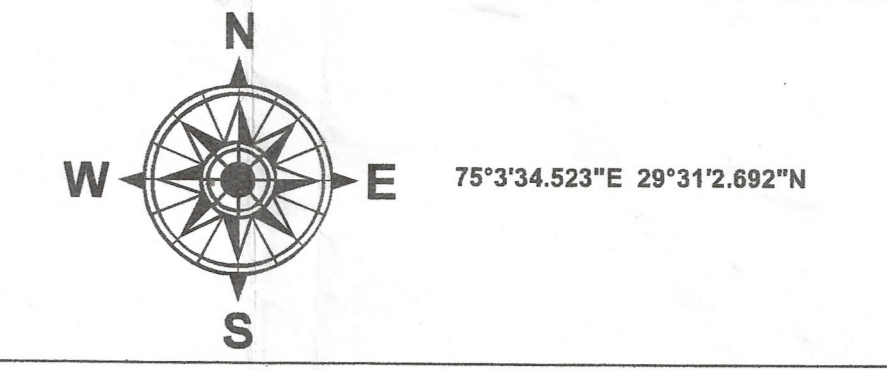

LEGEND

- Airport
- Electric Pole
- Hospital
- Men Hole
- Mobile Tower
- Mosque
- School/College (Exclude)
- Solar Pole
- Street Light
- Temple
- Transformer
- HT line
- Kuccha Road
- Pucca Road
- Major Road Line
- Drainage
- Sewerage Storm water
- Kuccha Road Polygon
- Pucca Road Polygon
- Residential
- Commercial (Exclude)
- Industrial
- Plot Boundary
- Vacant Land
- Park
- Colony Boundary
- Khasra Boundary
- Revenue Estate Boundary
- Mustil Boundary
- District Boundary



NOTE:
* ALL DIMENSIONS ARE IN METERS AND AREA IN SQUARE METERS.
* AREA OF RESIDENTIAL BUILDINGS IS INDICATED THROUGH ORANGE COLOUR.
* AREA OF PLOT BOUNDARY AND VACANT LAND IS INDICATED THROUGH PURPLE COLOUR.



DRG. NO D.T.P. (J) 1363/2022 DT. 08/03/2022

LAYOUT PLAN CHECKED AND VERIFIED AT SITE BY:

PATWARI : *Basu*
JUNIOR ENGINEER : *Amith*
JUNIOR DRAFTSMAN : *Amith*
DISTRICT TOWN PLANNER : *Amith*
SENIOR TOWN PLANNER :

OFFICE OF DISTRICT TOWN PLANNER , JIND
TOWN & COUNTRY PLANNING DEPTT, HARYANA

Amith Municipal Engineer
Municipal Council, Jind
Amith Executive Officer
Municipal Council, Jind
Amith Executive Engineer
Municipal Council, Jind
Amith (JE)
M.C. Jind

DRONE SURVEY AND LAYOUT PLAN PREPARED BY:-



Checked	Surveyor	Scale-
Drawn By:		Sheet-A0
Drawing No:UC-12		ShtNo. RevNo.