

# KARNAL

LAYOUT PLAN OF THE (12647)-DARSHAN SINGH COLONY EXTENSION IN KHASRA NO: 205//10min, 11min, 12min, 19min, 20, 21, 22min, 226//1, 2/1, 8min, 9min, 10, 11, 12, 13min, 19/2, 20, 26, 216//2/2 min

Sr. No.	Parameter Name	Description	
1	Colony name	12647-Darshan Singh Colony Extension	
2	Area	13.24 Acre	
3	Location of the colony	Nissing-Dachar Road	
4	(i) Within MC	(13.49 Acre)	
	(ii) Outside MC	0	
4	Type of Colony and use (in %)	Residential	20.83%
		Public + Vacant	0% + 61.25%
		Commercial + Road	0.16% + 17.76%
5	Controlled Area	NIL	
6	Urban Area	NISSING	
7	Year of establishment	2014	
8	Layout Plan	Attached	
9	Total Plots	130	
10	Constructed Plots ( Residential + Commercial + Public )	57 + 1 + 0 = 58	
11	Number of vacant plots	72	
12	Number of families residing in the colony	57	
13	Does the colony have Electricity?	Yes	
14	Does the colony have water supply through pipelines?	No	
15	Does the colony have underground sewerage facility?	No	
16	If connected to any external Sewage treatment plant? (Y/N)	No	
17	Does the colony have Park or Open space	No	
18	Road type on Colony (kacha/pucca)	Partly Kacha/Pucca	
19	Width of different roads (in meters)	Road Width	Length (in mtrs)
		0 To 3 M	NIL
		3 To 6 M	177.9 M
		6 To 9 M	1528.2 M
		9 M & Above	NIL
Total	1706.1		
20	Minimum Road width	4.6 M	
21	Electricity provided to households through which sub station	NISSING SUB-STATION	
22	Does the colony have community site	No	
23	Area of the community site(in acres)	000	
24	Is the RWA registered	No	
25	Additional Information, if any		

DRAWING NO:KNL/KARNAL- 120/2022  
 Surveyed by: IG DRONES  
 Drawing checked by:

Junior Engineer  
 Municipal Committee  
 Nissing, Karnal

Municipal Engineer  
 Municipal Committee  
 Nissing, Karnal

Secretary  
 Municipal Committee, Nissing

District Town Planner  
 KARNAL

District Municipal Commissioner,  
 KARNAL

महानगर की सीमा के अंदर की जमीन के  
 एक समूह की सन् 2017-18 की तस्वीरों में  
 205//10min, 11min, 12min, 19min, 20, 21, 22  
 min, 226//1, 2/1, 8min, 9min, 10, 11, 12, 13min  
 19/2, 20 की तस्वीरों में 57, 1, 0 कुल 58  
 कुल 58 प्लॉटों की तस्वीरों में 57, 1, 0 कुल 58  
 कुल 58 प्लॉटों की तस्वीरों में 57, 1, 0 कुल 58

28/10/2023  
 Naib Tehsildar  
 Nissing

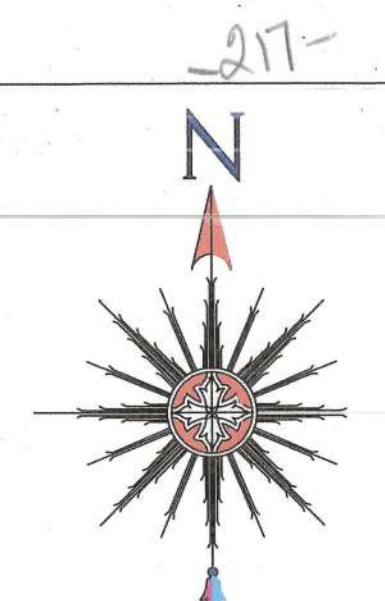

ALL THE DIMENSION IN METER AND ARES IN ACRES

## LEGEND

ManHole/ Chamber	
TF/Electric/Mobile tower	
Street Light/Solar pole	
Revenue Boundary	
City Road	
Murraba Line	
Khasra Line	
Colony Boundary	
HT Line	
Sewerage Line	
Water Supply Line	
Vacant Plot	
Public & Semipublic Area	
Commercial Area	
Built Up Area/Residential	
Vacant Land	
Drain/Culvert / Bridge	
Kuccha Road	
Pucca Road	
Divider Road	
Temple/Mosque/Church/Flag Post	
Statue/School/Airport/Hospital/Well	
Tin Shed	
Parcel Num	00
Industrial Area	
0 To 3 M	
3 To 6 M	
6 To 9 M	
9 M & Above	

## KEY PLAN

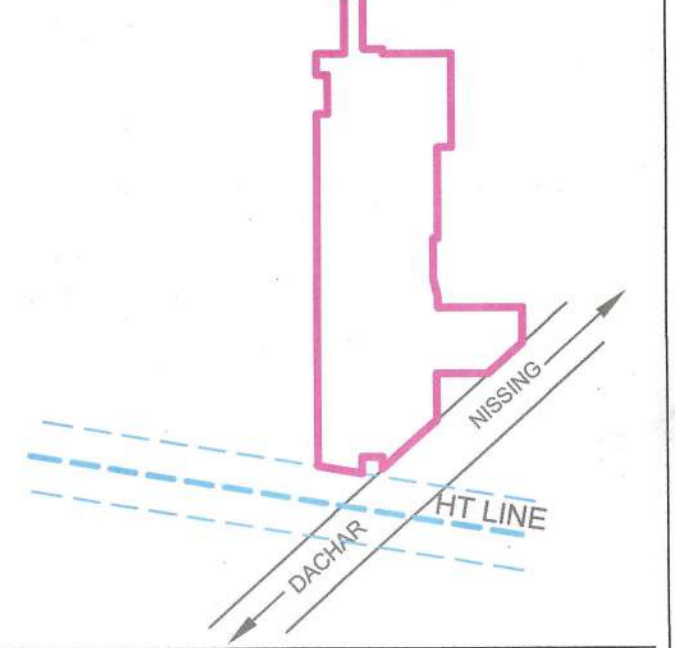

Client:

Sl.No.	Date	Description of revision	Prints Issued

Project: Drone survey unauthorized colony  
 Haryana

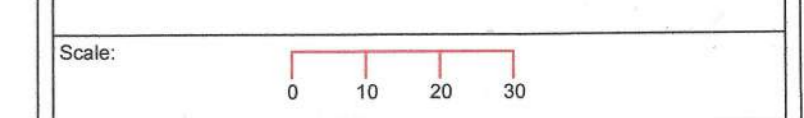

SURVEY CONSULTANT :-



IG Drones  
 A unit of Inventgrid India Pvt. Ltd.  
 2n Floor, E-53-54, Block E, Sector 3,  
 Noida, Delhi NCR 201301

Checked:	Surveyor:	Scale :- 1 CM = 7.2 METER
Drawn By:	Sheet :-	
Drawing No:	SH. No.	Rev. No.
	1 OF 1	RO

This layout plan of unauthorised colony is approved and notified by the Government vide notification no. 04/42/2023 - 2C1 dated 6<sup>th</sup> October, 2023. The same be scanned for uploading on the web portal.

PE  
 Consultant/PE  
 ATP