

YAMUNA NAGAR

REVISED COLONY BOUNDARY LAYOUT PLAN OF THE LAXMI NAGAR EXT. (148) IN KHASRA NO. - 19/8, 9, 10Min, 11Min, 12, 13Min, 19Min, 20Min, 21Min, 22Min, 23, 24/1, 20/16Min, 17, 18Min, 19Min, 22Min, 23, 24, 25Min, 22/11Min, 2Min, 3Min, 4Min, 5Min, 9, 10Min, 11Min, 12Min, 23/11Min, 2Min, 3/1, 10Min, OF VILLAGE CHANDPUR & 44/16Min, 25, 45/19Min, 20Min, 21Min, 46/1, 47/5Min OF VILLAGE SASAULI TEHSIL JAGADHRI

This layout plan of unauthorised colony is approved and notified by the Government vide notification no. 09/12/2023 - 4CII dated 15th December, 2023. The same be scanned for uploading on the web portal.

del Consultant/PE
Kudr ATP

Proposed 30 Mtr.Wide Green Belt

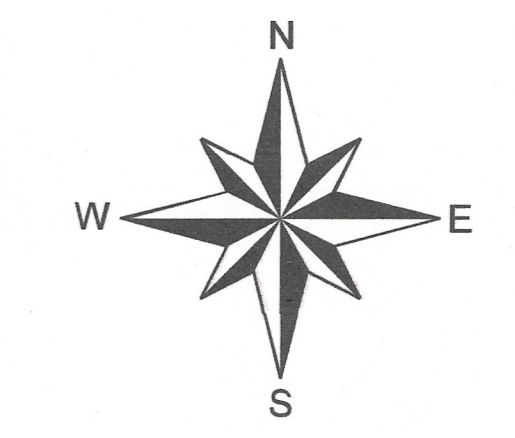

ALL THE DIMENSIONS AND AREA IN METER ONLY

FORMAT FOR CAPTURING INFORMATION REGARDING UNAUTHORISED COLONY

Sr. No.	Parameter Name	Description
1	Colony Name	Laxmi Nagar Ext.
2	Location of the colony	Near Railway Line
3	Total area surveyed in the colony (Ram Nagar)	25.21 Acre
4	(a) Area Under green belt not to be considered (20/18Min, 19Min, 21, 22Min, 22/11Min, 2Min, 10Min, 11Min, OF VILLAGE CHANDPUR & 45/13Min, 19Min, 21Min of Village Sasauli)	1.96 Acre
		(b) Area to be considered for notification (19/8, 9, 10Min, 11Min, 12, 13Min, 19Min, 20Min, 21Min, 22Min, 23, 24/1, 20/16Min, 17, 18Min, 19Min, 22Min, 23, 24, 25Min, 22/11Min, 2Min, 3Min, 4Min, 5Min, 9, 10Min, 11Min, 12Min, 23/11Min, 2Min, 3/1, 10Min OF VILLAGE CHANDPUR & 44/16Min, 25, 45/19Min, 20Min, 21Min, 46/1, 47/5Min of Village Sasauli)
4	Type of Colony and use (in %)	Residential 38.96%
		Vacant 37.97%
		Road 23.07%
5	Controlled Area	Yes (YNR/JAG)
6	Urban Area	Yes (YNR/JAG)
7	Year of establishment	2000
8	Layout Plan (at 1 cm : 10m)	Attached
9	Total Plots	844
10	Builtup Plots	484
11	Number of vacant plots	289
12	Number of plots not considered	71
13	Does the colony have street light?	Partial
14	Does the colony have water supply through pipelines?	Partial
15	Does the colony have underground sewerage facility?	Partial
16	If connected to any external Sewage treatment plant? (Y/N)	No
17	Does the colony have Park or Open space	No
18	Road type on Colony (kacha/pucca)	Kacha/Pucca
19	Width of different roads (in meters)	Road Width Length (in mtrs)
		Less than 3 M 108
		3 to 6 M 3591
20	Minimum Road Width	2.6 M
21	Electricity provided to households through which sub station	YNR/JAG SUB DIV - 1
22	Does the colony have community site	No
23	Area of the community site (in Acres)	NIL
24	Is the RWA registered	No
25	Additional Information, if any	-
26	Approach Road Width	8 Mtr.



LEGEND

- (a) Manhole/ Chamber
- (b) TF/Electric/Mobile Tower
- (c) Street Light/Solar Pole
- (d) School/Hospital/Airport
- (e) City Road
- (f) Revenue Boundary
- (g) HT Line
- (h) Sewerage Line
- (i) Water Supply Line
- (j) Temple/Mosque/Church
- (k) Public & Semi Public Area
- (l) Murabba Line
- (m) Khasra Line
- (n) Kuccha Road
- (o) Pucca Road
- (p) Colony Boundary
- (q) Built Up Area / Residential
- (r) Commercial Area
- (s) Industrial Area
- (t) Vacant Land
- (u) Drain/Culvert/Bridge
- (v) Water Body

KEY PLAN

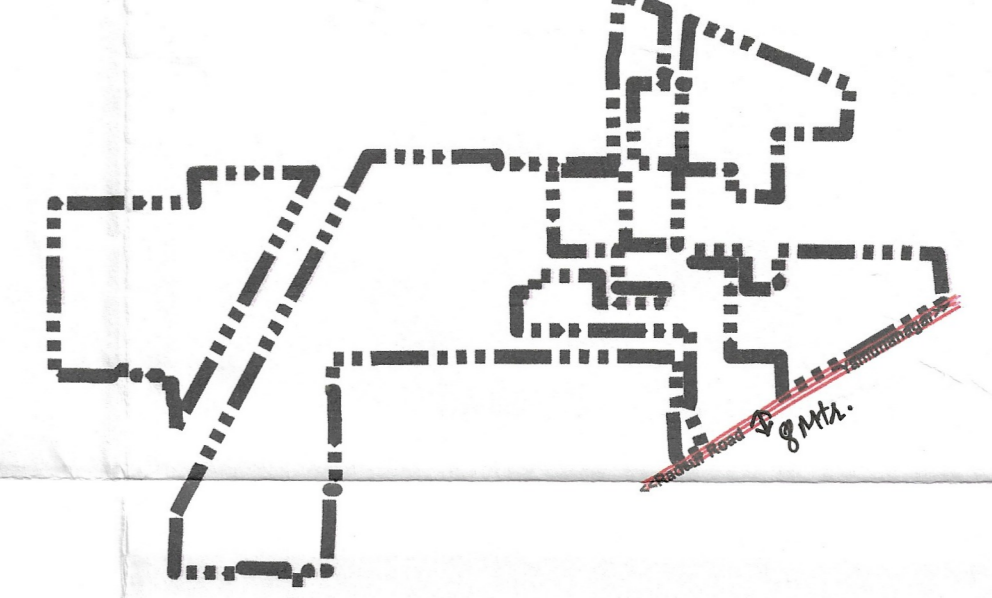

Drawing No.- YNR/JAG-141/2022

Checked By:
O/O District Town Planner-
Yamuna Nagar
O/O Municipal Corporation
Yamuna Nagar - Jagdhri

Patwari *JE* *ATP* *DTP*
Patwari *B.I* *ATP* *DTP*
DMC *AMC* *WSMC* *Commissioner*
Ambala Division

Client:

Sl No.	Date	Description of Revision	Prints Issued

Project: Drone Survey unauthorized Colony Haryana

Survey Consultant:- Ace Architects, 155B, First Floor Sec 82 Mohali

Checked: Scale:- 1:1000
0 125 250 500 750 1000 Meters

Drawn By: Surveyor:

Sht No. 1 of 1