

MC CHEEKA

(13)

LAYOUT PLAN OF THE MAHA SINGH COLONY IN KHASRA NO. - 103//4, 103//5, 103//6min, 103//3min, 103//7min, 103//8min. Of Village Of Cheeka, TEHSIL GUHLA.

Format For Capturing information Regarding Unauthorised Colony

Sr. No.	Parameter Name	Description	
1	Colony Name	Maha Singh Colony	
2	Total Survey Area Of Colony	4.48 Acres + 0.28 = 4.86 Acres	
2(a)	Area Under Road Widening	Nil	
2(b)	Area Under Green Belt Land	Nil	
	Area Out	0.86	
	No. Of Plot And Khasra No. Which Not To Be Considered	Khasra No.=103/8min. 103//7min.	No Of Plots=9
	Area Of Colony To Be Consider For Notification (103//4, 103//5, 103//3min, 103//6min, 103//7min, 103//8min)	3.62 Acres + 0.28 =	4 Acres
	Location Of Colony	Kaithal Patiyala To Balbehra Road	
		(i) Within MC	Yes
		(ii) Outside MC	No
4(a)	Development Plan Zone	Not Published	
	Type Of Use In Colony (In %)	Residential	5.56%
		Commercial	7.41%
		Industrial	0%
		Vacant	67.79%
		Road	19.24%
5	Controlled Area	Cheeka	
6	Urban Area	Guhla-Cheeka	
7	Year of establishment	2020	
8	Layout Plan (at 1 cm : 8 m)	Attached (Note: separate guidelines for layout attached for reference)	
9	Total Plots (Residential+Commercial+Vacant)	7+4+26=37	
10	Constructed Plots	11	
11	Number of vacant plots	26	
12	Number of families residing in the colony	7	
13	Does the colony have street light?	No	
14	Does the colony have water supply through pipelines?	No	
15	Does the colony have underground sewage facility? If connected to any external Sewage treatment plant? (Y/N)	No	
17	Does the colony have Park or Open space	No	
18	Road type on Colony (kaccha/pucca)	Kaccha/Pucca	
19	Width of different roads (In Mtrs)	Road Width	Length (in mtrs) 414 MTR
	Road width	7.0 M To 7.0 mtr	
20	Minimum Road width	7 m	
21	Electricity provided to households through which sub station	Guhla	
22	Does the colony have community site (In Acers)	Nil	
23	Is the RWA registered	YES	
24	Drainage	NO	
25	Revenue Rasta	NO	
26	Additional Information, if any	--	

Key Plan Drawing No.- (KTL)/ Guhla-Cheeka-21/2022

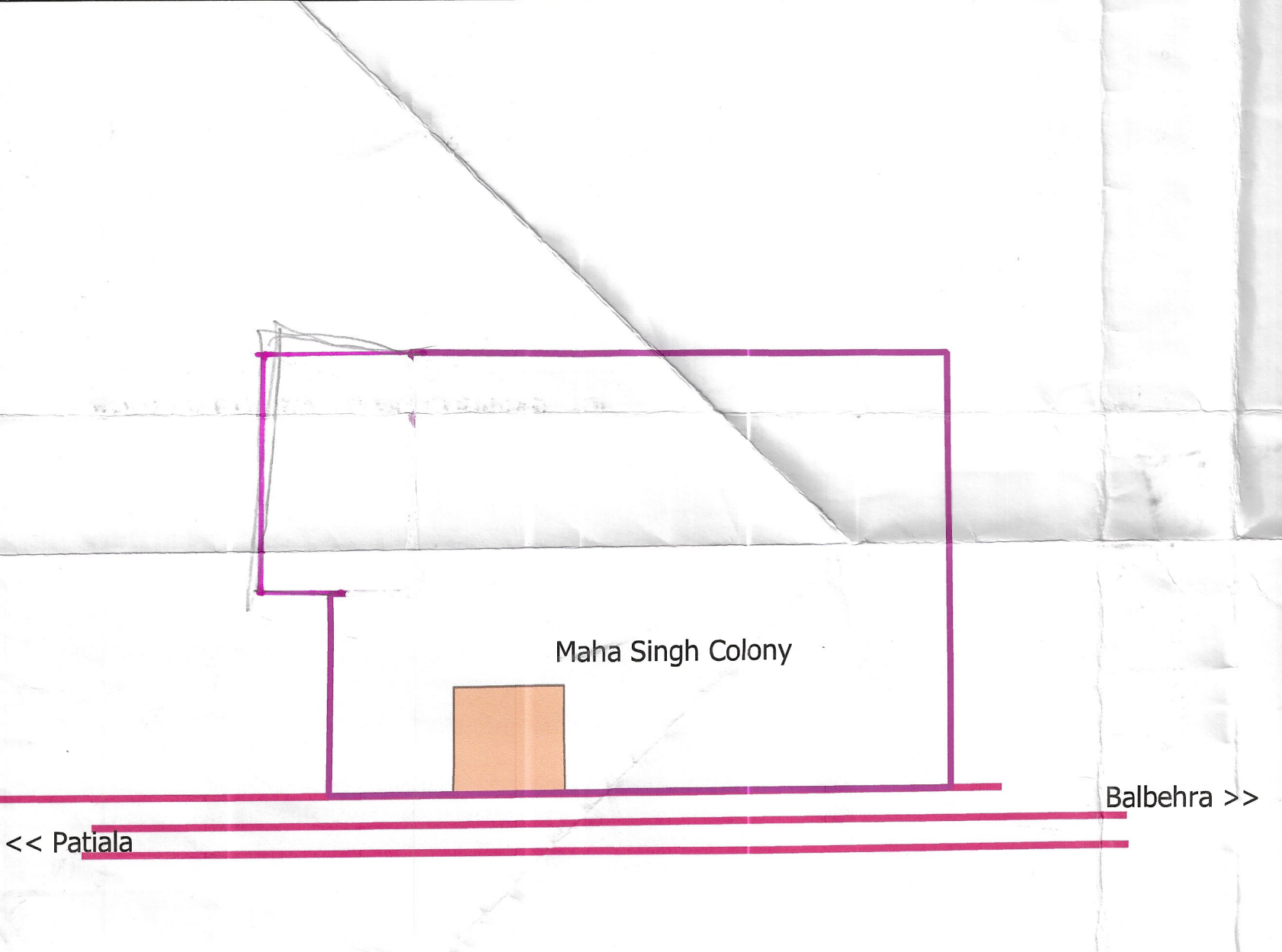

This layout plan of unauthorised colony is approved and notified by the Government vide notification no. 04/42/2023 - 2C1 dated 6th October, 2023. The same be scanned for uploading on the web portal.

PE *[Signature]* Consultant/PE
 ATP *[Signature]* ATP

LAYOUT PLAN OF DRONE BASED SURVEY OF MAHA SINGH COLONY (MC Cheeka)

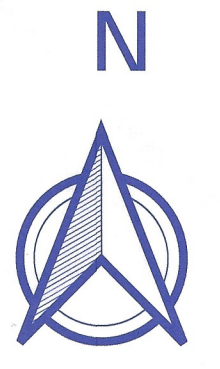

Legend

- Colony_Boundary
- Drainage
- Public_Utility
 - Electric Pole
 - Transformer
 - HT_Line
 - Internal_Road_Centre_Line
 - Major_Road_Line
 - Murabba Line
 - Khasra_Boundary
 - Green Belt
 - Area Not To Be Considered
- Internal_Road
 - 1.5 To 2.0 MTR Internal Road
 - 3.0 To 6.0 MTR Internal Road
 - 6.0 To 9.0 MTR Internal Road
- Plot_Boundary
 - Constructed
 - Vacant
 - Commercial
- Satellite Image

LENGEND OF INTERNAL ROAD IN COLONY

WIDTH OF INTERNAL ROAD	LENGTH
UP TO 1.5 MTR	0
1.5 TO 2.0 MTR	0
2.0 TO 2.5 MTR	0
2.5 TO 3.0 MTR	0
3.0 TO 6.0 MTR	0
6.0 TO 9.0 MTR	414
ABOVE 9 MTR	0

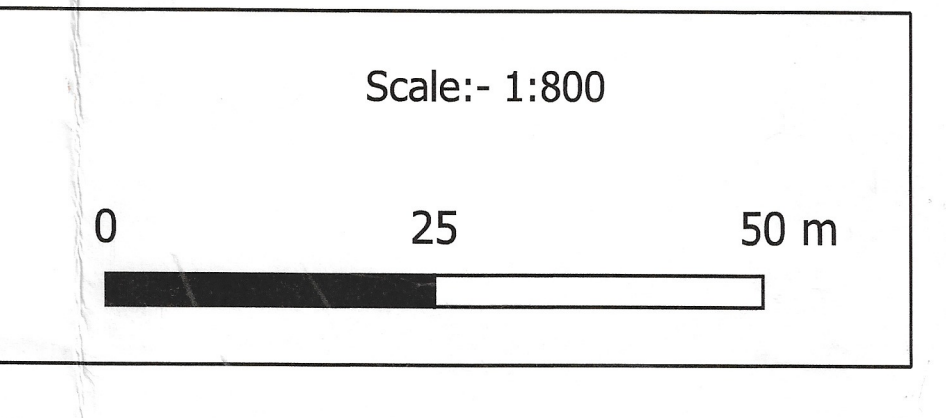

जिला नगर आयुक्त केशल।
 District Town Planner Kaithal
 Secretary Municipal Committee, Cheeka
 Municipal Engineer Cheeka (Kaithal)
 Junior Engineer Municipal Committee CHEEKA (Kaithal)