

DISTRICT JHAJJAR

LAYOUT PLAN OF THE Pamala Extension Near Drain PART 1 (UC ID-13061) IN REVENUE ESTATE OF VILLAGE

PARNALA, TEHSIL- BAHADURGARH, DISTRICT- JHAJJAR

COMPRISING KHASRA NO.-

31/18min,9min,13min,14min,15min,16min,25min
32/19min,20min,21min,22min,23min

KEY PLAN

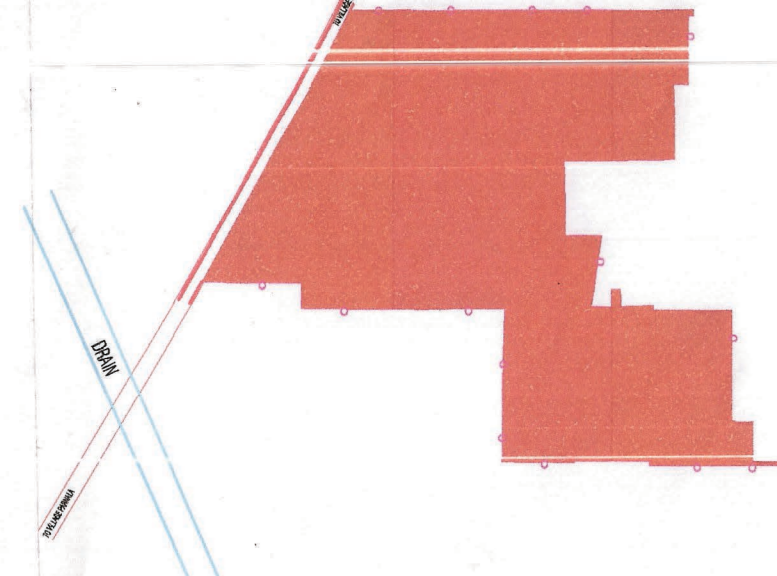

DETAILS OF UNAUTHORIZED COLONY

Sr. No.	Parameter Name	Description
1	Colony name	Pamala Extension Near Drain PART 1 (UC ID-13061)
2	Area	5.54 ACRES
3	Location of the colony	Across drain, On Nizampur Rd
4	Within MC	Yes
5	Outside MC	No
4	Type of Colony and use (in %)	Residential 9.02% Industrial Area 23.6%
5	Controlled Area	BAHADURGARH
6	Urban Area	BAHADURGARH
7	Year of establishment	2006
8	Layout Plan Scale	1:1000
9	Total Plots	---
10	Constructed Plots-Residential-Industrial	130+82 = 212
11	Number of vacant plots	---
12	Number of families residing in the colony	130
13	Does the colony have street light?	No
14	Does the colony have water supply through pipelines?	Yes
15	Does the colony have underground sewerage facility?	No
16	If connected to any external Sewage treatment plant? (Y/N)	No
17	Does the colony have Park or Open space?	No
17	Road type on Colony (kacha/pucca)	Maximum Road
18	Different roads (in meters)	Road Width Length (in mtrs)
19	Pucca Road	0.00 M 0 M
20	Kachcha Road	10 M 1019 M
19	Minimum Road width	Minimum Road
20	Different roads (in meters)	Road Width Length (in mtrs)
21	Pucca Road	0.0 M 0 M
22	Kachcha Road	3.0M 32 M
21	Electricity provided to households through which sub station	Bahadurgarh
22	Does the colony have community site	No
23	Area of the community site(in acres)	---
24	Is the RWA registered	No
25	Additional information, if any	---

SCALE:- 1:1000

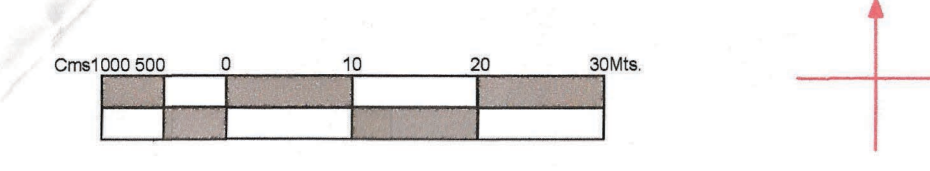

DRONE SURVEY AND LAYOUT PLAN PREPARED BY:
PD CONSULTING ENGINEERS PVT.LTD



hello@pdcegroup.com www.pdcegroup.com
Head Office: Behind MCD School,
Mehrauli-Gurgaon Rd, Ghilomi, Delhi - 30

Drawn By: Md Iqbal Shah | Date: 10/1 | No. No. 02
Checked: Faisal | Date: 25/02/2022

DRG. NO. DTP/JH/ 60/2022 | DATED 25/02/2022

LAYOUT PLAN CHECKED AND VERIFIED AT SITE BY:-

PATWARI:- (Vinayak)
JUNIOR ENGG:- (Takdir Singh)
SENIOR DRAFTSMAN :- (Kashi Ram)
ASSISTANT TOWN PLANNER :- (Satish Kumar)
DISTRICT TOWN PLANNER :- (Mohan Singh)
SENIOR TOWN PLANNER :- (Dilbagh Singh)

OFFICE OF DISTRICT TOWN PLANNER, JHAJJAR
TOWN & COUNTRY PLANNING DEPTT., HARYANA



This layout plan of unauthorized colony is approved and notified by the Government vide notification no. 09/121/2023 - 4CH dated 15th December, 2023. The same be scanned for uploading on the web portal.

PE Consultant/PE ATP

LEGEND

ManHole/ Chamber	
TF/Electric/Mobile tower	
Street Light/Solar pole	
Revenue Boundary	
City Road	
Murraba Line	
Khasra Line	
Colony Boundary	
HT Line	
Parcel Number	
Water Supply Line	
Vacant Plot (Not to be Regularised) (Area in Acre)	
Public & Semipublic Area (Area in Acre)	
Commercial Area	
Residential	
Vacant Land	
Drain/Culvert / Bridge	
Pucca Road(metallic)	
Pucca Road	
Industrial Area	
Temple/Mosque/Church/Flag Post	
Statue/School/Airport/Hospital/Well	

FINAL AREA TO BE CONSIDERED FOR NOTIFICATION AS APPROVED BY DLSC	
Total Area Of Colony As Per DTP	17.84 Acres
Zone As Per FDP 2041	R ZONE
Area falls in green belt, road widening, commercial area / industrial / religious	12.30 Acres
Total Area Of Colony to be considered for regularization after detecting commercial area / industrial / religious	5.54 Acres

Handwritten signatures and stamps of officials, including the District Town Planner and the District Commissioner, Jhajjar.