

DISTRICT JIND

LAYOUT PLAN OF UNAUTHORISED COLONY
NEAR SAFIDON RAILWAY STATION
IN THE REVENUE ESTATE OF SINGHPURA
TEH. SAFIDON AND DIST. JIND

KHASRA NO



KEY PLAN



DETAILS OF UNAUTHORIZED COLONY

1	Colony Name	Safidon, A, B, C, D, E, F, G, H, I, J, K, L, M, N, O, P, Q, R, S, T, U, V, W, X, Y, Z
2	Area	10.34 Acres
3	Location of the colony	Near Safidon Railway Station
4	Municipal Limits Boundary (MC STATUS): (A) Within MC (B) Outside MC (C) Partial MC	Yes No No
5	Type of Colony and use (in %)	Residential 8%, Area(Acres) 0.82, Area(Sq/M) 3321.80 Vacant + Open 66%, 6.83, 27625.28 Road 20%, 2.03, 8232.50 Commercial 6%, 0.66, 2627.60 Industrial 0%, 0.00, 0.00 Bustop 14%, 1.48, 5979.40
6	Name of Revenue Estate	Safidon
7	District Name	Jind
8	Name of Controlled Area	Safidon
9	Urban Area	Safidon
10	Year of establishment	2011
11	Total No. of PLOTS	43
12	No. of Constructed PLOTS	10-24-40-34
13	Number of vacant plots	9
14	Number of PLOTS existing in this colony	40
15	Is the colony have street light	No
16	Is the colony have Electric Line	Yes
17	Does the colony have fire line	No
18	Does the colony have water supply through taplines?	No
19	Does the colony have underground sewerage facility?	Yes
20	Does the colony have Public Open space	No
21	Road type on Colony (Kuccha/Pucca)	Kuccha & Pucca
22	Length (In meter)	200.45 X 4.34
23	Minor Road Width	3.00 to 3.50
24	Area of the colony (single acre)	3.41
25	Is the PWA registered	No
26	Additional Information, if any	No
27	Name of Electric Substation	ESBWN

DRG. NO. D.I.P. (J) DT.

LAYOUT PLAN CHECKED AND VERIFIED AT SITE BY:

PATWARI: *[Signature]*
JUNIOR ENGINEER: *[Signature]*
JUNIOR DRAFTSMAN: *[Signature]*
DISTRICT TOWN PLANNER: *[Signature]*
SENIOR TOWN PLANNER: *[Signature]*

OFFICE OF DISTRICT TOWN PLANNER, JIND
TOWN & COUNTRY PLANNING DEPTT, HARYANA

FINAL AREA TO BE CONSIDERED FOR NOTIFICATION	
Area of colony surveyed (including khasra nos.)	19/1/2 min, 20/1/5 min, 6/2/2 min, 6/1/1/6/1/2 min, 7 min, 8 min, 9 min, 10 min, 11/2 min, 12/13/1, 13/2/14/1, 14/2/15/1/2/1, 15/1/2/3 min, 15/1/2/2 min, 07/49/7 min, 65 min (10.34 Acres)
Area not to be considered as per clause 5	19/1/2 min, 20/1/5 min, 6/2/2 min, 6/1/1/6/1/2 min, 7 min, 8 min, 9 min, 10 min, 11/2 min, 12/13/1, 13/2/14/1, 14/2/15/1/2/1, 15/1/2/3 min, 15/1/2/2 min, 07/49/7 min, 65 min (10.34 Acres)
Area of the colony falling under greenbelt/road/buffer zone/vacant land/industrial etc/commercial. (including khasra nos.)	15/1/2/3 min, 15/1/2/2 min, 20/1/1/2 min, 20/1/5 min, 6/2/2 min, 6/2/2 min, 7 min, 8 min, 9 min, 10 min, 11/2 min, 12/13/1, 13/2/14/1, 14/2/15/1/2/1, 15/1/2/3 min, 15/1/2/2 min, (2.85 Acres)
Area of colony falling outside MC with khasra nos.	Nil
Area of colony to be considered for notification	20/1/6/2/1 min, 6/2/2 min, 7 min, 8 min, 9 min, 10 min, 11/2 min, 12/13/1, 13/2/14/1, 14/2/15/1/2/1, 15/1/2/3 min, 15/1/2/2 min (2.85 Acres)

This layout plan of unauthorised colony is approved and notified by the Government vide notification no. 04422023 - 2C1 dated 6th October, 2023. The same be scanned for uploading on the web portal.
[Signatures]
Consultant/PE
ATP

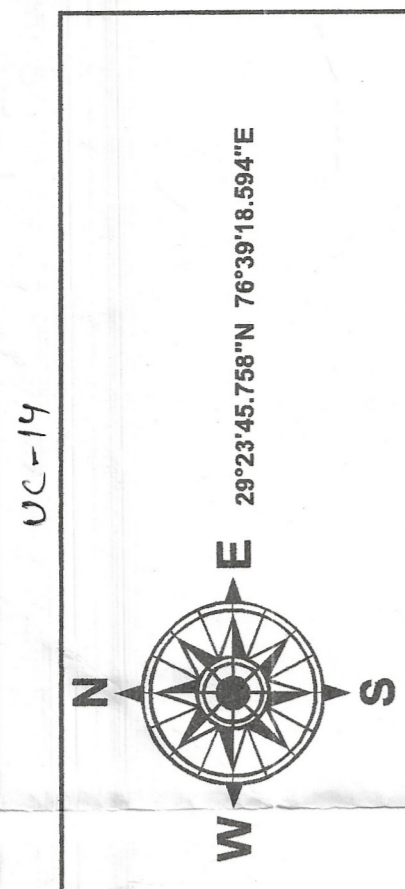

LEGEND

- Airport
- Electric Pole
- Hospital
- Man Hole
- Mobile Tower
- Mosque
- School/College
- Solar Pole
- Street Light
- Temple
- Transformer
- HT Line
- LT Line
- Kuccha Road
- Pucca Road
- Major Road Line
- Drainage
- Sewerage Storm water
- Kuccha Road Polygon
- Pucca Road Polygon
- Residential
- Commercial
- Industrial
- Plot Boundary
- Vacant Land
- Park
- Colony Boundary
- Khasra Boundary
- Revenue Estate Boundary
- Musli Boundary
- District Boundary
- APPROACH ROAD

NOTE:-
* ALL DIMENSIONS ARE IN METERS AND AREA IN SQUARE METERS.
* AREA OF RESIDENTIAL BUILDINGS IS INDICATED THROUGH PINK COLOUR.
* AREA OF PLOT BOUNDARY IS INDICATED THROUGH PURPLE COLOUR.

SCALE: 1 CM = 10 M

DRONE SURVEY AND LAYOUT PLAN PREPARED BY:-

CHECKED BY: _____ SURVEYOR: _____ SCALE: _____
DRAWN BY: _____
DRAWING NO.: _____ SHEET NO.: _____ REV. NO.: _____

To Safidon Town

Area under 30m wide along the Railway Corridor restricted green belt

To Singhpura Village

Area Under-60 m wide restricted green belt along Jind District Bussy No. 3.