

UKLANA HISAR

LAYOUT PLAN OF MODAL TOWN COLONY BHUDHAKHERA-(13457) IN KHASRA NO -

12// 13,14,15,16,17,18,19min, 22,23,24,25

REVENUE ESTATE BHUDHAKHERA, SUB-TEHSIL UKLANA & DISTRICT HISAR

FORMAT FOR CAPTURING INFORMATION REGARDING UNAUTHORISED COLONY

Sr. No.	Parameter Name	Description										
1	Colony name	MODAL TOWN COLONY BHUDHAKHERA COLONY-(13457)										
2	Area	9.80 acres										
3	Location of the colony	Bhuna-Narwana Road opposite marval hospital										
	(i) Within MC	Yes										
	(ii) Outside MC	No										
4	Type of Colony and use (in %)	<table border="1"> <tr><td>Residential</td><td>11.19%</td></tr> <tr><td>Industrial (not to be regularized)</td><td>0%</td></tr> <tr><td>Vacant</td><td>75.06%</td></tr> <tr><td>Commercial (not to be regularized)</td><td>0%</td></tr> <tr><td>Road</td><td>13.75%</td></tr> </table>	Residential	11.19%	Industrial (not to be regularized)	0%	Vacant	75.06%	Commercial (not to be regularized)	0%	Road	13.75%
Residential	11.19%											
Industrial (not to be regularized)	0%											
Vacant	75.06%											
Commercial (not to be regularized)	0%											
Road	13.75%											
5	Controlled Area	UKLANA Hisar										
6	Urban Area	UKLANA										
7	Year of establishment	2013										
8	Layout Plan (at 1 cm : 10m)	Attached										
		(Note: Separate guidelines For Layout Attached For Reference)										
9	Total Plots	42										
10	Constructed Plots	37										
11	Number of vacant plots	5										
12	Number of families residing in the colony	37										
13	Does the colony have street light?	Yes										
14	Does the colony have water supply through pipelines?	No										
15	Does the colony have underground sewerage facility?	No										
16	If connected to any external Sewage treatment plant? (Y/N)	No										
17	Does the colony have Park or Open space	NO										
18	Road type on Colony (kacha/pucca)	W.B.M Road										
19	Width of different roads (in meters)	Road Width Length										
20	Minimum Road width	4.8m 2114m										
21	Maximum Road width	7.54m										
22	Electricity provided to households through which sub station	UKLANA										
23	Does the colony have community site (In Acres)	NO										
24	Is the RWA registered	No										
25	Drainage	NO										
26	Revenue Rasta	NO										
	Additional information, if any											

Surveyed By: (PAT) (FI) (JE)

Drawing prepared and finalised By: (AD) (JD/SD) (PA) (ATP) (DTP)

This layout plan of unauthorised colony is approved and notified by the Government vide notification no. 04/42/2023 - 2CI dated 25th July, 2023. The same be scanned for uploading on the web portal.

Consultant/PE ATP

MC BOUNDARY



MC BOUNDARY



ALL THE DIMENSION AND AREA IN METER ONLY

LEGEND

ManHole/ Chamber	
TF/Electric/Mobile tower	
Street Light/Solar pole	
Revenue Estate Boundary	
City Road	
Killa Boundary	
Khasra Boundary	
Outer Boundary of Colony	
HT Line	
Sewerage Line	
Water Supply Line	
Vacant Plot (Not to be Regularised)	
Industrial Area	
Commercial Area	
Built Up Area/Residential	
Vacant Land	
Drainage	
Internal Kuccha Road	
Internal Pucca Road	
Divider Road	
Temple/Mosque/Church/Flag Post	
Statue/School/Airport/Hospital/Well	
Tin Shed	

KEY PLAN

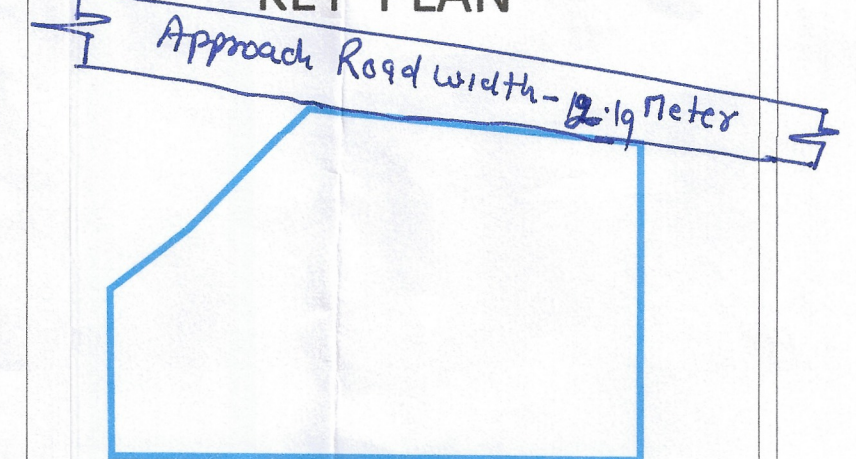

PROPOSED COLONY BOUNDARY

01	Total Area Of Colony	9.80 Acres/37959.54 sq. m
02	Built Up Area	1.05 Acres/4249.20 sq. m
03	Vacant plot / vacant land	7.04 Acres/28489.89 sq. m
04	Road Area	1.29 Acres/5220.44sq. m
Layout Plan To Be Prepared At Scale 1:1000		
Drone Survey Satellite Imagery In The Back ground.		
Plots Area Marked In Sq Meters In The Plots.		

AREADDETAILS:-

REMAINING AREA OF THE COLONY TO BE CONSIDERED = 9.50 ACRES (12// 13,14,15,16,17,18,19min, 22,23,24,25)

Note:

Revised considerable area in the Original Layout as per the discussion held at DULB, Chandigarh on 18.01.2023 and as per the directions received vide memo DULB/TP/2023/339-449 dated 13.01.2023 & e-mail dated 03.02.2023

Municipal Engineer, Uklana
Secretary, Municipal Committee, Uklana
Municipal Engineer, Uklana

18/3/23
Naib Tensildar Uklana
Municipal Committee, Uklana