

**M.C. GHARAUNDA  
TOWER COLONY EXTN.**

LAYOUT PLAN OF THE 12670-TOWER COLONY  
EXTN. IN KHASRA NO -174/11min, 12min,  
17min,18min, 19min, 20min,

REVENUE GHARAUNDA, TEHSIL GHARAUNDA

**FORMAT FOR CAPTURING INFORMATION  
REGARDING UNAUTHORISED COLONY**

Sr. No.	Parameter Name	Description
1	Colony name	12670 TOWER COLONY EXTN.
2	Area	3.72 Acres
3	Location of the colony	NEAR TOWER COLONY GHARAUNDA
	(i) Within MC	Yes
	(ii) Outside MC	No
4	Type of Colony and use (in %)	Residential 22.85% Public + Vacant 0%+60.25% Commercial + Industrial + Road 1.22%+0.0%+14.78%
5	Controlled Area	GHARAUNDA
6	Urban Area	GHARAUNDA
7	Year of establishment	2009
8	Layout Plan (at 1 cm : 10m)	To be Attached
9	Total Plots	104
10	Constructed Plots ( Residential + Commercial + Public )	26+ + 1+ 0 =27
11	Number of vacant plots	77
12	Number of families residing in the colony	26
13	Does the colony have street light?	No
14	Does the colony have water supply through pipelines?	No
15	Does the colony have underground sewerage facility?	No
16	If connected to any external Sewerage treatment plant? (Y/N)	No
17	Does the colony have Park or Open space	No
18	Road type on Colony (kacha/pucca)	Kuccha / pucca
19	Width of different roads (in meters)	Road Width Length (in mtrs) 3.8 M to 5.3 M 453.03 M
20	Minimum Road width	3.8 M
21	Electricity provided to households through which sub station	GHARAUNDA
22	Does the colony have community site	No
23	Area of the community site (in acres)	000 000 000
24	Is the RWA registered	No
25	Additional Information, if any	

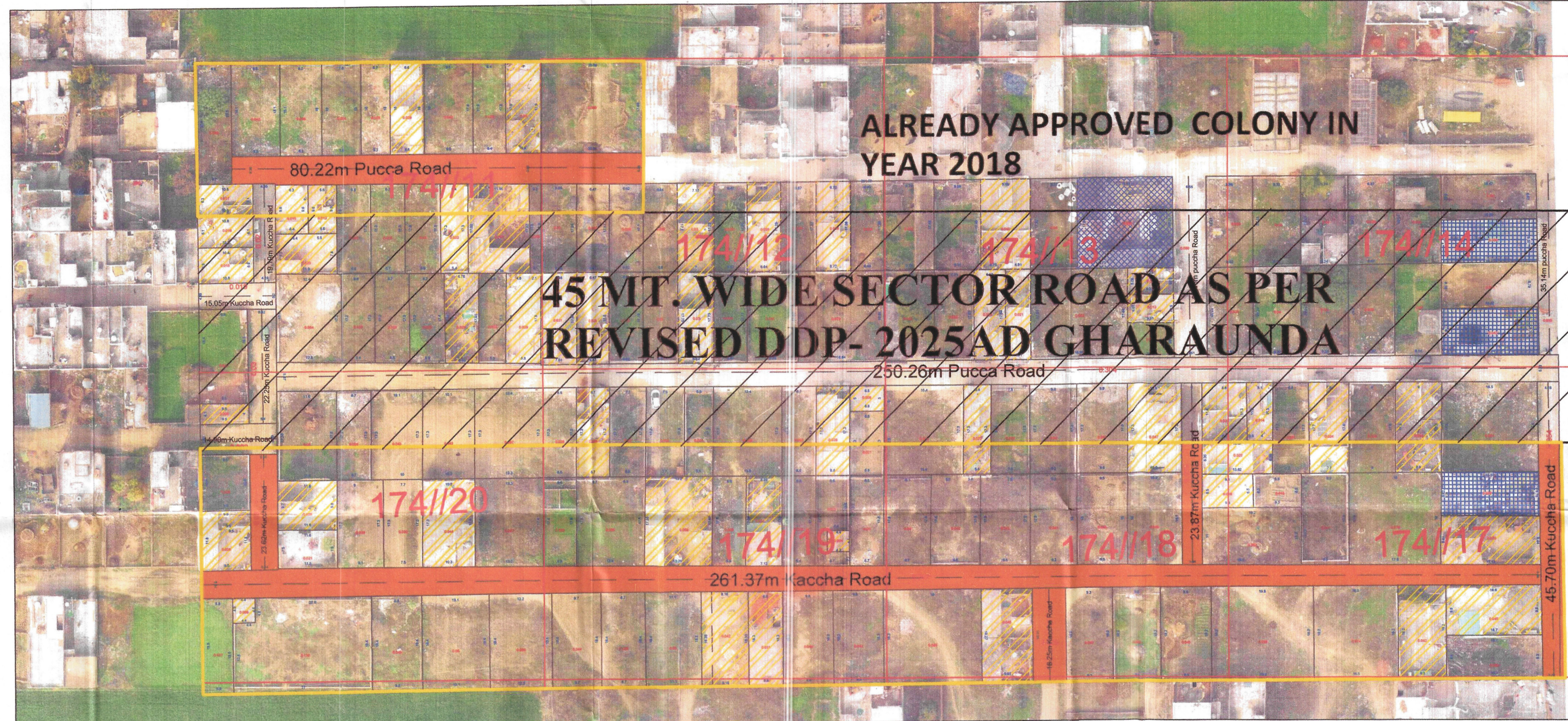

स्वीकृत  
सर्वी में घोषित खसरा नम्बरान की मलकीयत मुताबिक आबन्दी टोल  
की मलकीयत (आबन्दी टोल में आबन्दी टोल, पुनः मुद्रांकन गलतान द्वारे  
व्यक्त की मुद्रांकन द्वारे, समस्त की मुद्रांकन, नगरपालिका की मुद्रांकन  
मलकीयत नहीं है रिपोर्ट द्वारे रखा है  
21/11/23  
नहमीलदार प्रोपर्टी  
21/11/23

This layout plan of unauthorised colony is approved and notified by the Government vide notification no. 09/45/2024 - 4C - II dated 6<sup>th</sup> March, 2024. The same be scanned for uploading on the web portal.

PE Consultant/PE ATP

District Municipal Commissioner, District Town Planner KARNAL  
Secretary MC Gharaunda  
Municipal Committee Gharaunda (Karnal)  
Junior Engineer MC Gharaunda

**NOTE: - SHOPS ,INDUSTRIAL UNIT ,COMMERCIAL BUILDINGS ,SCHOOL ,COLLEGE ,RELIGIOUS PLACES, SHALL NOT BE CONSIDERED THE PART OF THE COLONY AS PER GOVT. NOTIFICATION DATED 03.03.2023**

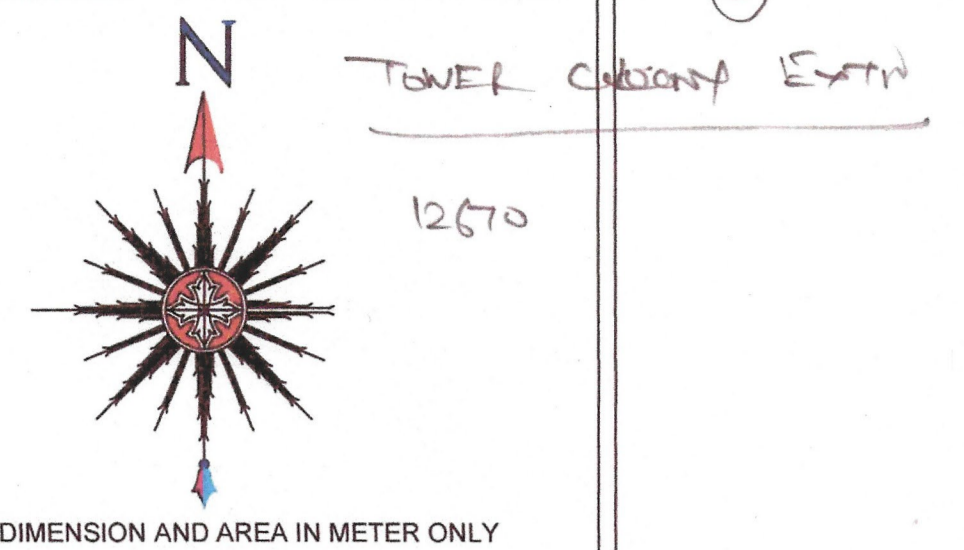

**LEGEND**

ManHole/ Chamber	
TF/Electric/Mobile tower	
Street Light/Solar pole	
Revenue Boundary	
City Road	
Murraba Line	
Khasra Line	
Colony Boundary	
HT Line	
Sewerage Line	
Water Supply Line	
Vacant Plot	
Public & Semipublic Area	
Commercial Area	
Built Up Area/Residential	
Vacant Land	
Drain/Culvert / Bridge	
ROAD UP TO 0-3MTR	
ROAD UP TO 3 - 6 MTR	
ROAD UP TO 6 - 9 MTR	
ROAD MORE THEN 9MTR	
Divider Road	
Temple/Mosque/Church/Flag Post	
Statue/School/Airport/Hospital/Well	
Tin Shed	
Parcel Num	00
Industrial Area	

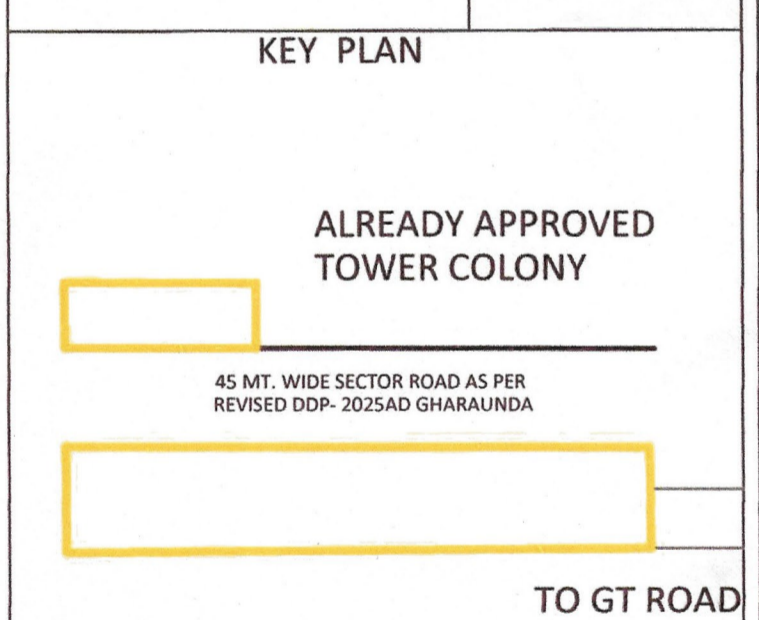

DRAWING NO:- KNL/KARNAL - 13/2022

Surveyed by: IG DRONES

Drawing checked by:  
(JE)  
(PATWARI)  
(AD)  
(JD)  
(ATP)  
(DTP)  
(Senior Town Planner)  
(Panchkula Circle)

Client :		
Sl.No.	Date	Description of revision
Project : Drone survey unauthorized colony Haryana		
SURVEY CONSULTANT :-  IG Drones A unit of Inventgrid India Pvt. Ltd. 2n Floor, E-53-54, Block E, Sector 3, Noida, Delhi NCR 201301		
Checked By:	Surveyor :	Scale :-
Drawn By:	Sheet No:	
Drawing No:	Sheet No: 1 OF 1	Rev. No: 00