

**M.C. GHARAUNDA  
BHOLA COLONY EXTN.**

LAYOUT PLAN OF THE 12739 - BHOLA COLONY  
EXTENSION IN KHASRA NO - 124/13, 14MIN, 16  
MIN, 17, 18MIN.

REVENUE ESTATE - GHARAUNDA, TEHSIL  
GHARAUNDA

Sr. No.	Parameter Name	Description
1	Colony name	12739 BHOLA COLONY EXTN.
2	Area	4.36 Acres
3	Location of the colony	Bhola Colony Ext.
	(i) Within MC	Yes
	(ii) Outside MC	No
4	Type of Colony and use (in %)	Residential 11.76% Public + Vacant 0%+69.29% Commercial + Industrial + Road 18.95%+18.95%
5	Controlled Area	NIL
6	Urban Area	GHARAUNDA
7	Year of establishment	2006
8	Layout Plan	Attached
9	Total Plots	58
10	Constructed Plots ( Residential + Commercial + Industrial + Public )	16 + 0 + 1 + 0 = 17
11	Number of vacant plots	41
12	Number of families residing in the colony	16
13	Does the colony have street light?	Yes
14	Does the colony have water supply through pipelines?	No
15	Does the colony have underground sewerage facility?	No
16	If connected to any external Sewage treatment plant? (Y/N)	No
17	Does the colony have Park or Open space	No
18	Road type on Colony (kacha/pucca)	Kuccha
19	Width of different roads (in meters)	Road Width Length (in mtrs) 3.05 M to 7.5M 705.44M
20	Minimum Road width	3.05M
21	Electricity provided to households through which sub station	GHARAUNDA SUB STN.
22	Does the colony have community site	No
23	Area of the community site(in acres)	000 000 000
24	Is the RWA registered	No
25	Additional information, if any	

DRAWING NO:KNL/KARNAL- 80/2022

Surveyed by: IG DRONES

Drawing checked by:

- (JE) VIKRANT
- (PATWARI) JOGINDER SINGH
- (AD) DHANI RAM RANGA
- (JD) RAMESH KUMAR
- (ATP) SANJAY SAINI
- (DTP) ASHOK GARG
- STP (PKL) RAM KUMAR

**NOTE: - SHOPS ,INDUSTRIAL UNIT ,COMMERCIAL BUILDINGS ,SCHOOL ,COLLEGE ,RELIGIOUS PLACES, SHALL NOT BE CONSIDERED THE PART OF THE COLONY AS PER GOVT. NOTIFICATION DATED 03.03.2023**

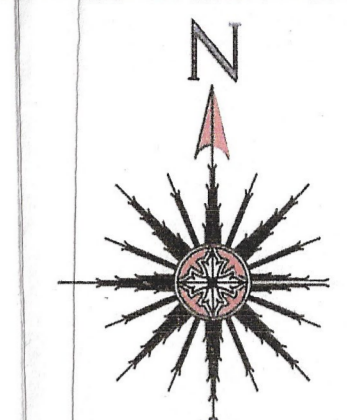

ALL THE DIMENSION IN METER AND AREAS IN ACRES

**LEGEND**

ManHole/ Chamber	
TF/Electric/Mobile tower	
Street Light/Solar pole	
Revenue Boundary	
City Road	
Murraba Line	
Khasra Line	
Colony Boundary	
HT Line	
Sewerage Line	
Water Supply Line	
Vacant Plot	
Public & Semipublic Area	
Commercial Area	
Built Up Area/Residential	
Vacant Land	
Drain/Culvert / Bridge	
ROAD UP TO 0-3MTR	
ROAD UP TO 3 - 6 MTR	
ROAD UP TO 6 - 9 MTR	
ROAD MORE THEN 9MTR	
Divider Road	
Temple/Mosque/Church/Flag Post	
Statue/School/Airport/Hospital/Well	
Tin Shed	
Parcel Num	00
Industrial Area	

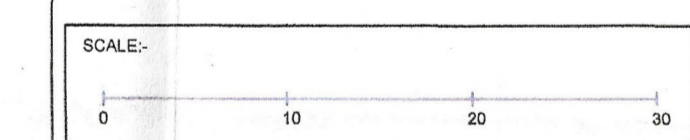
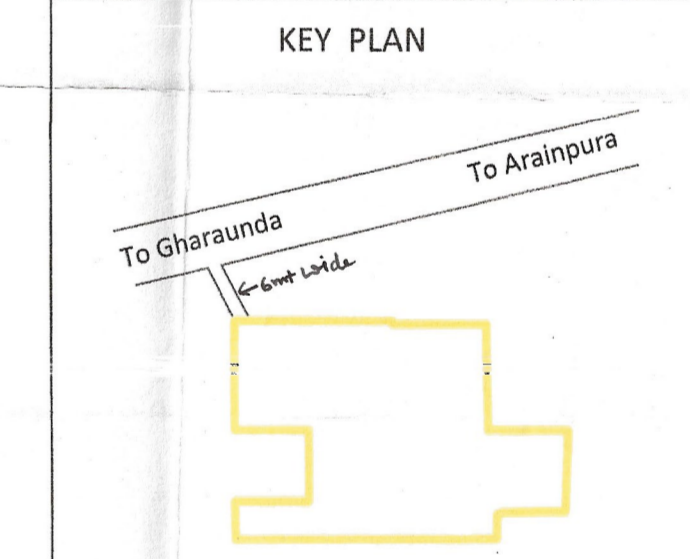

Sl.No.	Date	Description of revision	Prints Issued

Project: Drone survey unauthorized colony  
Haryana

**SURVEY CONSULTANT -**

IG Drones  
A unit of Invenigrd India Pvt. Ltd.  
2n Floor, E-53-54, Block E, Sector 3,  
Noida, Delhi NCR 201301

Checked:	Surveyor:	Scale: 1 CM = 3.05 Meter
Drawn By:	Sheet:	
Drawing No:	Slr. No. 1 OF 1	Rev. No. RO

श्रीमान् जी, नमस्ते। मैं आपका जवाब दे रहा हूँ। मैं आपकी जानकारी के अनुसार आपकी...  
 Prince Kumar  
Secretary  
MC Gharaura

Madan Mohan Garg  
Municipal Engineer  
MC Gharaura

Lovkesh Saini  
Junior Engineer  
MC Gharaura

District Town Planner  
KARNAL

Naib Tehsildar  
GHARAUNDA

District Municipal Commissioner,  
KARNAL

PE  
Consultant/PE  
ATP

This layout plan of unauthorised colony is approved and notified by the Government vide notification no. 04/42/2023 - 2CI dated 6<sup>th</sup> October, 2023. The same be scanned for uploading on the web portal.