

DISTRICT JIND

LAYOUT PLAN OF UNAUTHORIZED COLONY
NEAR HANUMAN MANDIR
IN THE REVENUE ESTATE OF UCHANA
TEH.UCHANA AND DIST. JIND

KHASRA NO
53//6min
54//1min,2min,3,8,9,10,12min,13min,19min,20min,21min

KEY PLAN

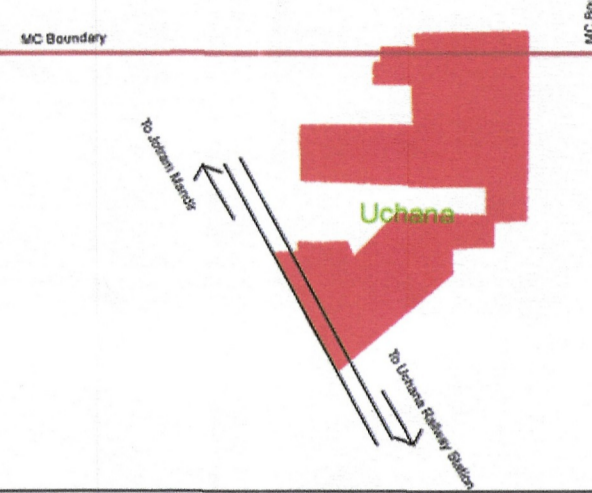

DETAILS OF UNAUTHORIZED COLONY

Sr. No.	Parameter Name	Description			
1	Colony name	Uchana_M_ALL_Uchana_UC10			
2	Area	8.71 Acres 35247.63 Sq/M			
3	Location of the colony	Hanuman Mandir			
4	Municipal Limits Boundary (MC STATUS):	(i) Within MC	Yes		
		(ii) Outside MC	No		
		(iii) Partial MC	No		
5	Type of Colony and use (in %)	Area (%)	Area(Acres)	Area(Sq/M)	
		Residential	31%	2.69	10888.40
		Vacant + Open	42%	3.68	14876.63
		Road	24%	2.06	8338.49
		Commercial	3%	0.28	1144.11
		Industrial	0%	0.00	0.00
6	Name of Revenue Estate	Uchana			
	District Name	Jind			
7	Name of Controlled Area	Uchana			
8	Urban Area	Uchana			
9	Year of establishment	2021			
10	Total No. of Plots	121			
11	No. of Constructed Plots(Residential+Commercial+Industrial)	71+4+0=75			
12	Number of vacant plots	46			
13	Number of families residing in the colony	71			
14	Does the colony have street light?	Yes			
15	Does the colony have Electric Line	Yes			
16	Does the colony have HT Line	No			
17	Does the colony have water supply through pipelines?	No			
18	Does the colony have underground sewerage facility?	No			
19	Does the colony have Park or Open space	No			
20	Road type on Colony (Kuccha/Pucca)	Kuccha & Pucca			
21	Different roads (in meters)	Road Width	Length (in mtrs)		
		Pucca Road	4.2M to 6.04M 468.36 M		
		Kaccha Road	1.8M to 14.64M 1124.58 M		
22	Minimum Road Width	3.6 M			
23	Area of the community site(in acres)	No			
24	Is the RWA registered	No			
25	Additional Information, if any	No			
26	Name of Electric Substation	DHBVN			

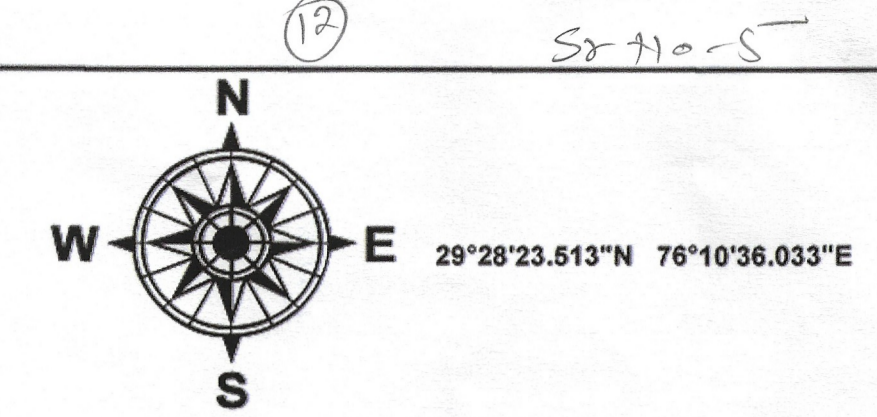

LEGEND

- Airport
- Electric Pole
- Hospital
- Man Hole
- Mobile Tower
- Mosque
- School/College
- Solar Pole
- Street Light
- Temple
- Transformer
- HT Line
- LT Line
- Kuccha Road
- Pucca Road
- Major Road Line
- Drainage
- Sewerage Storm water
- Kuccha Road Polygon
- Pucca Road Polygon
- Residential
- Commercial
- Industrial
- Plot Boundary
- Vacant Land
- Park
- Colony Boundary
- Khasra Boundary
- Revenue Estate Boundary
- Mustil Boundary
- District Boundary
- Final Colony Boundary

NOTE:-
 • ALL DIMENSIONS ARE IN METERS AND AREA IN SQUARE METERS.
 • AREA OF RESIDENTIAL BUILDINGS IS INDICATED THROUGH PINK COLOUR.
 • AREA OF PLOT BOUNDARY IS INDICATED THROUGH PURPLE COLOUR.
 • AREA OF BOUNDARY IS INDICATED THROUGH RED COLOUR

SCALE : 1 CM = 10 M

DRONE SURVEY AND LAYOUT PLAN PREPARED BY:-



CHECKED :	SURVEYOR :	SCALE :-
DRAWN BY :-		
DRAWING NO :- Uchana-UC-10	SHT. NO.	REV. NO.

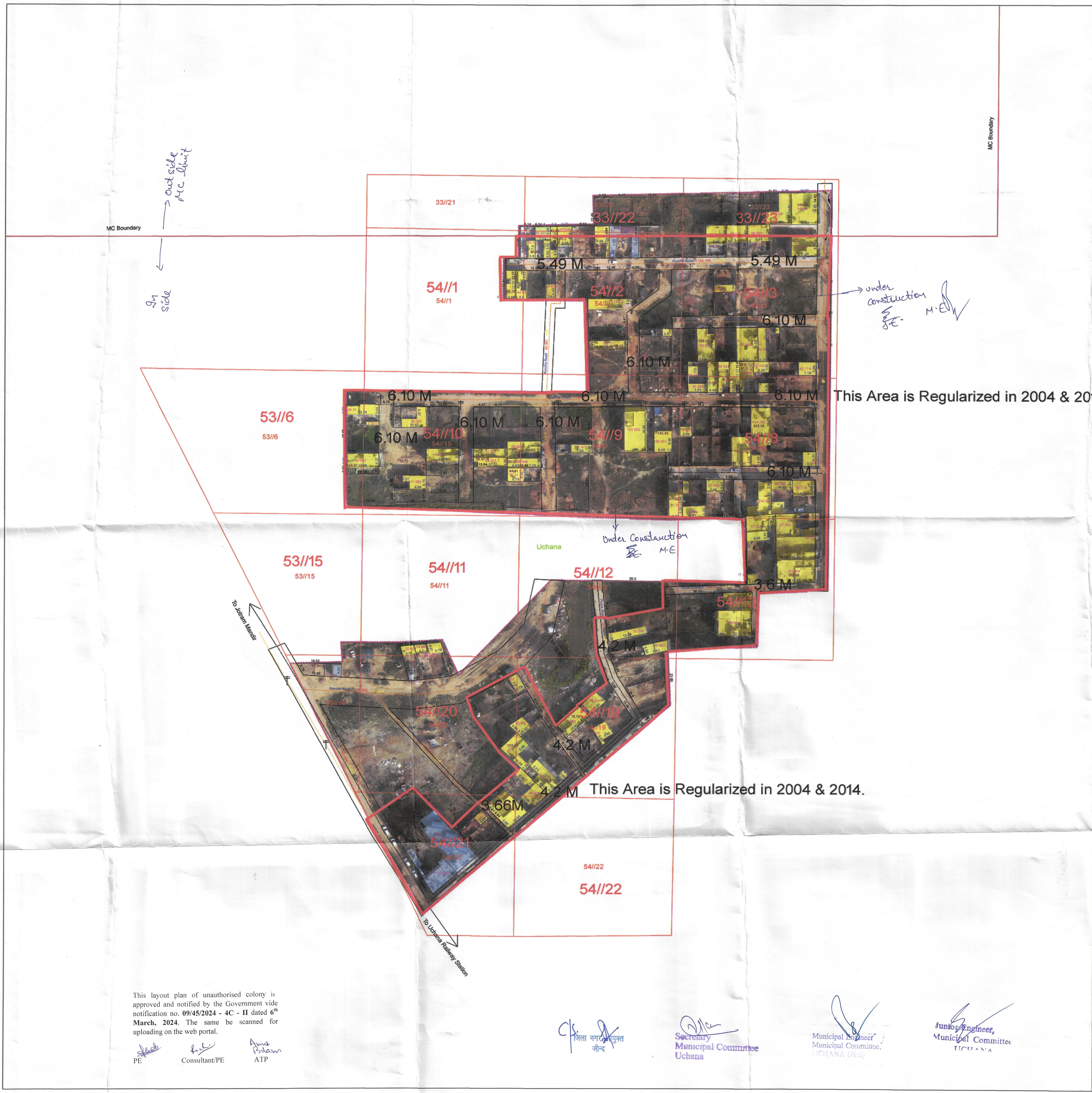

This Area is Regularized in 2004 & 2014

This Area is Regularized in 2004 & 2014.

This layout plan of unauthorised colony is approved and notified by the Government vide notification no. 09/45/2024 - 4C - II dated 6th March, 2024. The same be scanned for uploading on the web portal.

PE Consultant/PE ATP

Secretary Municipal Committee Uchana
 Municipal Engineer Municipal Committee UCHANA (Ujda)
 Junior Engineer, Municipal Committee UCHANA

DRG. NO D.T.P. (J) 1401/2022 DT. 25-04-2022

LAYOUT PLAN CHECKED AND VERIFIED AT SITE BY:

PATWARI :
 JUNIOR ENGINEER :
 JUNIOR DRAFTSMAN :
 DISTRICT TOWN PLANNER :
 SENIOR TOWN PLANNER (H)
 OFFICE OF DISTRICT TOWN PLANNER, JIND
 TOWN & COUNTRY PLANNING DEPTT, HARYANA